

GOVERNMENT CORNER RESTORATION FORM

FILED
JAN 11 1988
COUNTY SURVEYOR
DOUGLAS COUNTY, ORE

Township 22S Range 13W Sec. 13 County DOUGLAS

State OR Date 1/5/88 No. _____

Corner Designation

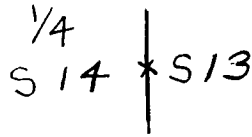

- Condition Report Only
- Not Found
- Renewed
- Unrecorded
- Surveyed In
- Referenced Out

Previous Renewals REN #18, 1982 BLM RESURVEY

Monument(s) Found: (Condition and Source)

3/4" BRASS CAP ON A 2/4" I.P. PROTRUDING
7 IN. ABOVE GROUND. PER 1982
BLM RESURVEY. 1" I.P. PER
REN #18 WAS NOT LOOKED FOR
IT LIES UNDER SC/I.P. ACCORDING
TO 1982 BLM LINE NOTES.

NO OTHER MONUMENTS PREVIOUS
TO REN #18 WERE FOUND.

U.S. DEPT. OF THE INTERIOR

T22S R13W

1/4

S14 | S13

1983

BUR. OF LAND MANAGEMENT

Accessories Found:

NAIL WITH ROUND HEAD AND A 2" SHINNER IN AC NOW COVERED
BY AN AC OVERLAY, NAIL LOCATED WITH METAL DETECTOR
(NOT UNCOVERED). BEARS N 7 1/2° E, 178.17 FT AGREES
WITH RECORD. PER REN #18.

COAST GUARD TELEPHONE POLE WITH PK NAIL ON WEST SIDE
4 FT ABOVE GROUND NOW POLE CUT DOWN AND REMAINDER
PROTRUDES 5 FT ABOVE GROUND. BEARS S 3 1/2° E, 189.57 FT
AGREES WITH RECORD PER REN #18.

STEEL POST WITH WHITE PADDLE BEARS S 49° E, 1.7 FT
(RECORD EAST, 2 FT) PER REN #18.

OSHD STATION "GUARD 1968" HAS A RECORD BEARING AND
DISTANCE OF N 57° 51' E, 23.73 CHAINS. STATION GUARD
IS OK, BEARING AND DISTANCE NOT CHECKED.

#264

600440

C.S. File No. 62/49-1

Monument Set (Procedure and Description)

Monument Detail

NONE

N/A

New Accessories

5" SPRUCE DOUBLE BLAZED AND SCRIBED "1/4 S14 CS BT"
BEARS N 55 1/2° W, 32.6 FT.

6" SPRUCE DOUBLE BLAZED AND SCRIBED "1/4 S13 CS BT"
BEARS S 10° E, 12.0 FT.

Sketch of Monument, Accessories, and General Area

Location & Comments

PERPETUATED AS POINT PROTECTED
BY HOLLINGSWORTH (M16-54) AND
ACCEPTED BY BLM (DEPENDENT
RESURVEY APPROVED 1-6-84)
FOR CORNER LOCATION.

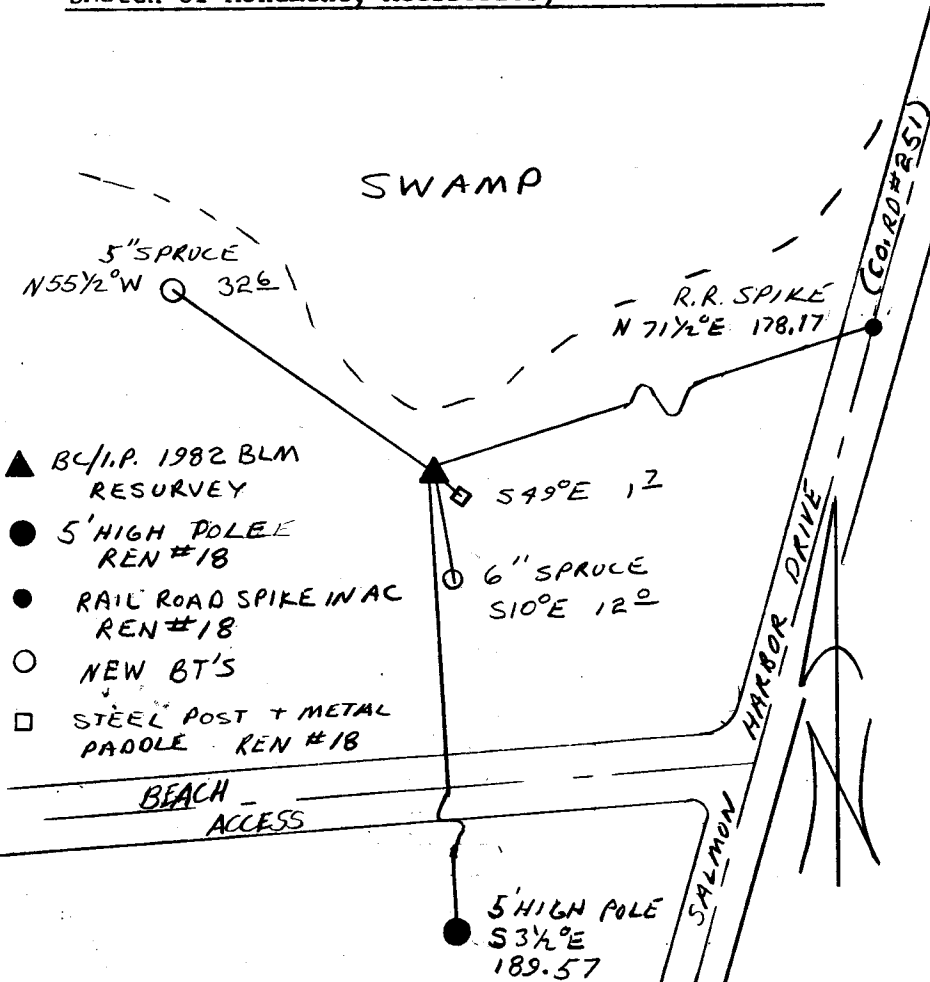

Comp. Declin. 18 1/2° F
Agency DCSO
Party Chief RANDALL W SMITH
Notekeeper Randall W Smith
Witnesses STEPHEN J. FLAUSE

Address

Surveyor's Seal

REGISTERED
PROFESSIONAL
LAND SURVEYOR

Larry E. Monrean

OREGON
JULY 13, 1979
LARRY E. MONREAN
#1830