

GOVERNMENT CORNER RESTORATION FORM

Township 27S Range 5W Sec. 49 County DOUGLAS  
State OR Date 8/24/87 No. \_\_\_\_\_

Corner Designation

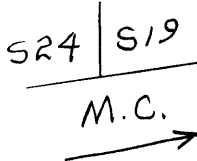

#106 #114 T27-5

Previous Renewals #109, #132 INT27S R6W

Monument(s) Found: (Condition and Source)

A DCSSO BL/1.P 2 1/2 FT BELOW  
SURFACE OF GROUND.

- Condition Report Only
- Not Found
- Renewed
- Unrecorded
- Surveyed In
- Referenced Out

MONUMENT DETAIL

COUNTY SURVEYORS OFFICE  
M. C.

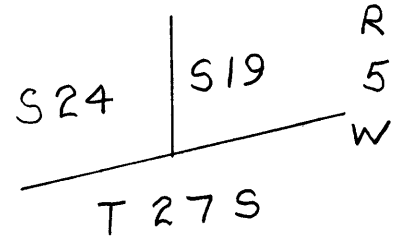

Accessories Found:

BT'S PER REN #109

15" DIA. BALM OF GILEAD NOW A 30" DIA. DOWN COTTON WOOD  
TREE WITH A ROTTED OUT BLAZE BEARS N50°W, 30.5 FT TO  
STUMP HOLE. (AGREES WELL WITH RECORD)

SOUTHWEST BT GONE

BT PER REN #132

25" DIA. BALM NOW 28" DIA. COTTON WOOD TREE WITH A FULLY  
HEALED DOUBLE BLAZE BEARS N43 1/2°W, 30.8 FT (RECORD  
N43 1/2°W, 31.5 FT).

#177-T27-6 X  
#166-T27-5 X

RENEWAL

Monument Set (Procedure and Description)

A 5/8" x 30" LONG I.R. WITH DCSO ALUMINUM CAP SET PLUB OVER DCSO BC/I.P.; I.R. PROTRUDES 3 IN. ABOVE GROUND MARKED DOUGLAS CO. SURVEYOR.

Monument Detail

N/A

New Accessories

10" LOCUST DOUBLE BLAZED AND SCRIBED "MCS24CS BT" BEARS N76 1/2° W, 15.0 FT.  
9" ASH DOUBLE BLAZED AND SCRIBED "MCS19CS BT" BEARS S33° E, 7.1 FT.  
6" MAPLE DOUBLE BLAZED AND SCRIBED "MCS19CS BT" BEARS N15° E, 59.9 FT.

Sketch of Monument, Accessories, and General Area

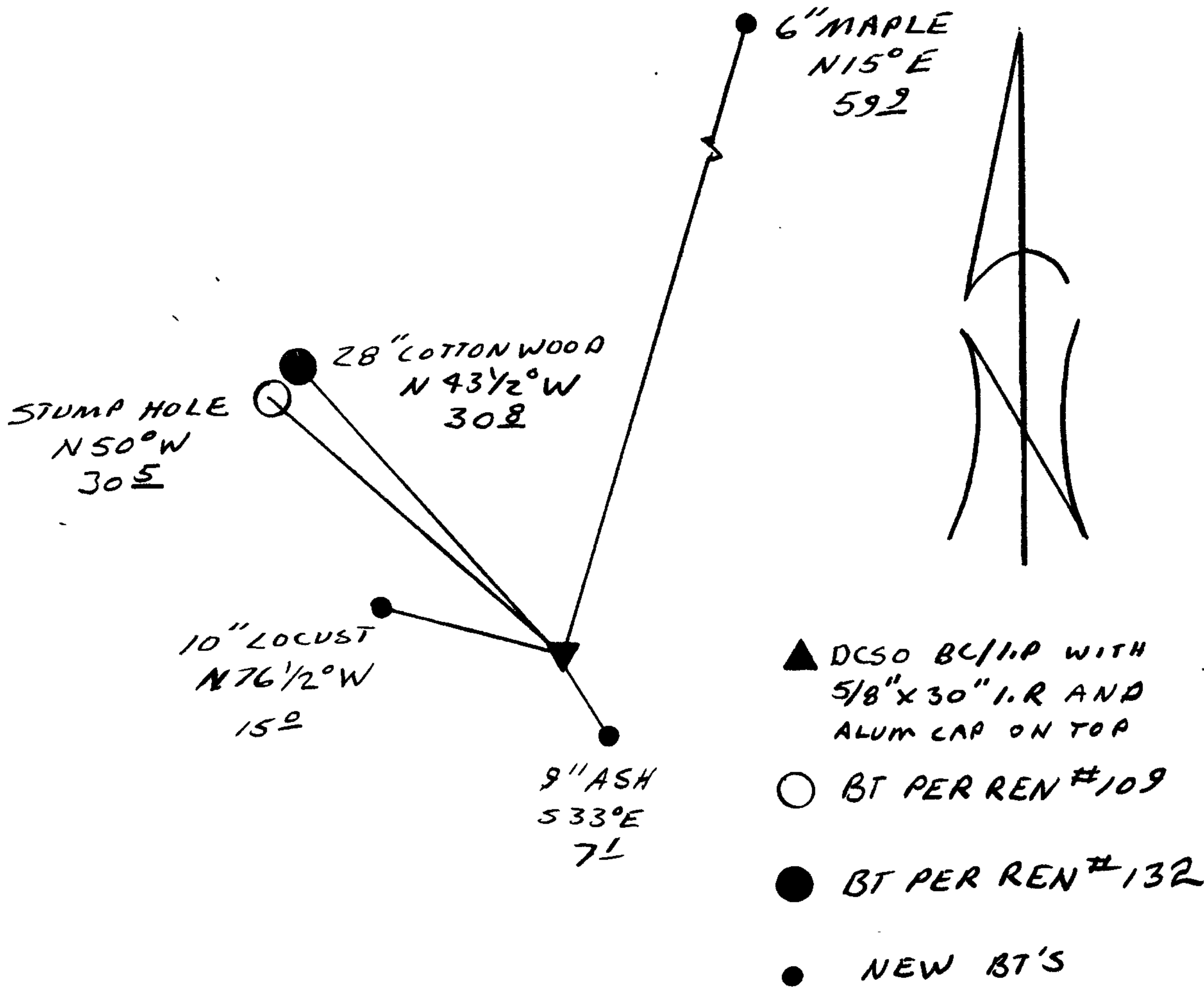

Location & Comments

NEAR SOUTH END OF ELK ISLAND IN ROSEBURG. APPROX. 50 FEET NORTH OF HIGH WATER BANK.

Comp. Declin. 18 1/2° E  
Agency DCSO  
Party Chief RANDALL W SMITH  
Notekeeper Randall W Smith  
Witnesses STEPHEN J FLAUSE

Address

Surveyor's Seal

REGISTERED PROFESSIONAL LAND SURVEYOR

Larry E. Monrean

OREGON  
JULY 13, 1979  
LARRY E. MONREAN  
#1830