

GOVERNMENT CORNER RESTORATION FORM

Township 22  
~~265~~ Range 12  
~~66~~ Sec. 17 County DOUGLAS  
State OREGON Date 9-22-86 No. \_\_\_\_\_

Corner Designation

S 7 | S 8  
S 18 | S 17

- Condition Report Only
- Not Found
- Renewed
- Unrecorded
- Surveyed In
- Referenced Out

MONUMENT DETAIL

Previous Renewals NONE

Monument(s) Found: (Condition and Source)

N/A

Accessories Found:

N/A

RENEWAL

Monument Set (Procedure and Description)

Monument Detail

MONUMENT SET IS A 2 3/8 INCH DIAMETER BRASS CAP MARKED AS AT RIGHT ON A 1 INCH DIAMETER (1 1/4 INCH O.D.) x 32 INCH LONG IRON PIPE PROTRUDING APPROXIMATELY 5 INCHES ABOVE GROUND.

DOUGLAS COUNTY SURVEYORS OFFICE

T22S

R12W

S7 S8

S18 S17

1986

New Accessories

A 21 INCH D.B.H. SPRUCE SCRIBED T22S R12W S8 CS BT ON A DOUBLE BLAZE, BEARS N13°E, 75 FEET.

A 16 INCH D.B.H. SPRUCE SCRIBED T22S R12W S7 CS BT ON A DOUBLE BLAZE, BEARS N11 1/2°W, 34.6 FEET.

AN 18 INCH D.B.H. SPRUCE SCRIBED T22S R12W S17 CS BT ON A DOUBLE BLAZE, BEARS S27°E, 21.9 FEET.

A 37 INCH D.B.H. SPRUCE SCRIBED T22S R12W S18 CS BT ON A DOUBLE BLAZE, BEARS S21 1/2°W, 35 FEET.

Sketch of Monument, Accessories, and General Area

Location & Comments

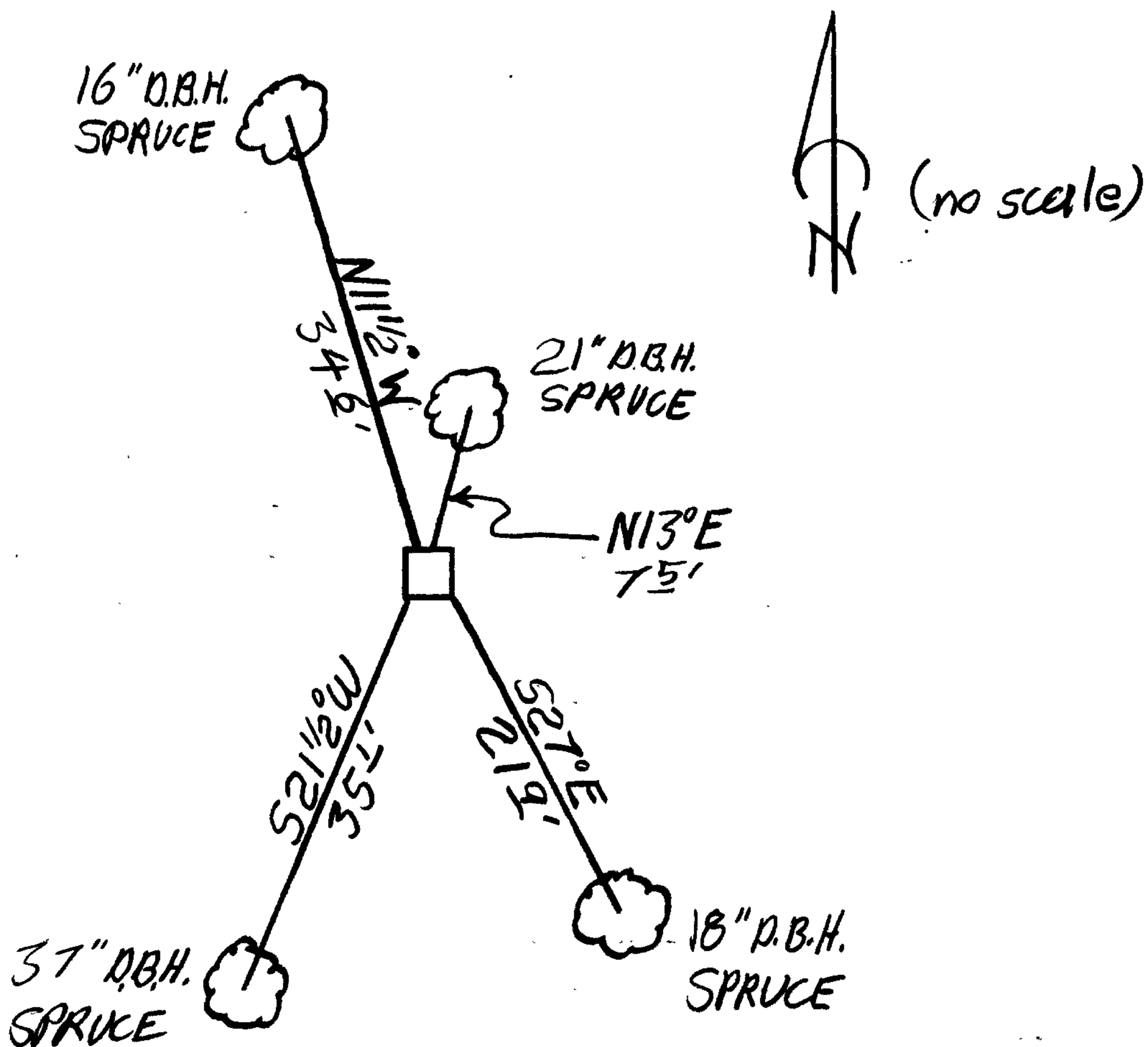

MONUMENT LIES ON A MODERATE SOUTHWEST SLOPE.

Comp. Declin. 18 1/2°E

Agency D.C.S.O.

Party Chief J.R. LUNDEEN

Notekeeper

Witnesses R.W. SMITH

L.E. MONREAN

Address Room 205 JUSTICE BLDG. ROSEBURG OR

Surveyor's Seal

REGISTERED PROFESSIONAL LAND SURVEYOR

Janet R. Lundeen

OREGON FEBRUARY 4, 1983 JANET R. LUNDEEN 2027

GOVERNMENT CORNER RESTORATION FORM

Township 22S Range 12W Sec. 17 County \_\_\_\_\_

State OR Date 6/4/86 No. \_\_\_\_\_

Corner Designation

7	8
18	17

- Condition Report Only
- Not Found
- Renewed
- Unrecorded
- Surveyed In
- Referenced Out

Previous Renewals NONE

MONUMENT DETAIL

Monument(s) Found: (Condition and Source)

NONE

Accessories Found:

NONE

