

RENEWAL

Monument Set (Procedure and Description)

Monument Detail

DOUGLAS COUNTY SURVEYORS OFFICE

T225

S¹/₁₆

S17 | S16

R12W

1986

MONUMENT SET IS A 2 3/8 INCH DIAMETER BRASS CAP, MARKED AS AT RIGHT, ON A 1 INCH DIAMETER (1 1/4 INCH O.D.) 32 INCH LONG GALVANIZED IRON PIPE PROTRUDING 1 FOOT ABOVE GROUND AND SURROUNDED BY A 2 FOOT DIAMETER MOUND OF STONE.

New Accessories

A 13 INCH D.B.H. SPRUCE SCRIBED S¹/₁₆ S16 CS BT ON A DOUBLE BLAZE, BEARS N0 1/2° E, 44 2 FEET.

AN 8 INCH D.B.H. SPRUCE SCRIBED S¹/₁₆ S16 CS BT ON A DOUBLE BLAZE, BEARS S08 1/2° E, 67 3 FEET

A 19 INCH D.B.H. ALDER BARK SCRIBED S¹/₁₆ S16 CS BT, BEARS N 79° E, 24 3 FEET.

A 22 INCH D.B.H. ALDER SCRIBED S¹/₁₆ S17 CS BT ON A DOUBLE BLAZE, BEARS S 12° W, 21 4 FEET.

Sketch of Monument, Accessories, and General Area

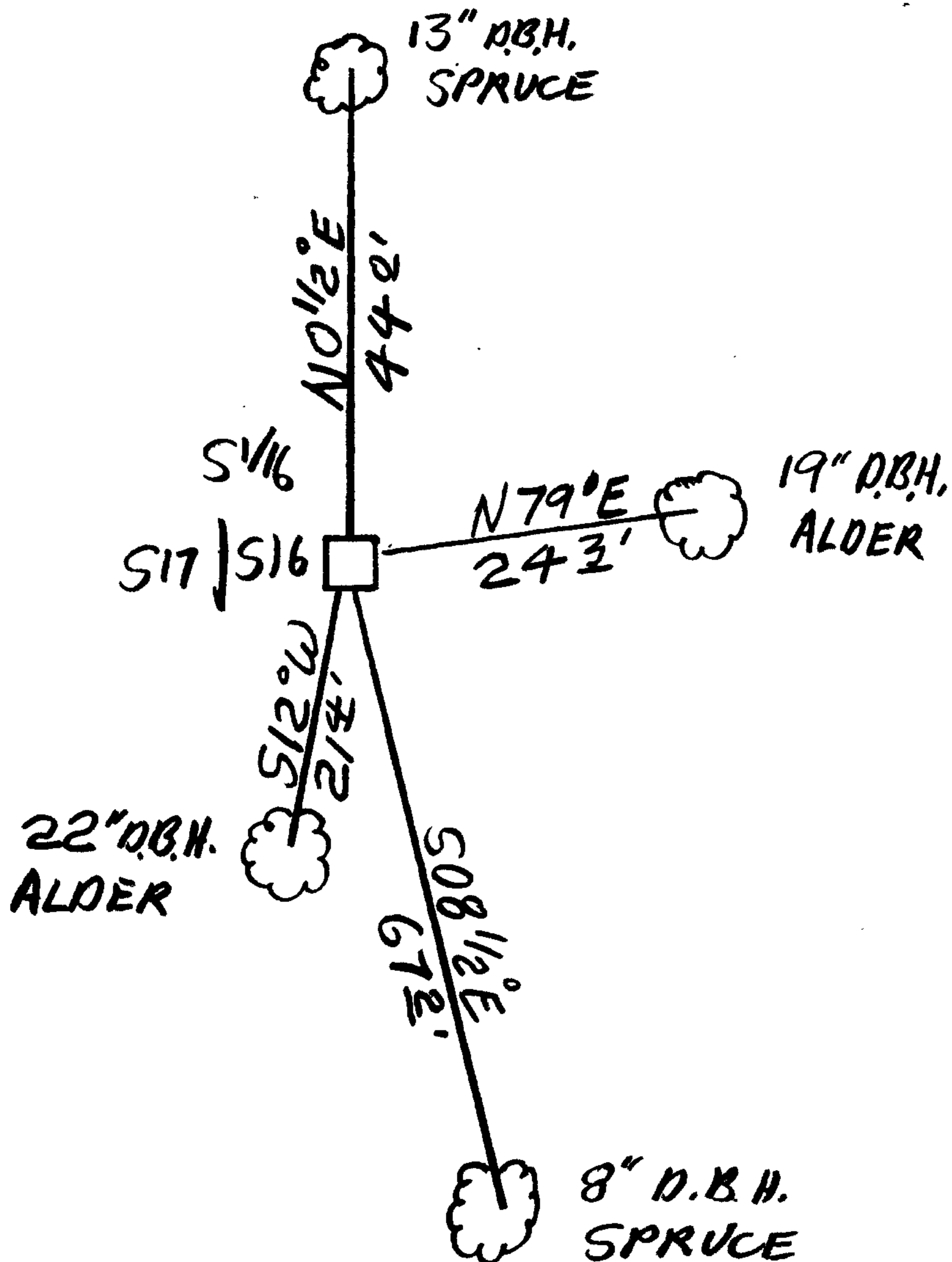

Location & Comments

MONUMENT IS NEAR BOTTOM OF VERY STEEP SOUTHEAST SLOPE AND APPROXIMATELY 15 FEET HIGHER THAN A SMALL CREEK RUNNING NORTHEAST.

Comp. Declin. 18 1/2° E

Agency DCSO

Party Chief J.R. LUNDEEN

Notekeeper J.R. LUNDEEN

Witnesses R.W. SMITH

Stephen John Hauke

Address ROOM 205 JUSTICE HALL
ROSEBURG, OR 97470

