

RENEWAL

Monument Set (Procedure and Description)

WE FIND RECORD BEARINGS AND DISTANCES FIT WELL AND SET A 2 3/8" BC ON 1" 4 IN. I.D. IRON PIPE, 32 INCHES LONG PROTRUDING 6" ABOVE GROUND AND STAMPED

"DOUGLAS COUNTY SURVEYORS OFFICE"
T22S R12W 1/4 S7 1986"
S18

Monument Detail

DOUGLAS COUNTY SURVEYORS OFFICE
T22S R12W
1/4 S7
S18
1986

New Accessories

- 17" SPRUCE BEARS N51°E, 20.4 FT WITH DOUBLE BLAZE AND SCRIBED "1/4 S7 CS BT"
- 8" ALDER BEARS N50°W, 4.5 FT AND BARK SCRIBED "CS 1/4 S7 BT"
- 18" SPRUCE BEARS S69 1/2°W, 8.4 FT WITH DOUBLE BLAZE & SCRIBED "1/4 S18 CS BT"
- 16" SPRUCE BEARS S2°E, 13.0 FT WITH DOUBLE BLAZE & SCRIBED "1/4 S18 CS BT"

Sketch of Monument, Accessories, and General Area

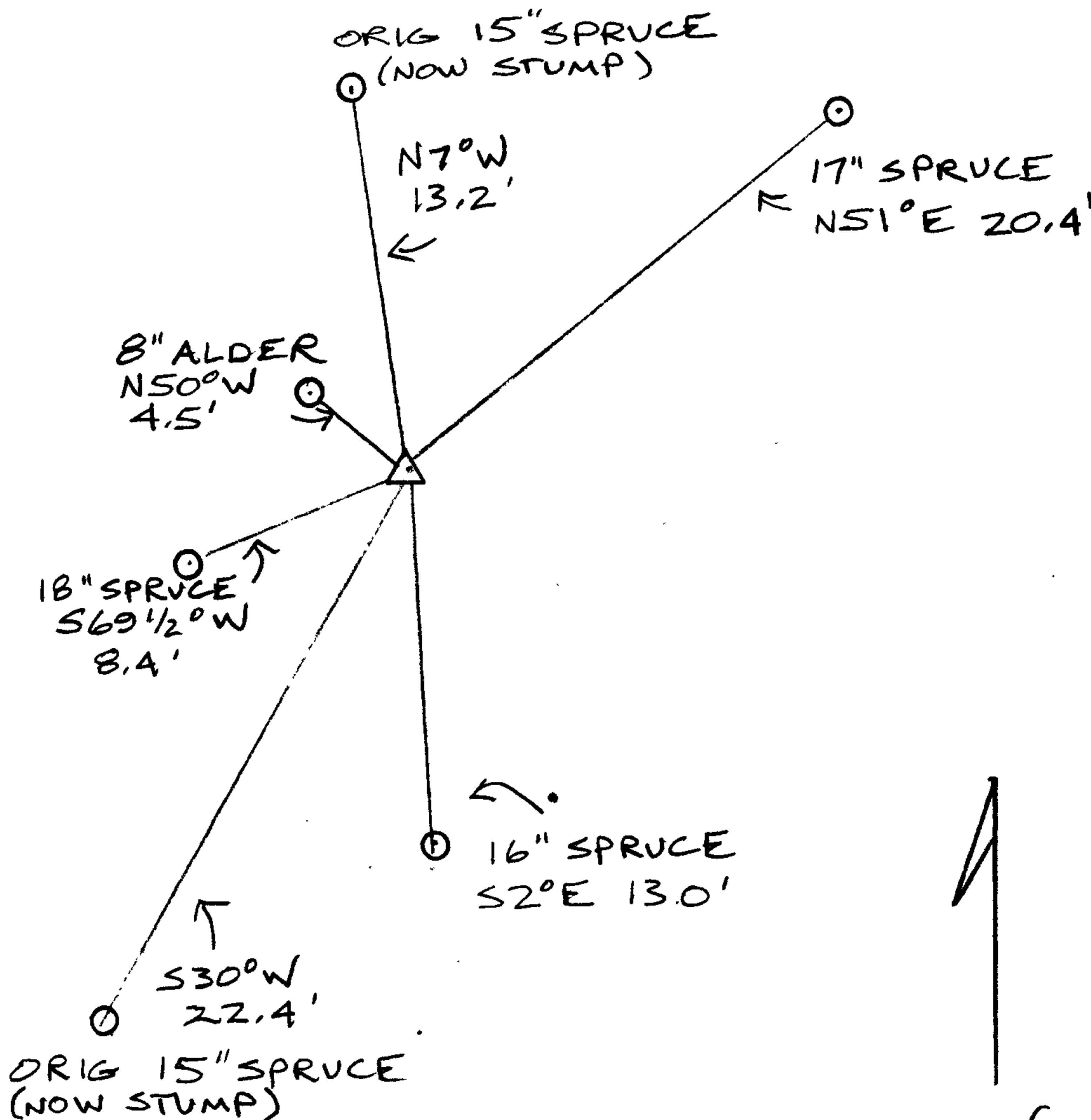

Location & Comments

APPROX 100 FT EAST OF TOP OF RIDGE, AS CALLS INDICATE.

Comp. Declin. 18 1/2° E
Agency DCSD
Party Chief J. LUNDEEN
Notekeeper "
Witnesses R. SMITH
S. FLAUXE

Address ROOM 205
JUSTICE HALL - ROSEBURG
Surveyor's Seal

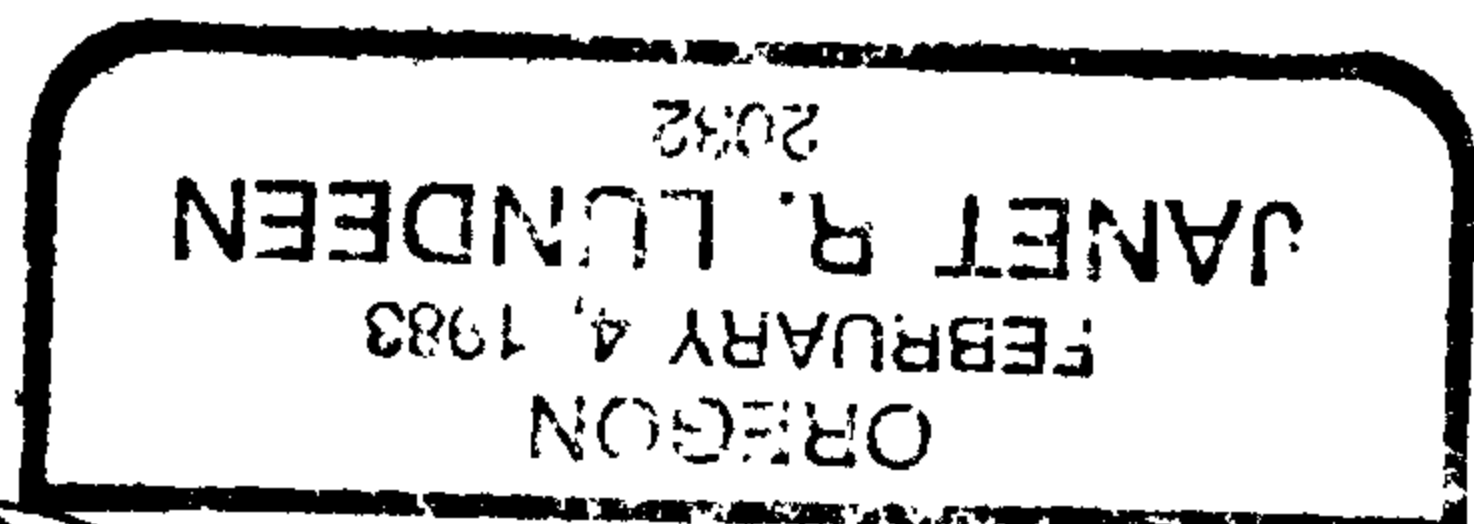

Janet R. Lundeen

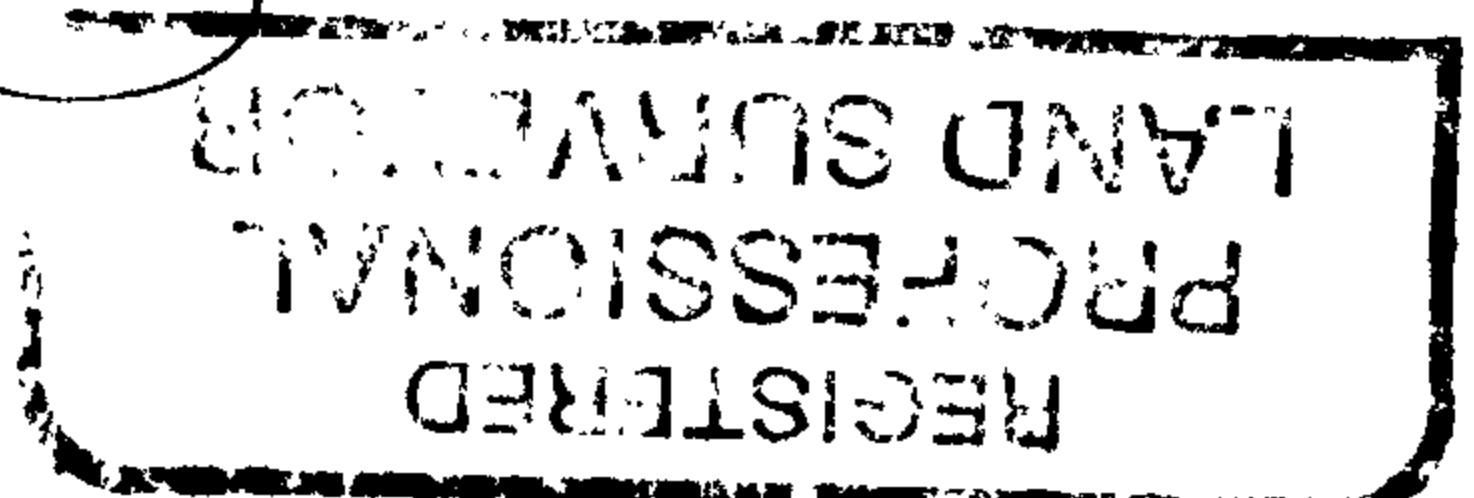

OK
JLM

N
1" = 10'