

GOVERNMENT CORNER RESTORATION FORM

Township 225 Range 8W Sec. 21 County DOUGLAS  
State OREGON Date APRIL 23, 1987 No. \_\_\_\_\_

Corner Designation

WC

DLG 43

- Condition Report Only
- Not Found
- Renewed
- Unrecorded
- Surveyed In
- Referenced Out

Previous Renewals # 6, # 116

Monument(s) Found: (Condition and Source)

A 2 1/2 INCH DIAMETER BRASS CAP (MARKED AS AT RIGHT) ON A 1 INCH I.D. IRON PIPE 2 FEET UNDER SURFACE OF GROUND, PLUMB AND FIRMLY SET.

RECORD STAMPING IS "55' N" (DESCRIBING BEARING AND DISTANCE FROM W.C. TO CORNER) WE FIND STAMPING AS AT RIGHT.

COUNTY SURVEYORS OFFICE

T 22 S

55 FT W.  
TO 44/43 C.  
COR

R8W  
1964

Accessories Found:

SEARCHED FOR ORIGINAL AND RENEWAL #6 B.T.S. NO EVIDENCE FOUND. TWO B.T.S. FROM RENEWAL #116, WHICH ESTABLISHES W.C., FOUND. A 42" W. OAK NOW A 46 INCH D.B.H. WHITE OAK WITH A FULLY HEALED DOUBLE BLAZE BEARS S 33 1/2° E, 409.8 FEET DISTANT (AS PER RECORD). A 13" W. OAK NOW AN 18 INCH D.B.H. WHITE OAK WITH A FULLY HEALED DOUBLE BLAZE BEARS S 27 1/2° E, 389.1 FEET DISTANT (AS PER RECORD).

#171 X

RENEWAL

Monument Set (Procedure and Description)

THE POSITION OF THE WITNESS CORNER AS ESTABLISHED IN RENEWAL #116 IS PERPETUATED BY PLACING A NEW MONUMENT DIRECTLY ABOVE THE FOUND BRASS CAP MONUMENT. THE NEW MONUMENT IS A 2 3/8 INCH DIAMETER BRASS CAP, MARKED AS AT RIGHT, ON A 1 INCH I.D. 32 INCH LONG IRON PIPE, SET PROTRUDING 5 INCHES FROM GROUND.

Monument Detail

DOUGLAS COUNTY SURVEYORS OFFICE

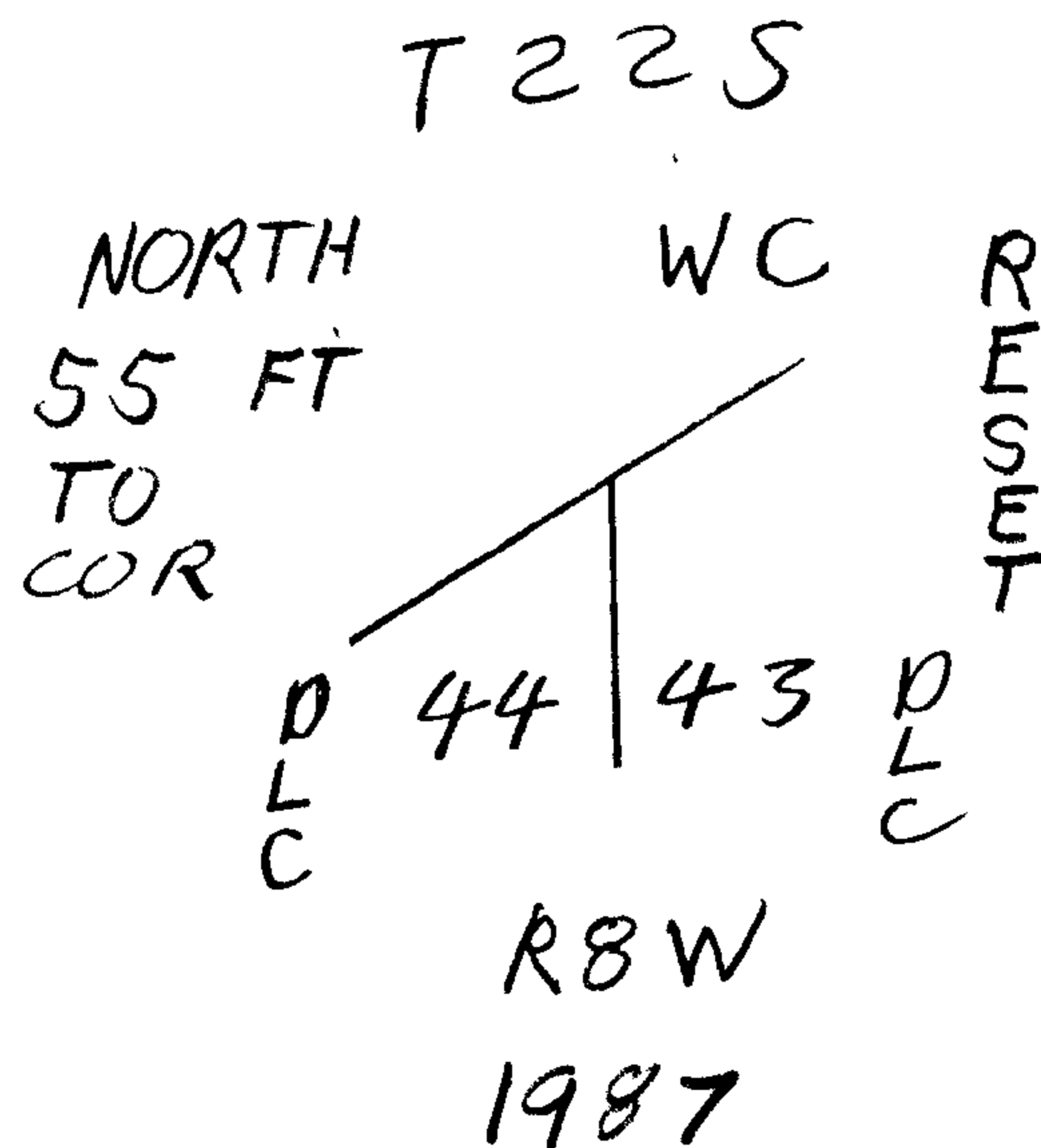

New Accessories

A 9 INCH D.B.H. ASH DOUBLE BLAZED AND SCRIBED "NW DLC 43 CS BT" GROWING FROM NORTHEAST EDGE OF A 36 INCH DIAMETER 2 FOOT TALL ASH STUMP. BEARING AND DISTANCE ARE MEASURED TO BASE OF TRUNK OF 9 INCH D.B.H. ASH WHERE IT GROWS FROM STUMP. 9 INCH D.B.H. ASH BEARS N 50° E, 139.4 FEET DISTANT.

Sketch of Monument, Accessories, and General Area

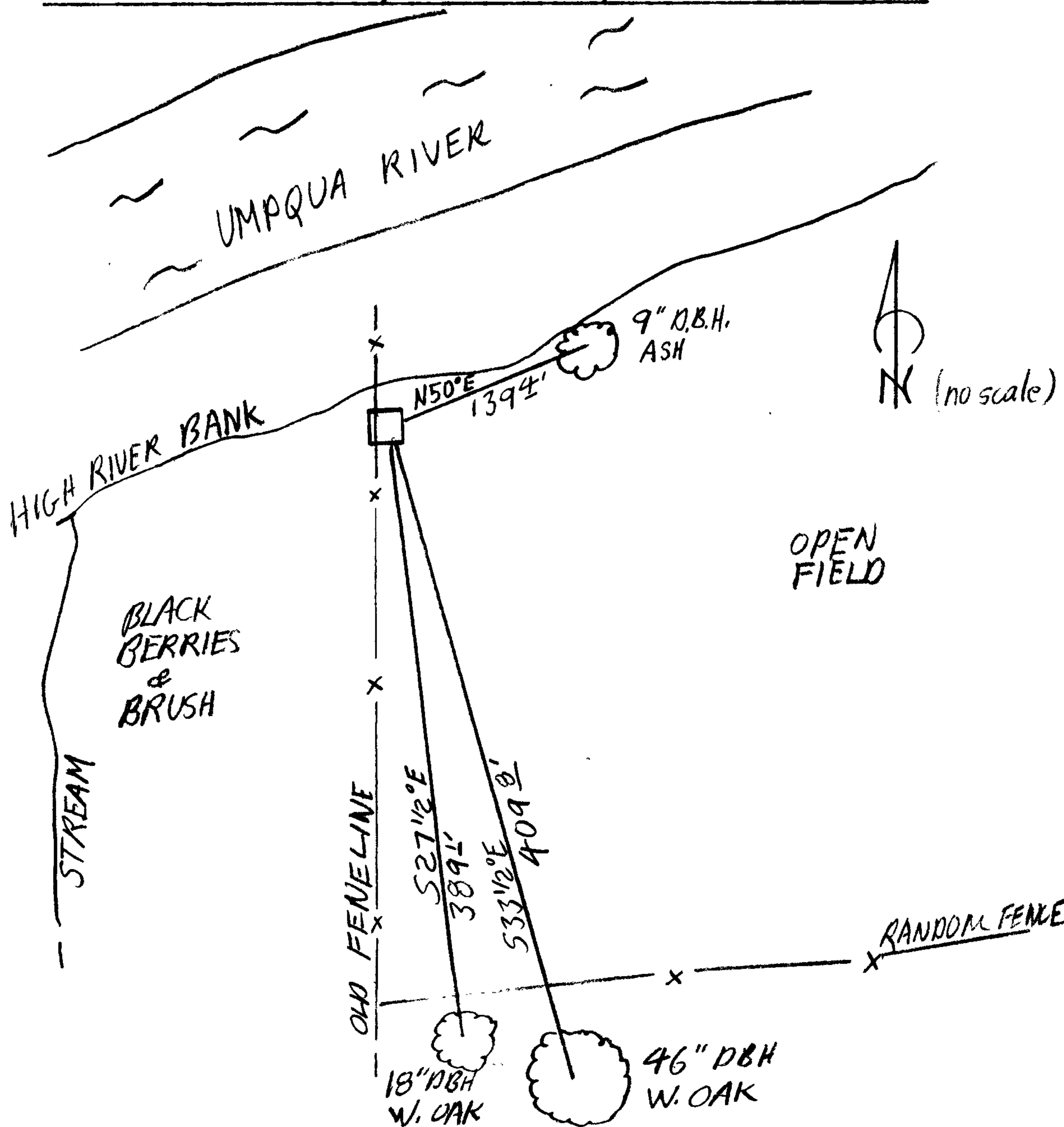

Location & Comments

MONUMENT IS AT TOP OF HIGH SOUTH BANK OF THE UMPQUA RIVER IN AN OLD NORTH-SOUTH FENCELINE.

Comp. Declin. 18 1/2° E  
 Agency DCSO  
 Party Chief STEPHEN JOHN FLAISE  
 Notekeeper R.W. SMITH  
 Witnesses Stephen John Flaise

Address

Surveyor's Seal

REGISTERED  
PROFESSIONAL  
LAND SURVEYOR

*Larry E. Monrean*

OREGON  
JULY 13, 1979  
LARRY E. MONREAN  
#1830