

GOVERNMENT CORNER RESTORATION FORM

Township 22S Range 4W Sec. 26 County DOUGLAS
State OR Date 4/27/87 No. _____

Corner Designation

1/4 S27 | S26

- _____ Condition Report Only
- _____ Not Found
- Renewed
- _____ Unrecorded
- _____ Surveyed In
- _____ Referenced Out

Previous Renewals #25

MONUMENT DETAIL

Monument(s) Found: (Condition and Source)

A W. HAINES T-IRON WITH METAL WASHER PROTRUDING 1 FT ABOVE GROUND, BENT SLIGHTLY WEST

ORIG. STONE NOT FOUND

WILFORD N. HAINES
239
SURVEY
POINT
DRAIN ORE

Accessories Found:

16" NOW 34" DIA. 5 FT HIGH D. FIR STUMP WE OPEN AND FIND SCRIBING "BT" UPPER FACE SHOWS GOOD AXE MARKS SCRIBING POSSIBLY CHOPPED OUT. BEARS N 81° E, 25.6 FT. (REC. N 21° E, 24.4 FT POSSIBLE FACE MEASUREMENT) ORIG. BT.

40" NOW 38" DIA 4 FT HIGH D. FIR STUMP AXE MARKS AND FLAT SPOTS FOUND ON BARK WE OPEN AND FOUND NO BURL, BLAZES, AXE MARKS OR SCRIBING. BEARS N 9° W, 38.8 FT (REC N 9° W, 37.0 POSSIBLE FACE MEASUREMENT). POSSIBLE ORIG. BT

#143 X

RENEWAL

Monument Set (Procedure and Description)

A DCSO 2 3/8" BRASS CAP ON A 1" I.D. X 32" LONG IRON PIPE PROTRUDES 6 IN ABOVE GROUND HAINES T IRON 30 IN LONG PROTRUDES 4 IN ABOVE GROUND, RESET ALONG NORTH EDGE OF BC/I.P.

DCSO BC/I.P. SET AT FOUND PLUMB POSITION OF HAINES T IRON.

Monument Detail

DOUGLAS COUNTY SURVEYORS OFFICE

T225

1/4

S27 | S26

RAW

1987

New Accessories

37" DIA. 4 FT HIGH D. FIR STUMP, SET A BOAT SPIKE THROUGH BT TAG STAMPED "BO1" BEARS S36°W, 612 FT.

34" DIA. 1 1/2 FT HIGH CEDAR STUMP, SET A BOAT SPIKE THROUGH BT TAG STAMPED "BO1" BEARS N46°E, 479 FT

Sketch of Monument, Accessories, and General Area

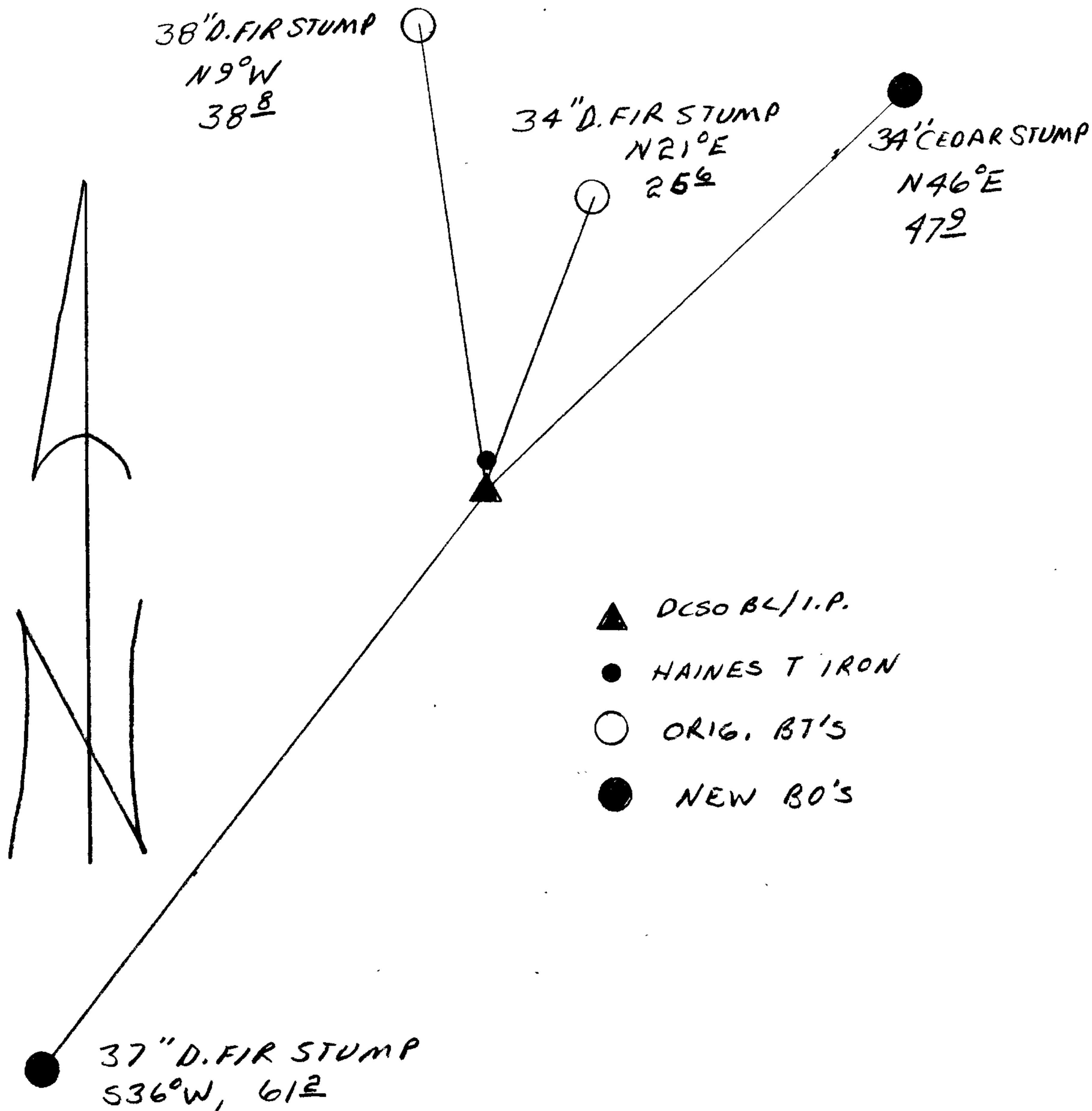

Location & Comments

CORNER LIES IN A CLEARCUT AT BOTTOM OF A EASTERLY - WESTERLY RAVINE

Comp. Declin. 18 1/2° E

Agency DCSO

Party Chief LARRY E. MONREAN

Notekeeper RANDALL W. SMITH

Witnesses STEPHEN J. FLAUSE

Address

Surveyor's Seal

REGISTERED PROFESSIONAL LAND SURVEYOR

Larry E. Monrean

OREGON JULY 13, 1979 LARRY E. MONREAN #1830