

GOVERNMENT CORNER RESTORATION FORM

Township 21S Range 8W Sec. 7 County DOUGLAS

State OR Date 4/16/87 No. _____

Corner Designation

PROPORTIONED
CORNER

1/4 S 7 ONLY

- _____ Condition Report Only
- _____ Not Found
- Renewed
- _____ Unrecorded
- _____ Surveyed In
- _____ Referenced Out

Previous Renewals 1945 DEP. RESURVEY, 1967 DEP. RESURVEY,

Monument(s) Found: (Condition and Source)

A 6.0 2 1/2 IN. DIA. BRASS CAP ON
A 1 IN. UP, LOOSELY SET AND LEANING
4 IN. NORTH, PROTRUDES 12 IN. ABOVE
GROUND.

1985 L.D. ROBERTS
CONDITION REPORT - (CS 63/18)

MONUMENT DETAIL

U.S. GENERAL LAND OFFICE SURVEY

BRASS CAP IS FACING SOUTH, WHICH
MAKES SECTION SEVEN APPEAR WEST
OF CORNER.

1/4
S 7

1945

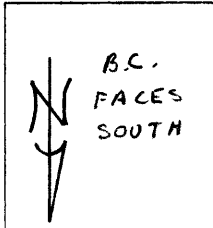

Accessories Found:

ALL DIST. AND BRGS TO PLUMB POSITION OF BC/UP.

24" NOW 25" DIA 2 FT HIGH BURNED AND ROTTED D. FIR STUMP WITH A PARTIAL BLAZE
VISIBLE, BEARS N 67 1/4 ° E, 20.5 FT (AGREES WELL WITH 1945 D. RESURVEY
REC.) PER 1945 D. RESURVEY. (N 67 1/4 ° E, 20.5 PER 1967 D. RESURVEY).

37" NOW 46" DIA. 4 FT HIGH BURNED AND ROTTED D. FIR STUMP, NO MARKS OR
BLAZES FOUND, BEARS S 57 1/4 ° E, 108.8 FT (AGREES WELL WITH REC.)
PER 1945 D. RESURVEY.

5" NOW 15" DIA. D. FIR WITH A FULLY HEALED SINGLE BLAZE
BEARS N 56 1/2 ° E, 61.5 FT (REC. N 56 1/2 ° E, 60.7 FT DIST. IS A FACE MEASUREMENT)
PER 1967 D. RESURVEY.

6" MAPLE BURNED AND GONE, SMALL MAPLES GROWING FROM ROOTS
NEAR BEARING AND DISTANCE. PER 1967 D. RESURVEY

WITNESS POST AND SIGN, BEARS EAST 1 1/2 FT. SET BY
L.D. ROBERTS RLS # 1039 1985 CONDITION REPORT

EAST 1/4 SEC 12 ONLY (1967 BLM BC/UP.)
BEARS SOUTH, 79.7 FT (AGREES WELL WITH L.D. ROBERT, RLS # 1039
1985 CONDITION REPORT) 1967 BLM D. RESURVEY SHOWS A DISTANCE
BETWEEN BC/UP. AS 80.52 FT.

#50 T21-9 X
#40 T21-8 X

RENEWAL

Monument Set (Procedure and Description)

1945 GLO BC/11.P. IS RETURNED TO PLUMB POSITION, AND IS SURROUNDED BY A 2 FT DIA. 1 FT HIGH MOUND OF SAND STONE. BRASS CAP FACES SOUTH.

A SEARCH WAS MADE FOR ORIGINAL EVIDENCE BUT NONE WAS FOUND.

Monument Detail

N/A

New Accessories

14" DIA. D. FIR WITH A DOUBLE BLAZE SCRIBED "1/4 S7 CS BT" BEARS N174°E, 23.8 FT.

13" DIA. D. FIR WITH A DOUBLE BLAZE SCRIBED "1/4 S7 CS BT" BEARS N82°E, 21.1 FT.

Sketch of Monument, Accessories, and General Area

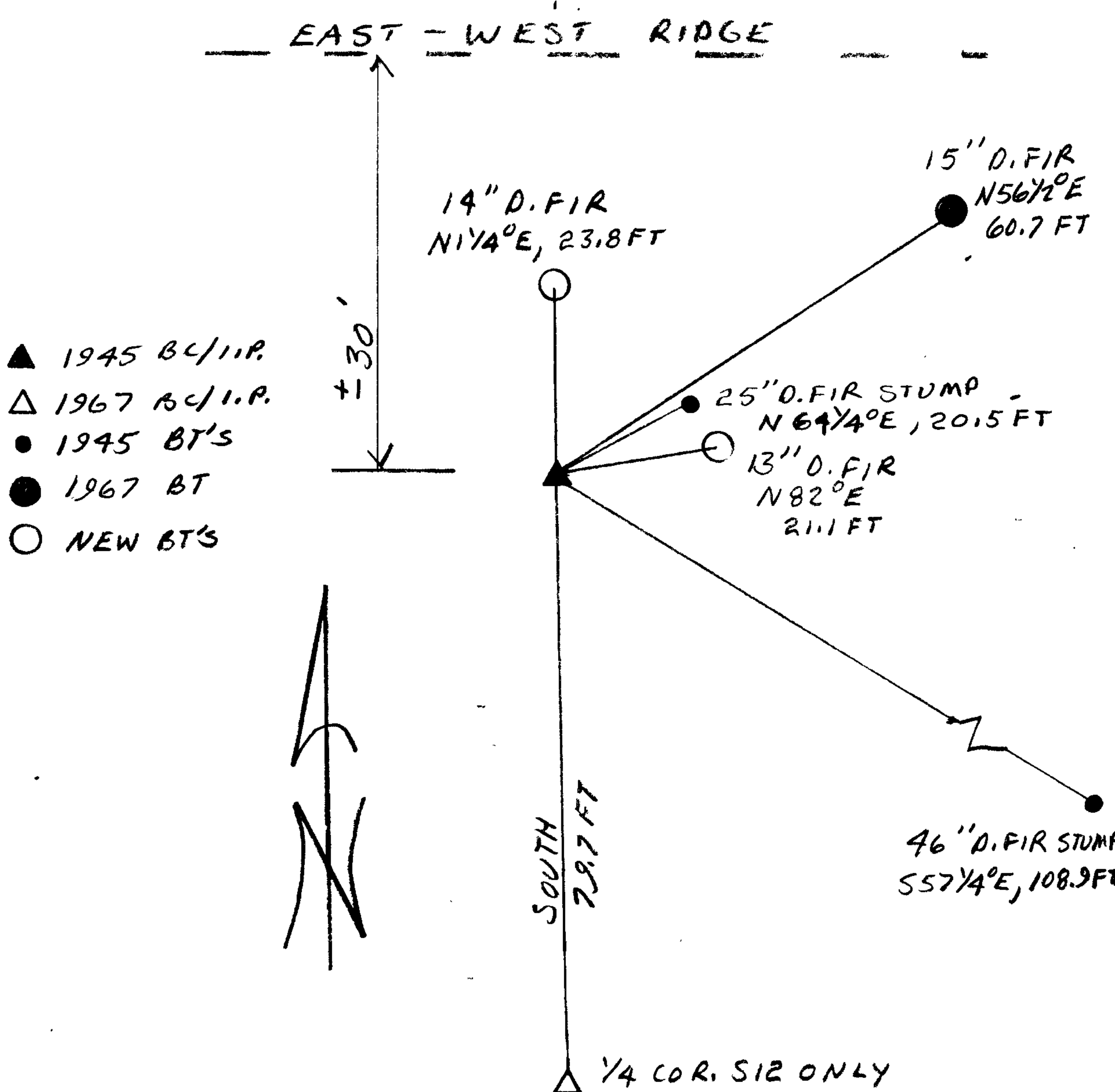

Location & Comments

BC/11.P. IS APPROX 30 FT SOUTH OF A E-W RIDGE ON A STEEP SOUTHEAST SLOPE.

Comp. Declin. 18 1/2° E
Agency DCSO
Party Chief RANDALL W SMITH
Notekeeper Randall W Smith
Witnesses STEPHEN J FLAUSE

Address

Surveyor's Seal

REGISTERED PROFESSIONAL LAND SURVEYOR

Larry E. Monrean

OREGON
JULY 13, 1979
LARRY E. MONREAN
#1830