

GOVERNMENT CORNER RESTORATION FORM

Township 23S Range 6W Sec. 26 County DOUGLAS

State OR Date 4/13/87 No. _____

Corner Designation

527	526
534	535

- Condition Report Only
- Not Found
- Renewed
- Unrecorded
- Surveyed In
- Referenced Out

Previous Renewals 1957 BLM D. RESURVEY, REN #41 C.S. 57/17

MONUMENT DETAIL

Monument(s) Found: (Condition and Source)

A 3 IN. DIA BRASS CAP ON AN I.P., PROTRUDES 1 IN. ABOVE A 2 FT DIA. MOUND OF STONE. (PER. 1957 BLM D. RESURVEY)

A HAINES T IRON AND METAL WASHER STAMPED RLS # "239" PROTRUDES 18 IN. ABOVE GROUND. T IRON IS ALONG NE EDGE OF B/L.P. (RECORD OF HAINES T IRON AT THIS CORNER NOT FOUND).

U.S. CADASTRAL SURVEY

T23S R6W

527	526
534	535

1957

BUREAU OF LAND MANAGEMENT

Accessories Found:

30" MAPLE NOW DEPRESSION IN GROUND S80°E, 10.6 FT (AGREES WELL WITH REC.) ORIG. BT NO OTHER ORIG. BT'S FD.

BT'S PER BLM D. RESURVEY 1957

25" NOW 32" DIA 4 FT HIGH MAPLE STUMP WITH A PARTIALLY HEALED SINGLE BLAZE, SCRIBING VISIBLE "S 26 B" BEARS N87°E, 141.9 FT (AGREES WITH REC.)

30" DIA. CEDAR UPROOTED, DOWN AND BURNT, NO BLAZES OR MARKS FOUND. BEARS S50°E, 32.3 FT (AGREES WITH REC.)

46" DIA. CEDAR SNAG, BT IS BURNT AND NO BLAZES OR MARKS FOUND. BEARS S34 3/4°W, 91.1 FT (AGREES WITH REC.)

29" NOW 36" DIA. D. FIR WITH A FULLY HEALED SINGLE BLAZE BEARS N47 1/4°W, 208.6 FT (AGREES WITH REC.)

BT'S PER REN #41

34" NOW 48" DIA. MAPLE WITH A PARTIALLY HEALED SINGLE BLAZE, SCRIBING VISIBLE "6 W 534" BEARS S89°W, 128.8 FT (AGREES WITH REC.)

34" NOW 28" DIA. CEDAR WITH A FULLY HEALED DOUBLE BLAZE BEARS S30°E, 92.3 FT (AGREES WITH REC.)

WITNESS POST AND SIGN ALONG NE SIDE OF B/L.P. PER CS 57/17

U.S. File No. 62/40-10

#78 ✓

RENEWAL

Monument Set (Procedure and Description)

NONE

Monument Detail

N/A

New Accessories

8" ALDER DOUBLE BLAZED AND SCRIBED "T23S R6W S26 CS BT"
BEARS N14°E, 16.3 FT.

Sketch of Monument, Accessories, and General Area

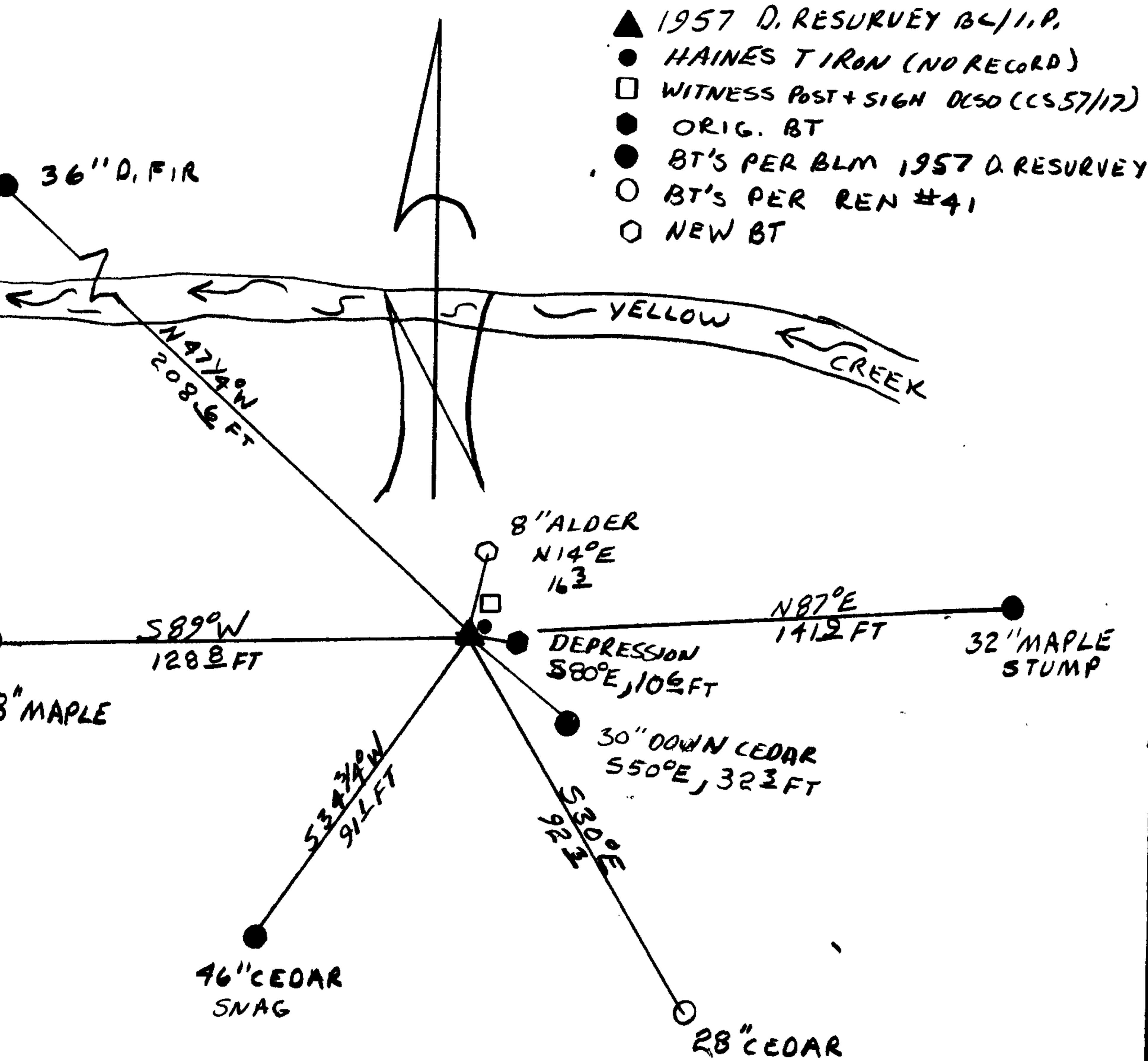

Location & Comments

CORNER LIES IN CREEK
BOTTOM ON SOUTH SIDE
OF YELLOW CREEK APPROX. 175 FT

Comp. Declin. 18 1/2° E
Agency DCSO
Party Chief RANDALL W SMITH
Notekeeper TERRIE FRANSSSEN
Witnesses

Address RA 206 JUSTICE AVE.
REAR, OR 9747

Surveyor's Seal

REGISTERED
PROFESSIONAL
LAND SURVEYOR

Larry E. Monrean

OREGON
JULY 13, 1979
LARRY E. MONREAN
#1830