

GOVERNMENT CORNER RESTORATION FORM

Township 24S Range R2W Sec. 36 County DOUGLAS

State OR Date 12/09/86 No. _____

Corner Designation

S35 | S36
TR 39 | TR 40

- Condition Report Only
- Not Found
- Renewed
- Unrecorded
- Surveyed In
- Referenced Out

Previous Renewals NONE

Monument(s) Found: (Condition and Source)
2 1/2" DIA BY 28" LONG I.P. WITH BRASS
CAP OUT OF GROUND LEANING
AGAINST NE BT.

U.S. CADASTRAL SURVEY

TR 4S R 2W
 S35 | S36
 TR 39 | TR 40
 1963

BUREAU OF LAND MANAGEMENT

Accessories Found:

BTS PER. 1963 D. RESURVEY

32" NOW 33" DIA. 5 FT HIGH D. FIR STUMP WITH A FULLY HEALED
SINGLE BLAZE THAT WE PARTIALLY OPEN AND FIND SCRIBING
"BT" BEARS N61 3/4° E, 35.0 FT (AGREES WITH REC.).

30" NOW 31" DIA. D. FIR WITH A FULLY HEALED SINGLE BLAZE
BEARS S23 1/2° E, 23.8 FT (REC S21 1/2° E, 23.8 FT).

#116 ✓

RENEWAL

Monument Set (Procedure and Description)

BC/I.P. SET AT POSITION DETERMINED BY INTERSECTING DISTANCES AND BEARINGS (S.E. BT'S BEARING SLIGHTLY DIFFERENT THAN RECORD). OLD FLAGGING WAS FOUND APPROX. 1 FT. UNDER GROUND IN HOLE DUG TO RESET BC/I.P. WE STAMP 1963 BLM BC/I.P. "RESET 1986", BC/I.P. PROTRUDES 10 IN. ABOVE GROUND, SURROUNDED BY A 2 1/2 FT DIA. MOUND OF STONE.

~~1963 BLM BC/I.P. STAMPED~~ ~~S35 | S36~~
~~BEARS N 21 1/2° E, 64 1/2 FT.~~ ~~TR 39~~
~~(AGREES WELL WITH REC. 1963~~
~~N 21 1/2° E, 64 1/2 FT.)~~ ~~JCM~~

THE NORTHEAST CORNER TR 39 A 2 1/2" DIAM. I-PIPE & BRASS CAP BEARS N 21 1/2° E 64 1/2 FEET.

Monument Detail

U.S. CADASTRAL SURVEY
T 24 S R 2 W

S 35 | S 36
TR 39 | TR 40

1963
RESET 1986

BUREAU OF LAND MANAGEMENT

New Accessories

9" MAPLE DOUBLE BLAZED AND SCRIBED "S 36 CS BT"
 BEARS N 81 1/2° E, 23° FT.

20" D. FIR DOUBLE BLAZED AND SCRIBED "TR 39 S 35 CS BT"
 BEARS S 55° W, 14° FT.

Sketch of Monument, Accessories, and General Area

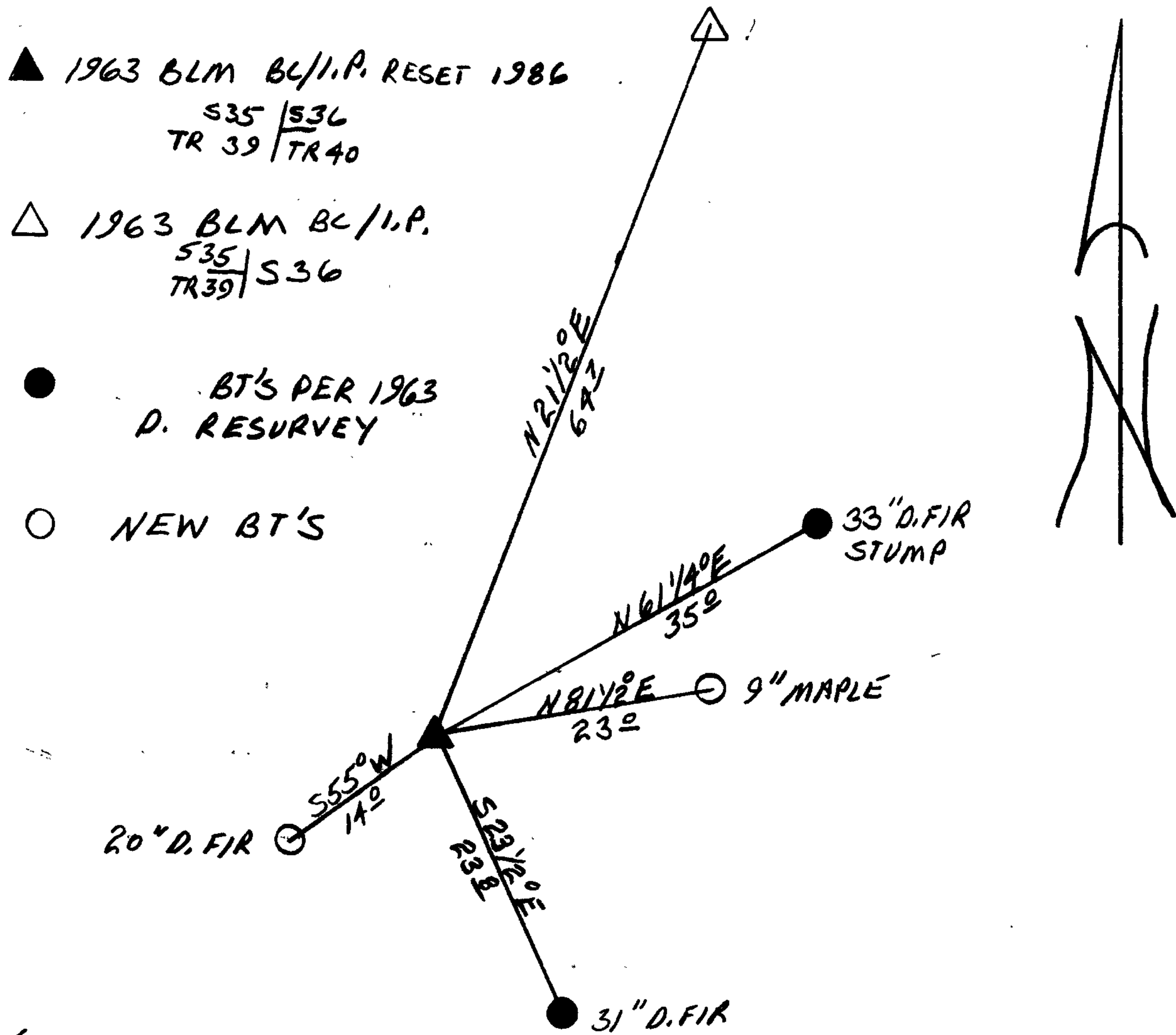

Location & Comments

CORNER LIES AT SW CORNER OF NEW CLEARCUT ON STEEP NW SLOPE.

Comp. Declin. 18 1/2° E
 Agency DLSO
 Party Chief RANDALL W SMITH
 Notekeeper Garrett W Smith
 Witnesses STEPHEN J FLAISE

Address

Surveyor's Seal

REGISTERED
PROFESSIONAL
LAND SURVEYOR

Larry E. Monrean

OREGON
JULY 13, 1979
LARRY E. MONREAN
#1830