

GOVERNMENT CORNER RESTORATION FORM

Township R4S Range RW Sec. 35 County DOUGLAS

State OR Date 12/09/86 No. _____

Corner Designation

S35 | S36
TR39

- Condition Report Only
- Not Found
- Renewed
- Unrecorded
- Surveyed In
- Referenced Out

Previous Renewals NONE

Monument(s) Found: (Condition and Source)

2 1/2" DIA. I.P. WITH BRASS CAP,
LEANING 7 IN. WEST OF PLUMB
POSITION.

US GENERAL LAND OFFICE SURVEY
T24S R2W

S35 | S36
TR39

1963

Accessories Found:

BT'S PER 1963 D. RESURVEY
13" NOW 14" DIA. DOWN AND OUT OF GROUND SUGAR PINE WITH
SCRIBING VISIBLE "TR 39 S35 BT" BEARS S85°W, 63.6 FT TO CENTER OF
ROOT WAD. POSSIBLE STUMP HOLE AT RECORD BEARING AND DISTANCE
(S 80 1/2°W, 59.4 FT).

NW BT GONE STUMP HOLE AT RECORD BEARING AND DISTANCE
(N 3 1/2°W, 24.4 FT).

#115 X

RENEWAL

Monument Set (Procedure and Description)

POSITION OF BC/I.P. STRAIGHTENED TO PLUMB
~~11" DIA. AND ACCEPTED AS CORNER POSITION. A~~
 2 FT MOUND OF STONE PLACED ALONG
 WEST EDGE OF I.P. (SEE SKETCH).
 " TR45 R2W "
~~1963 BLM BC/I.P. STAMPED S35 | S36~~
~~BEARS S01°W, 64² FT TR39 TR40~~
~~FAGREES WELLS WITH REC. 1963~~
~~S 21° 37' W, 64² FT) RESET 1986~~

THE NORTHWEST CORNER TR 40 AN IRON PIPE
 AND GRASS CAP (2 1/2" DIAM) BEARS S 21 1/2° W
 64² FEET. 11" ~~m~~

Monument Detail

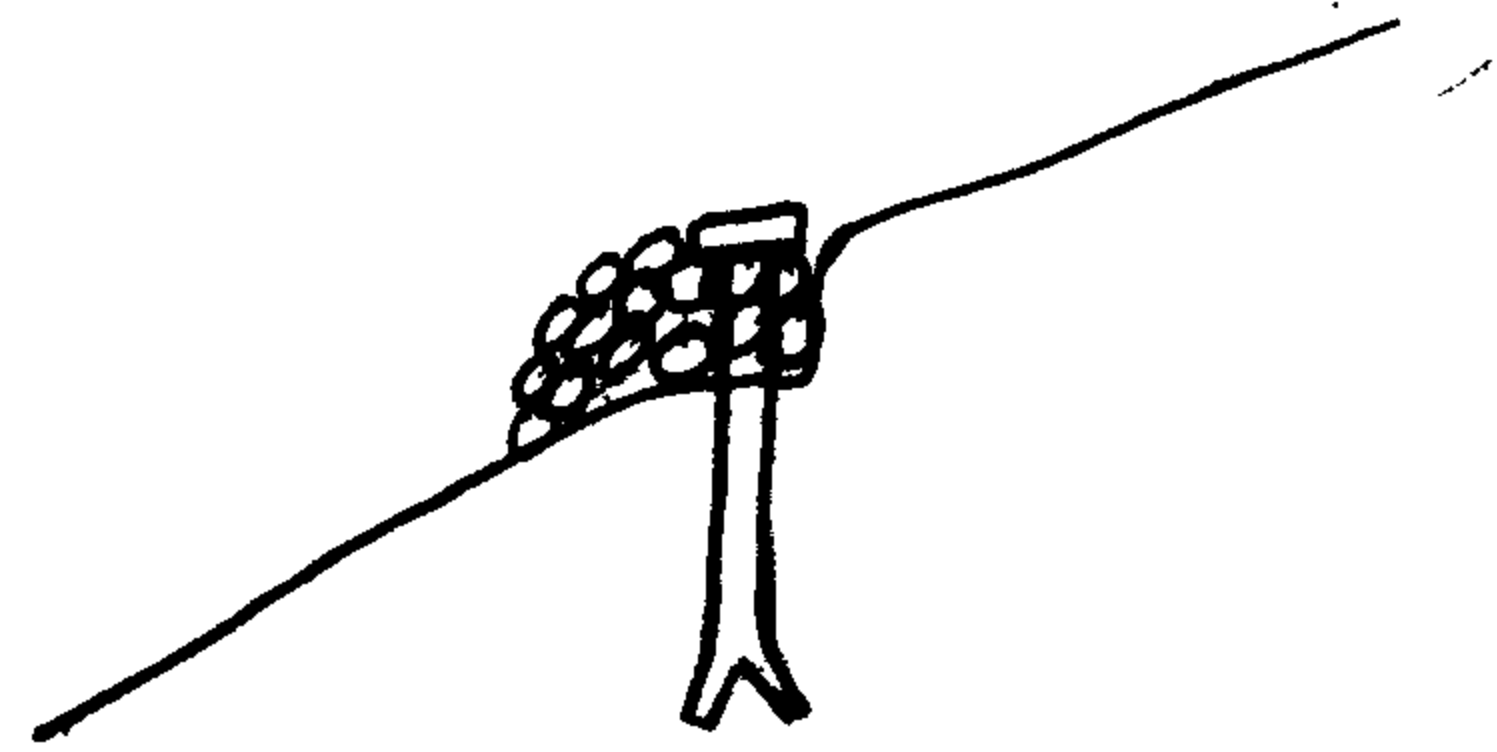

BC/I.P. FLUSH WITH GROUND
 ON EAST AND 1 1/2 FT ABOVE
 GROUND ON WEST EDGE OF I.P.

New Accessories

9" DIA. CEDAR DOUBLE BLAZED "S36 CS BT" BEARS S 38 1/2° E, 35⁵ FT.
 10" DIA. D. FIR DOUBLE BLAZED "S35 CS BT" BEARS N 73° W, 56² FT.
 36" DIA 5 FT HIGH D. FIR STUMP WITH A BOAT SPIKE STAMPED "CS B01 1986" DRIVEN
 THROUGH BT TAG IN TOP OF STUMP. BOAT SPIKE BEARS N 28° E, 34⁶ FT.
 18" DIA. 3 FT HIGH D. FIR STUMP WITH A BOAT SPIKE STAMPED "CS B02 1986" DRIVEN
 THROUGH BT TAG IN TOP OF STUMP. BOAT SPIKE BEARS S 23° W, 8³ FT.

Sketch of Monument, Accessories, and General Area

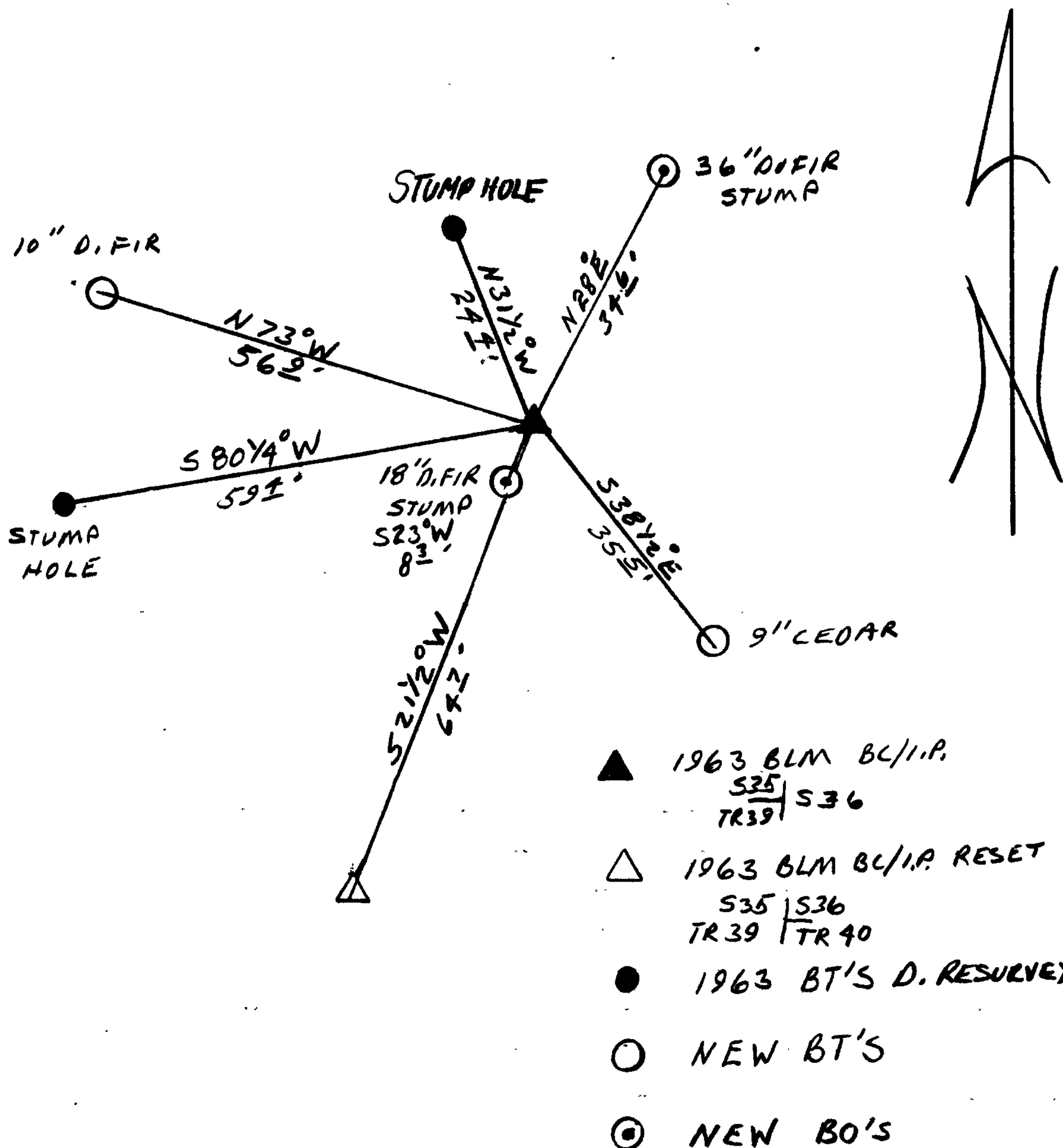

Location & Comments

CORNER LIES AT SW CORNER
 OF NEW CLEAR CUT ON
 STEEP NW SLOPE.

Comp. Declin. 18 1/2° E
 Agency DLSO
 Party Chief RANDALL W SMITH
 Notekeeper Randall W Smith
 Witnesses STEPHEN J FLAKE

Address

Surveyor's Seal

REGISTERED
 PROFESSIONAL
 LAND SURVEYOR

Larry E. Monrean

OREGON
 JULY 13, 1979
 LARRY E. MONREAN
 #1830