



RENEWAL

Monument Set (Procedure and Description)

APPARENT RECORD BEARING RECORDING PROBLEM IS BEST RESOLVED BY INTERCHANGING BEARINGS OF TREES WHILE RETAINING BT QUADRANT AND DISTANCE. BLAZE ORIENTATION SUPPORTS THIS IDEA.

AT POSITION AS NOTED SET A 1" X 32" GALV. IRON PIPE WITH BRASS CAP MARKED AS NOTED. MONUMENT PROTRUDES 9 INCHES ABOVE GROUND.

Monument Detail

DOUGLAS COUNTY SURVEYORS  
T 24 S  
 $\frac{1}{4} \frac{513}{524}$   
RIW  
1986  
OFFICE

New Accessories

11" DIAM. D. FIR DOUBLE BLAZED & SCRIBED "1/4 513 CS BT" BEARS N 12 1/4° W 20° FT.

6" DIAM. D. FIR DOUBLE BLAZED & SCRIBED "1/4 524 CS BT" BEARS S 30 1/2° W 10 ± FT.

Sketch of Monument, Accessories, and General Area

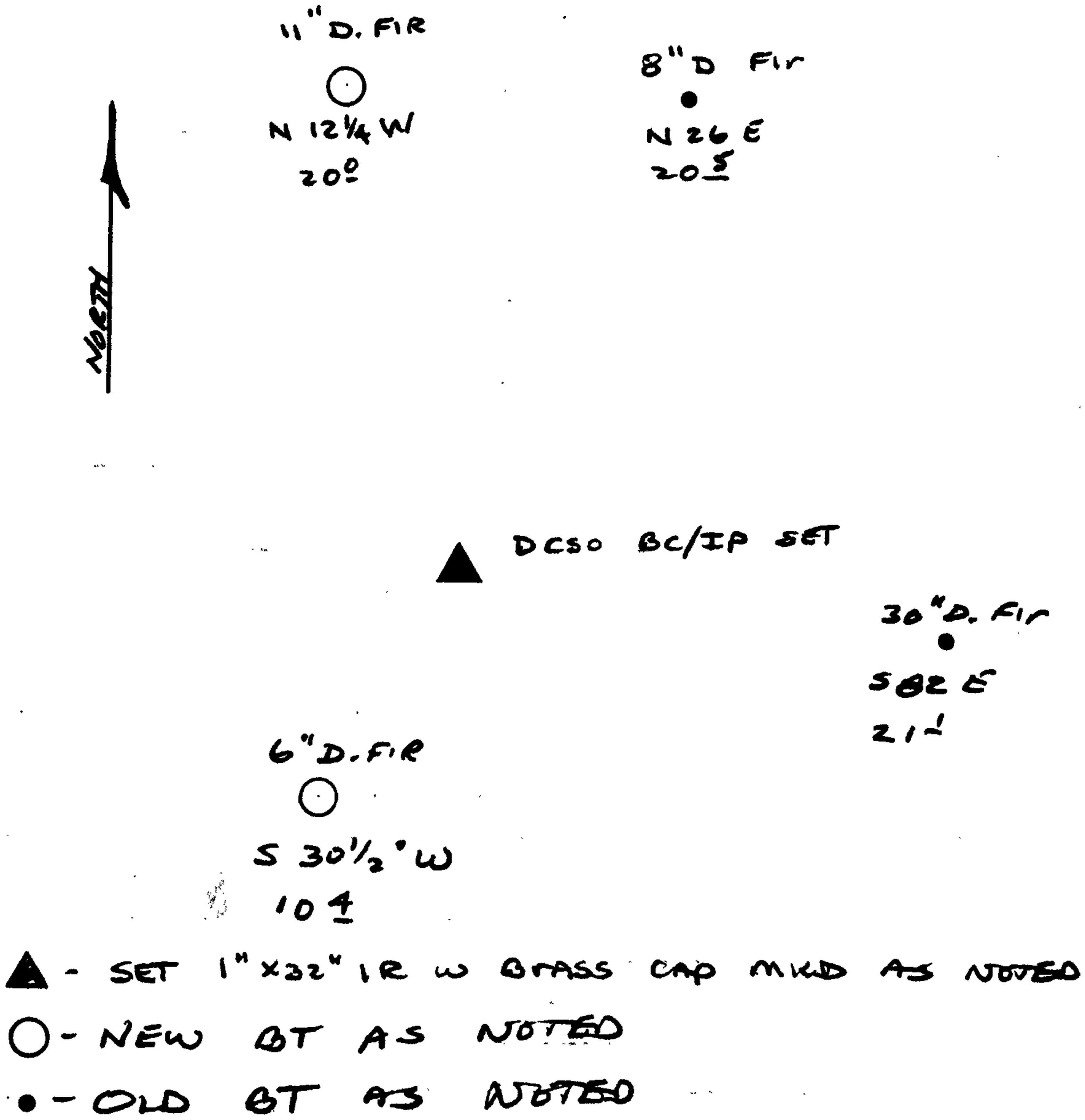

Location & Comments

CORNER LIES APPROX 250 FT NORTHERLY OF AN EAST-WEST RIDGE ON A STEEP NORTHEAST SLOPE.

Comp. Declin. 18 1/2° EAST  
Agency DCSO  
Party Chief LARRY E. MONREAN  
Notekeeper " " "  
Witnesses R W SMITH  
S J FLASSIE

Address RM 205 JUSTICE BLDG  
ES B6., OR. 97470

Surveyor's Seal  
REGISTERED PROFESSIONAL LAND SURVEYOR

*Larry E. Monrean*  
OREGON  
JULY 13, 1979  
LARRY E. MONREAN  
#1830