

GOVERNMENT CORNER RESTORATION FORM

Township 25S Range 3W Sec. 22 County DOUGLAS

State OREGON Date OCT. 1, 1986 No. _____

Corner Designation

1/4 S 22
S 27

- _____ Condition Report Only
- _____ Not Found
- Renewed
- _____ Unrecorded
- _____ Surveyed In
- _____ Referenced Out

Previous Renewals 1943 RESURVEY, RENEWAL #74

Monument(s) Found: (Condition and Source)

A 2 1/2 INCH DIAM. BRONZE DISK ON
A 1 INCH DIAM. IRON PIPE, FIRMLY SET AND
PROTRUDING APPROX. 8 INCHES FROM GROUND.
MONUMENT IS IN A ROUGH 2 FT DIAM. MOUND OF STONE.
CAP MARKED AS AT RIGHT. MONUMENT
IS NOT DISTURBED TO LOOK FOR REMAINS
OF WOODEN STAKE.

U.S. GENERAL LAND OFFICE SURVEY

1/4 S 22
S 27
1943

Accessories Found:

ONE ORIGINAL BEARING TREE IS FOUND. A CEDAR, 36 INS. DIAM, NOW A
FALLEN AND DECAYED 36 INCH DIAMETER CEDAR BEARS N 42° W, 12.5 FEET DIST.
(AS PER RENEWAL 1943 RESURVEY AND RENEWAL # 74, ORIGINAL RECORD
N 35° W, 11 1/2 FT. DIST.) EVIDENCE OF ROTTEN REBLAZED FACE FOUND NO
SCRIBING FOUND. NO EVIDENCE OF ORIGINAL HEMLOCK FOUND.

FROM THE 1943 RESURVEY A FIR 42 INS. DIAM. NOW 54 INCH DIAMETER
1 1/2 FOOT TALL FIR STUMP WITH NO BLAZES OR SCRIBE MARKS FOUND
BEARS S 20° E, 10 1/2 DISTANT (AS PER RECORD)

FROM RENEWAL #74 TWO BEARING TREES. A 9" HEMLOCK NOW
A 10 INCH DBH 7 FOOT TALL HEMLOCK STUMP TIPPED OUT TO NORTH
WITH A PARTIALLY HEALED BLAZE WITH THE SCRIBING 1/4 S 22 CS BT VISIBLE
BEARS N 80° W, 32 1/2 FEET DIST (AS PER RECORD) AT THE ROOT CROWN.
A 9" HEMLOCK NOW A 10 INCH DIAMETER 3 1/2 FOOT TALL HEMLOCK STUMP WITH
A PARTIALLY HEALED BLAZE WITH THE SCRIBING 1/4 S 27 CS BT VISIBLE
BEARS S 50° E, 26 1/2 FEET DISTANT (AS PER RECORD).

#1424

RENEWAL

Monument Set (Procedure and Description)

Monument Detail

MONUMENT POSITION ACCEPTED AS BEING THAT WHICH WAS ESTABLISHED IN THE 1943 RE-SURVEY FROM EVIDENCE OF THE ORIGINAL WOODEN POST.

N/A

New Accessories

A 6 INCH DBH HEMLOCK SCRIBED 1/4 S22 CS 1ST ON A DOUBLE BLAZE BEARS N13°E, 24.3 FEET DISTANT.

A 14 INCH DBH HEMLOCK SCRIBED 1/4 S22 CS 1ST ON A DOUBLE BLAZE BEARS N63°W, 46.5 FEET DISTANT.

Sketch of Monument, Accessories, and General Area

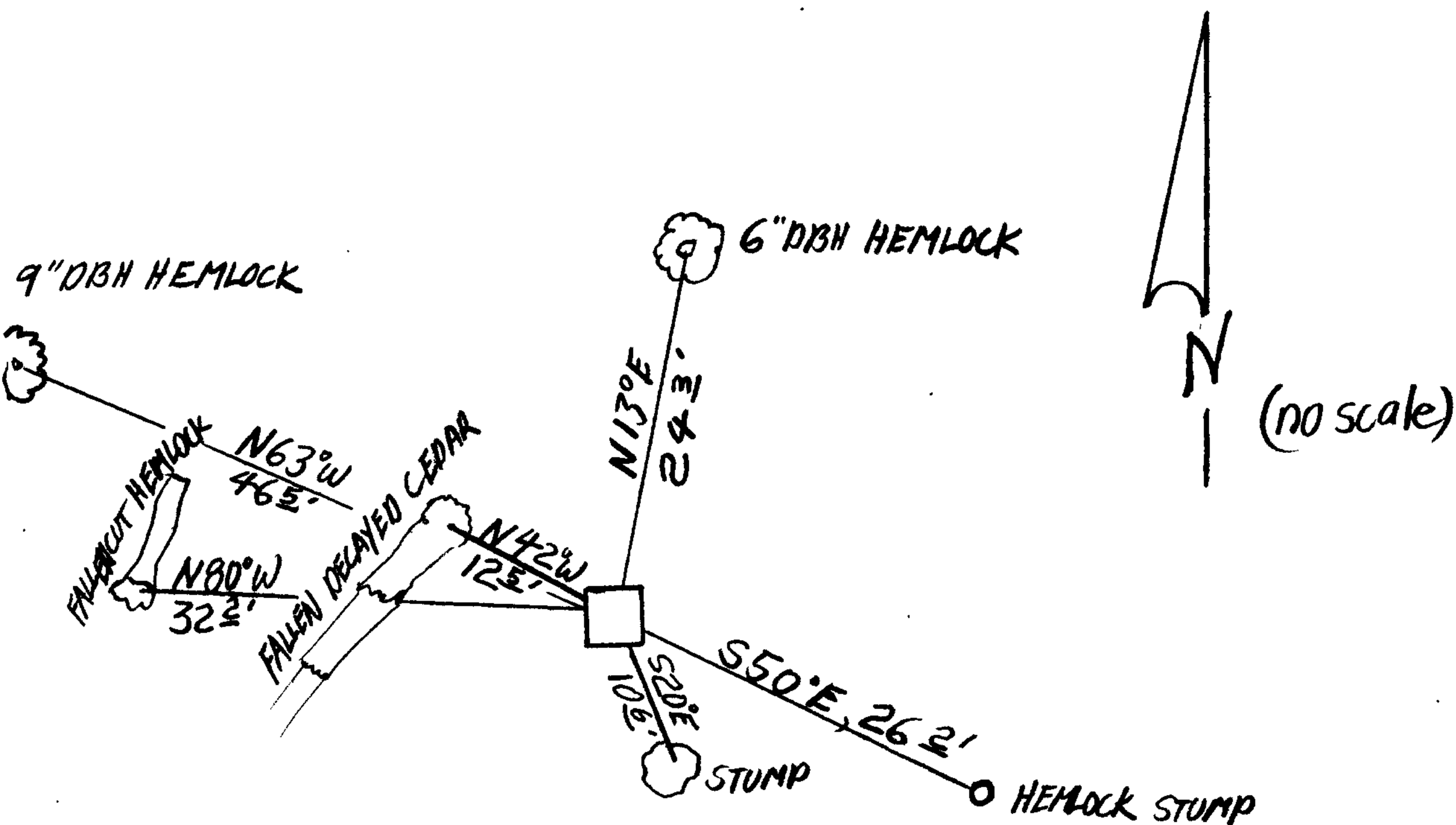

Location & Comments

MONUMENT IS AT NORTH EDGE OF RECENT CLEARCUT AND AT SOUTH BOUNDARY OF WELL ESTABLISHED REPROD. UNIT. MONUMENT IS APPROXIMATELY 500 FEET NORTH OF BLM ROAD # 25-3-27.

Comp. Declin. 18 1/2° E
Agency DCSO
Party Chief STEPHEN FLAUSE
Notekeeper RANDY SMITH
Witnesses Stephen John Flause

Address Rm 205 JUSTICE BLDG
RSBG, OR. 97410

Surveyor's Seal

REGISTERED
PROFESSIONAL
LAND SURVEYOR

Larry E. Monrean

OREGON
JULY 13, 1979
LARRY E. MONREAN
#1830