

GOVERNMENT CORNER RESTORATION FORM

Township 26S Range 5W Sec. 16 County DOUGLAS

State OR Date 3/28/86 No. \_\_\_\_\_

Corner Designation

S17	S16
S20	S21

Condition Report Only  
 \_\_\_\_\_ Not Found  
 Renewed  
 \_\_\_\_\_ Unrecorded  
 \_\_\_\_\_ Surveyed In  
 \_\_\_\_\_ Referenced Out

Previous Renewals #17, #129

Monument(s) Found: (Condition and Source)  
A DCSD DISK ON AN I.P. PROTRUDING  
15 IN. ABOVE GROUND (PER REN #129).

A BROKEN UP SANDSTONE ROCK WITH  
A FAINT CROSS VISIBLE, SCATTERED  
ON TOP OF GROUND ALONG NORTH  
EDGE OF I.P. (PER REN #17).

STONE MEASURES 16 X 9 X 8 WHEN  
PUT BACK TOGETHER (REC. 6 X 9 X 12  
PER REN #17).

MEASUREMENTS TO BEARING TREES  
TAKEN FROM DCSD DISK / I.P.  
PER REN # 129

Accessories Found:

COUNTY SURVEYORS OFFICE  
 T26S  
 S17/S16  
 S20/S21  
 R5W  
 1964

20" NOW 18" DIA. W. OAK WE OPENED FACE AND FOUND SCRIBING  
"N S 17" BEARS N 77 1/2° W, 18.7 FT (REC. N 85° W, 15.8 FT) ORIG. BT.

16" NOW 14" DIA. 3 FT HIGH ROTTED OUT STUMP, EVIDENCE OF  
BURL POSSIBLE LOWER BLAZE. NO SCRIBING FOUND. BEARS  
S 51 1/2° E, 31.3 FT (REC. S 51° E 33.7 FT), ORIG. BT.

POSSIBLE DEPRESSION OF STUMP FOR NE ORIG. BT. FOUND  
NO EVIDENCE OF ORIG. SW BT FOUND

11" NOW 14" DIA. W. OAK WITH A FULLY HEALED DOUBLE BLAZE  
BEARS N 75° E, 14.8 FT (AGREES WITH REC.) PER REN #129

7" NOW 9" DIA. W. OAK WITH A FULLY HEALED DOUBLE BLAZE  
BEARS N 18° W, 25.9 FT (AGREES WITH REC.) PER REN #129

9" NOW 11" DIA. W. OAK WITH A FULLY HEALED DOUBLE BLAZE  
BEARS S 3 1/2° W, 31.5 FT (AGREES WITH REC.) PER REN #129

7" NOW 9" DIA. W. OAK WITH A FULLY HEALED DOUBLE BLAZE  
BEARS S 17° E, 40.5 FT. (AGREES WITH REC.) PER REN #129

#156 4

C.S. File No. 62/34-2c

RENEWAL

Monument Set (Procedure and Description)

POSITION OF BC/I.P. AND SCATTERED SANDSTONE NOT ACCEPTED AS CORNER LOCATION ORIG. EVIDENCE FITS WELL WITH A POSITION N 83° W, 2.7 AT FORM BC/I.P. PER REN #129

DISK SAILED OFF I.P. PER REN #129 1 1/4" I.D. I.P. PROTRUDES 5 IN ABOVE GROUND, STONE LEFT ALONG NORTH EDGE OF I.P.

A DCSD DISK ON AN I.P. PROTRUDES 6 IN. ABOVE GROUND.

MEASUREMENTS TAKEN FROM NEW DCSD BC/I.P.

Monument Detail

DOUGLAS COUNTY SURVEYORS OFFICE  
 T 265  
 R 5W  
 S 17 | S 16  
 S 20 | S 21  
 1986

Accessories

20" NW 28" W. OAK OPENED SCRIBING FOUND "W 517" BEARS N 85° W, 16.8' (REC. N 85° W, 15.8' TO FACE) ORIG. BT

14" NW 29" W. OAK 3' HIGH ROTTED STUMP BEARS S 51° E, 34.3' (REC. S 51° E, 33.7' TO FACE) ORIG. BT

1 1/4" I.D. I.P. PROTRUDING 5 IN ABOVE GROUND BEARS S 43° E, 2.7' PER REN #129

12" NW 14" W. OAK WITH A FULLY HEALED DOUBLE BLAZE BEARS N 35° E, 13.5' (REC. N 25° E, 14.8') PER REN #129

7" NW 9" W. OAK WITH A FULLY HEALED DOUBLE BLAZE BEARS N 16 1/2° W, 23.2' (REC. N 18° W, 25.2') PER REN #129

9" NW 9" W. OAK WITH A FULLY HEALED DOUBLE BLAZE BEARS S 17 1/2° E, 43.2' (REC. S 15° E, 41.5') PER REN #129

9" NW 11" W. OAK WITH A FULLY HEALED DOUBLE BLAZE BEARS S 1 1/2° W, 33.7' (REC. S 3 1/2° W, 31.5') PER REN #129

Sketch of Monument, Accessories, and General Area

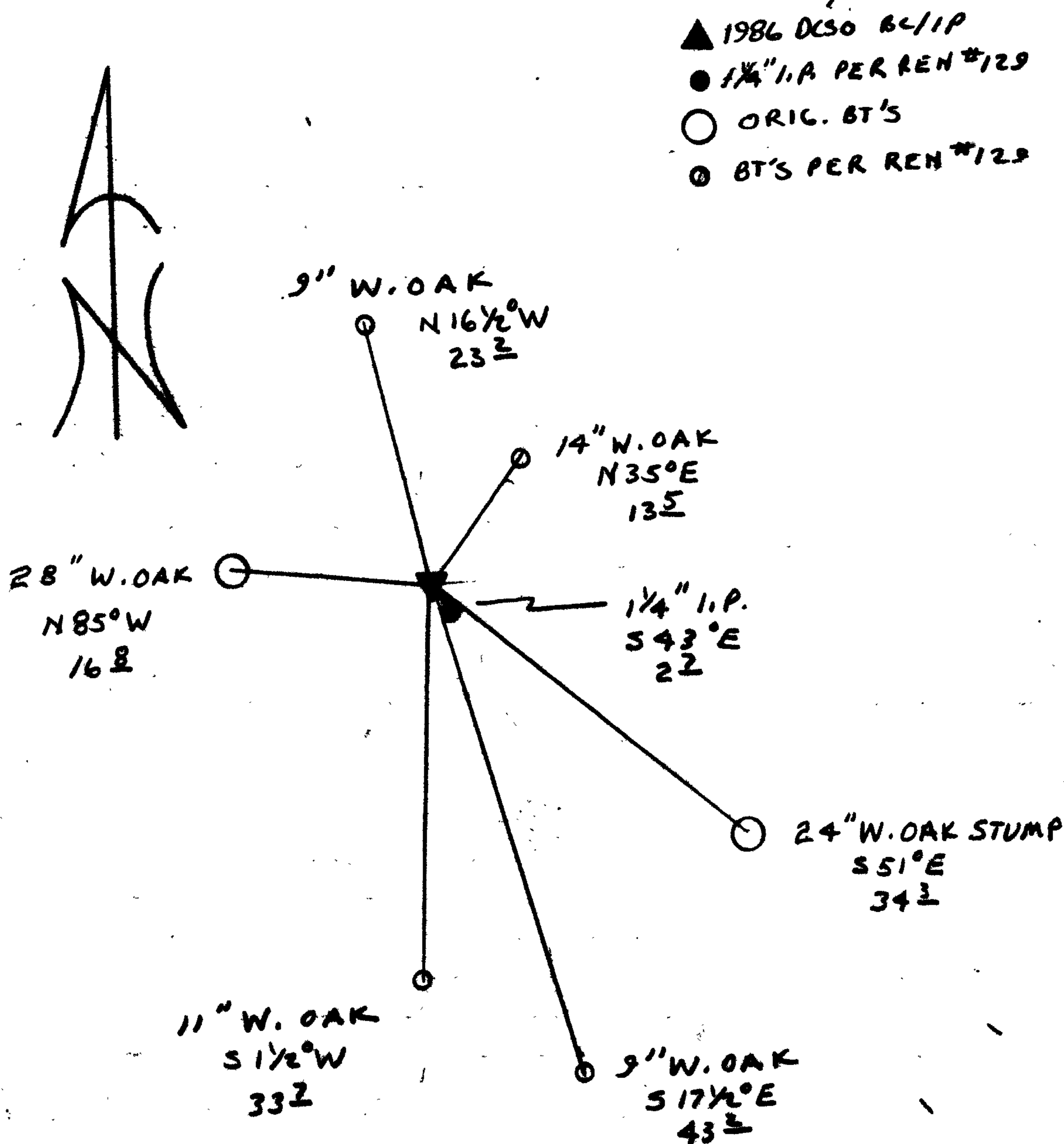

Location & Comments

CORNER LIES ON THE NORTHEAST  
 SIDE OF A KNOWL.

1974 STATE PLANE COORDINATES  
 APPLY TO 1964 I.P. CORNER POSITION  
 ONLY.

Comp. Declin. 18 1/2° E  
 Agency DCSD  
 Party Chief LARRY E. MONREAN  
 Notekeeper RANDALL W. SMITH  
 Witnesses STEPHEN J. FLAUSE

Address

Surveyor's Seal

REGISTERED  
 PROFESSIONAL  
 LAND SURVEYOR

*Larry E. Monrean*

OREGON  
 JULY 13, 1979  
 LARRY E. MONREAN  
 #1830