

GOVERNMENT CORNER RESTORATION FORM

Township 26S Range 1W Sec. 5 County DOUGLAS

State OR Date 1/15/86 No. _____

Corner Designation

56	55
57	58

- Condition Report Only
- Not Found
- Renewed
- Unrecorded
- Surveyed In
- Referenced Out

Previous Renewals #47

MONUMENT DETAIL

Monument(s) Found: (Condition and Source)

A DCSO BC/I.P. PROTRUDING
 18 IN. ABOVE GROUND. AND
 A 15X8X7" STONE WITH 5 MARKS
 FOUND ON ONE EDGE. (REC. 18X8X7"
 STONE WITH 5 MARKS ON SOUTH
 AND EAST EDGES ORIG. AND AN "X"
 ON TOP FOUND PER REN#47) LAYS ALONG
 NORTHEAST EDGE OF I.P.

COUNTY SURVEYORS OFFICE
T26S

56	55
57	58
RIW 1970	

Accessories Found:

ORIG. BT'S

6" NOW 10" DIA. 3 1/2 FT HIGH ROTTED D.FIR STUMP SCRIBING FOUND
 IN PREVIOUSLY OPENED BLAZE " / 5" BEARS N 33° E, 57.7 FT
 (REC N 33° E, 57.4 FT DIST. TO FACE OF BLAZE).
 40" NOW 67" DIA. D.FIR WITH A FULLY HEALED SINGLE BLAZE
 BEARS S 53° E, 83.2 FT (AGREES WITH REC.).
 18" NOW 26" DIA. D.FIR WITH A FULLY HEALED SINGLE BLAZE
 BEARS S 6° W, 71.3 FT (REC S 4 1/2° W, 71.3 FT).
 NO EVIDENCE OF NW BT FOUND.

REN #47 BT'S

18" NOW 17" DIA. 40 FT HIGH D.FIR SNAG WITH A PARTIALLY HEALED SINGLE
 BLAZE SCRIBING VISIBLE "T26S RIW 56 (S BT" BEARS N 42° W, 19.3 FT
 (AGREES WITH REC.).
 12" NOW 13" DIA. D.FIR WITH A FULLY HEALED SINGLE BLAZE
 BEARS N 17° E, 13.2 FT. (AGREES WITH REC.).
 14" NOW 12" DIA. D.FIR WITH A FULLY HEALED SINGLE BLAZE
 BEARS S 67° E, 6.6 FT. (AGREES WITH REC.).
 6" NOW 6" DIA. DEAD D.FIR WITH A FULLY HEALED SINGLE BLAZE
 BEARS S 20° W, 18.7 FT (AGREES WITH REC.).

#111 X

RENEWAL

Monument Set (Procedure and Description)

Monument Detail

NONE

N/A

New Accessories

10" DIA. D. FIR DOUBLE BLAZED AND SCRIBED " T265 RIW S6CS BT"
BEARS N 9° W 49.0 FT.

Sketch of Monument, Accessories, and General Area

Location & Comments

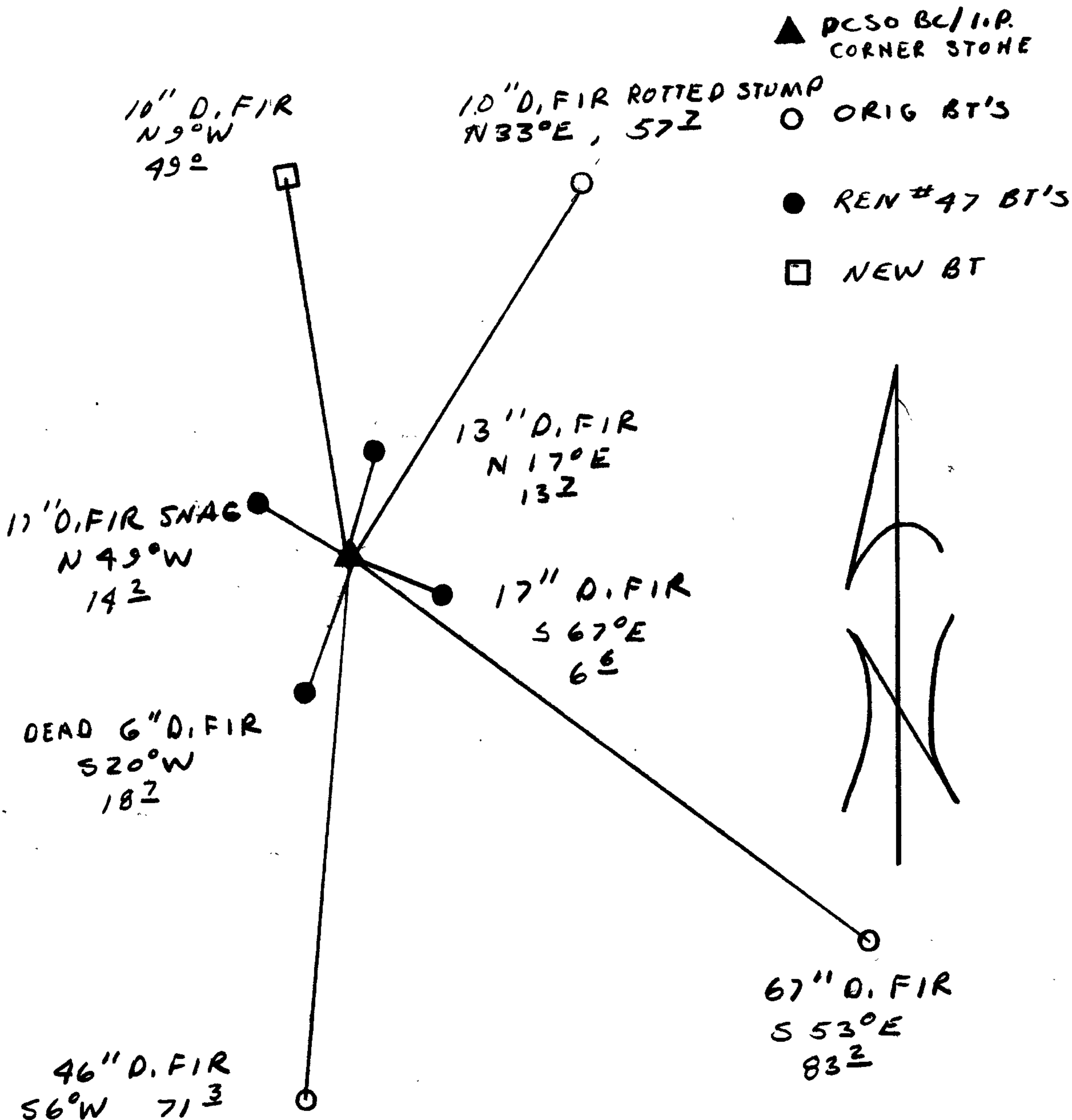

CORNER LIES ON LEVEL GROUND

Comp. Declin. 18 1/2° E
Agency DCSO
Party Chief RANDALL W. SMITH
Notekeeper STEPHEN J. FLAUSE
Witnesses

Surveyor's Seal

REGISTERED
PROFESSIONAL
LAND SURVEYOR

Larry E. Monrean

OREGON
JULY 13, 1979
LARRY E. MONREAN
#1830