

GOVERNMENT CORNER RESTORATION FORM

Township 23 S Range 7 W Sec. 2 County DOUGLAS

State OR Date 2-7-86 No. _____

Corner Designation

WEST 1/4 S 2 ONLY

- Condition Report Only
- Not Found
- Renewed
- Unrecorded
- Surveyed In
- Referenced Out

Previous Renewals # 73 & 136

Monument(s) Found: (Condition and Source)

FOUND IRON PIPE ^{WITH ATTACHED} AND BRASS CAP
MONUMENT FIRMLY SET AS NOTED IN
RENEWAL #136 AND MARKED

ALSO FOUND 1" DIAM. IRON PIPE REFERRED
TO BY HAINES AS N 86° W 64 2 FT.

MONUMENT DETAIL

COUNTY SURVEYORS OFFICE
T 23 S
1/4 1/2
R 7 W
1966

Accessories Found:

ORIGINAL BT

A 12" FIR NOW A SHATTERED FIR STUMP 36" DIAM WITH FRAGMENTARY SCRIBING
VISIBLE ON GLAZE BEARS N 11° E 8 1/2 FEET.

POSSIBLE ORIGINAL BT, RECORDED PER RENEWAL NO. 73 AS 18" FIR
S 25° E, 31.7 FEET IS DEAD AND DOWN, OUT OF POSITION AND PARTIALLY
DELETED. WE FIND SCRIBING POSSIBLE "S" "C" "B" (SEE PHOTOS) ALONG
WITH OLD AXE NOTCH IN OLD GLAZE.

RECORD ORIGINAL BT "10 INCH FIR N 72° W 124 LKS" NOT FOUND

BEARING TREES PER TRACY 1966 RENEWAL #136

7" W FIR S 20 E 7 3/4 FEET IS DEAD AND DOWN

7" D FIR NOW AN 8" DIAM. SNAG BEARS N 21° E 25 3/4 FEET

RENEWAL

Monument Set (Procedure and Description)

NONE

Monument Detail

N/A

New Accessories

8" DIAM. D. FIR DOUBLE BLAZED & SCRIBED "1/4 S2 CS BT" BEARS S 62 1/2° E 34 1/2 FT.
6" DIAM. D. FIR DOUBLE BLAZED & SCRIBED "1/4 S2 CS BT" BEARS S 35° E 48 3/4 FT.
13" DIAM. D. FIR DOUBLE BLAZED & SCRIBED "1/4 S2 CS AT" BEARS N 56° E 47 1/4 FT.

Sketch of Monument, Accessories, and General Area

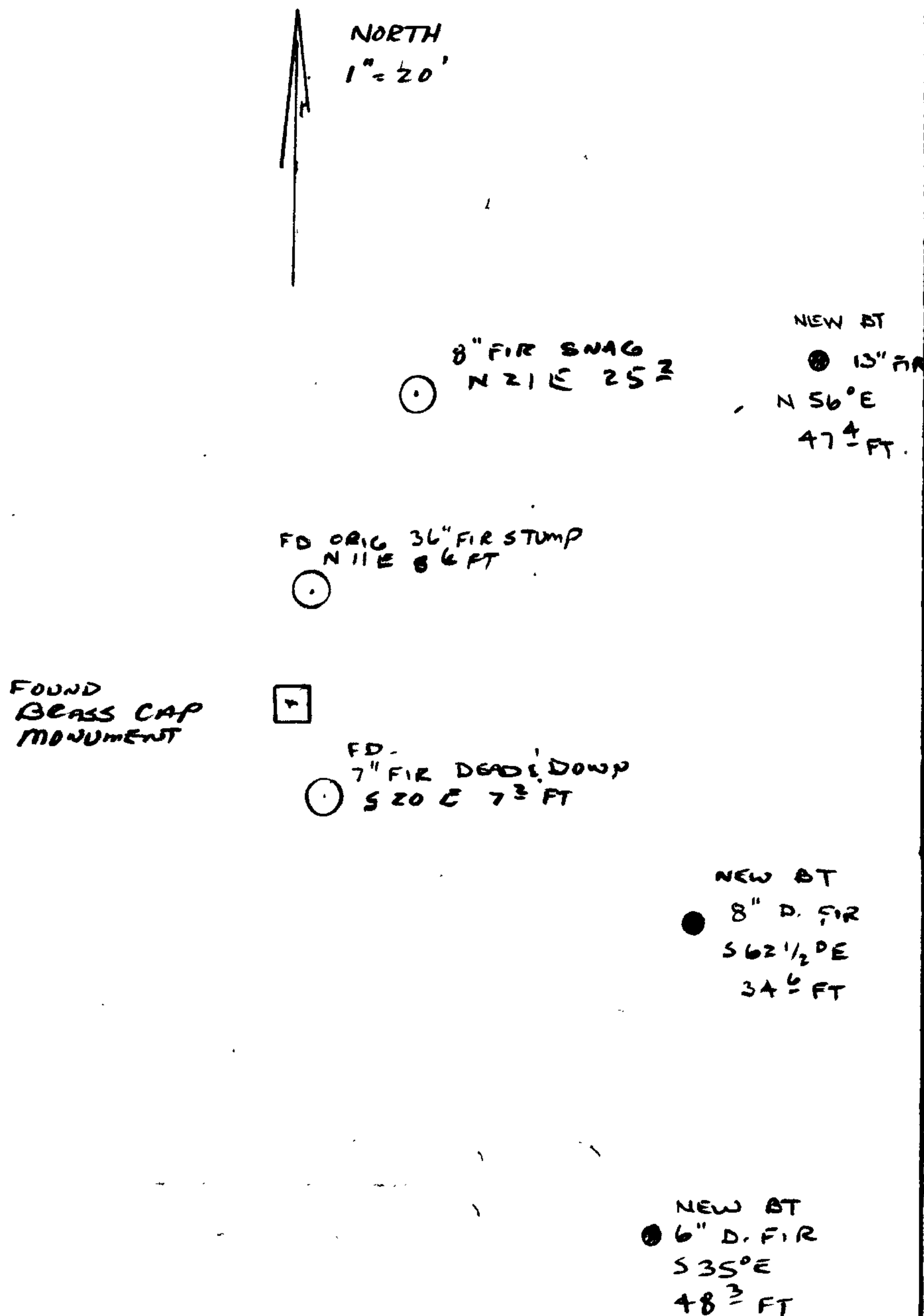

Location & Comments

Comp. Declin. _____
Agency _____
Party Chief _____
Notekeeper _____
Witnesses _____

Address _____

Surveyor's Seal

REGISTERED
PROFESSIONAL
LAND SURVEYOR

Larry E. Monrean

OREGON
JULY 13, 1979
LARRY E. MONREAN
#1830