

CERTIFIED RECORD OF LAND CORNER MONUMENTATION

History of original corner establishment:

THIS CORNER WAS SET BY THE COUNTY SURVEYOR'S OFFICE IN 1968.

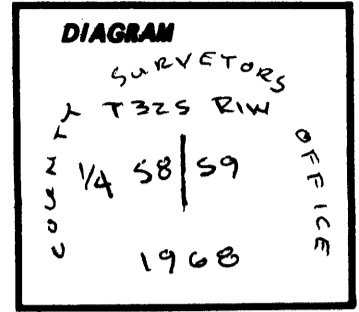

FILED

[Signature]
DEC 31 1986

COUNTY SURVEYOR
DOUGLAS COUNTY, ORE.

Description of corner evidence found:

- Found A 1" IRON PIPE WITH A 2 1/2" BRASS CAP IN ROCK MOUND.
- Found FIR SMAG (DOWN) WHICH BEARS N 50° E 3.1' (REC = 2.6')
- Found 28" FIR WHICH BEARS N 81° E 35.8', SCAR VISIBLE.
- Found FIR STUMP WHICH BEARS S 54° W 35.1'
- Found FIR STUMP WHICH BEARS S 89° W 6.6' (REC = 4.6')

Description of monument and accessories I established to perpetuate the original location of this corner:

I MARKED A 28" FIR WHICH BEARS N 37° W 3.1',
SCRIBED 1/4 S 8 BT WITH LS WASHER NO 944 NAILED
TO BT SCRIBE.

DATE: Nov., 1986

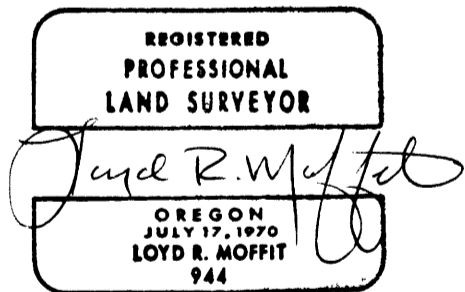

Office of..... Surveyor..... County of..... Douglas.....
 State of..... Oregon....., I hereby certify that the within instrument was filed in this office
 for record on the... 31... day of... December....., 19... 86
 Fritz Ingram..... by *[Signature]*.....
 (COUNTY OFFICIAL)..... (DEPUTY)

102 ✓