

CERTIFIED RECORD OF LAND CORNER MONUMENTATION

History of original corner establishment:

THIS CORNER WAS SET IN 1966
BY THE COUNTY SURVEYOR'S OFFICE.

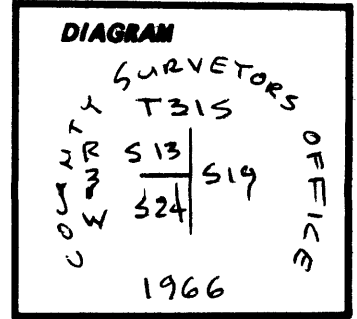

FILED

[Handwritten signature]

DEC 31 1986

COUNTY SURVEYOR
DOUGLAS COUNTY, ORE.

Description of corner evidence found:

- Found 1" PIPE WITH 2 1/2" BRASS CAP
- Found 60" PINE (DEAD) S 41 1/2° W 16.5' (REL. = S 44° W 15.7') SCAR VISIBLE.
- Found 8" MADRONE N 66° W 27.1' (REL. = N 64° W 27.0') SCRIBE VISIBLE.
- Found 26" FIR N 71 1/2° E 16.5' (REL. = N 70° 06' E 15.9') SCAR VISIBLE.
- Found HEMLOCK (DOWN) S 32° 22' E 34.7'
- Found 9" MADRONE S 29° E 18.6' (REL. = S 28° 23' E) ROTTED FACE.

Description of monument and accessories I established to perpetuate the original location of this corner:

I MARKED A 6" FIR WHICH BEARS S 84° W
12.2', SCRIBED T315 R3W S24 BT, WITH
LS WASHER NO. 944 NAILED TO BT SCRIBE.

DATE: Nov., 1986.

REGISTERED
PROFESSIONAL
LAND SURVEYOR

Lloyd R. Moffit
OREGON
JULY 17, 1970
LOYD R. MOFFIT
944

Office of..... Surveyor..... County of..... Douglas.....

State of..... Oregon....., I hereby certify that the within instrument was filed in this office
for record on the..... 31 day of..... December..... 19 86

..... Fritz Ingram..... by *Virginia A. Ferguson*
(COUNTY OFFICIAL) (DEPUTY)

Form R6-7100-57 (9/71)

★ GPO—798-276

#228 T31-2
#255 T31-3

U.S. FILE NO. 62/30-21c