

CERTIFIED RECORD OF LAND CORNER MONUMENTATION

History of original corner establishment:

THIS CORNER WAS SET IN 1968 BY THE COUNTY SURVEYOR'S OFFICE.

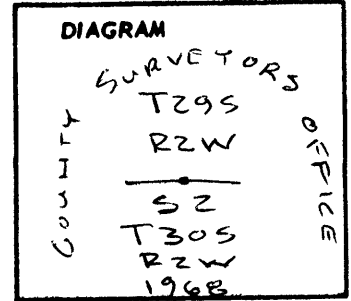

FILED

[Signature]

NOV 14 1986

COUNTY SURVEYOR
DOUGLAS COUNTY, ORE

Description of corner evidence found:

Found A 2 1/2" BRASS CAP ON A 1" IRON PIPE IN A ROCK MOUND.

Description of monument and accessories I established to perpetuate the original location of this corner

HEMLOCK
Found A 16" ~~FIR~~ WHICH BEARS S22°E 15.8', SCAR VISIBLE.

Found A FIR STUMP WHICH BEARS S84°E 34.4', SCRIBE VISIBLE.

I SCRIBED A 6" FIR WHICH BEARS S41 1/4°E 35.2',
MARKED 1/4 S2 BT WITH L.S. ⁹⁴⁴ BRASS WASHER NAILED TO BT SCRIBE.

DATE: OCT., 1986

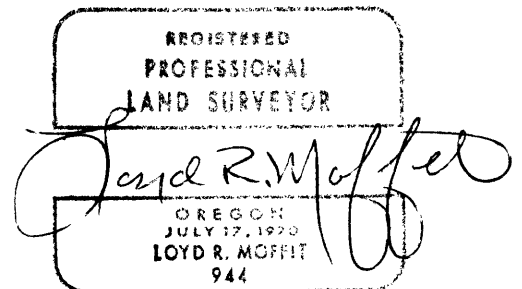

Office of Surveyor County of Douglas
 State of Oregon, I hereby certify that the within instrument was filed in this office
 for record on the 14 day of November, 1986
Fritz Ingram by [Signature]
 (COUNTY OFFICIAL) (DEPUTY)

#271 T30-2 X
 #122 T.29-2 X
 Form R6-7100-57 (9/71)