

GOVERNMENT CORNER RESTORATION FORM

Township 30 S Range 1 W Sec. 27 County DOUGLAS

State OREGON Date 9-20-85 No. \_\_\_\_\_

Corner Designation

1/4 S 27  
S 34

- \_\_\_\_\_ Condition Report Only
- \_\_\_\_\_ Not Found
- Renewed
- \_\_\_\_\_ Unrecorded
- \_\_\_\_\_ Surveyed In
- \_\_\_\_\_ Referenced Out

Previous Renewals SURVEY M 69-4

MONUMENT DETAIL

Monument(s) Found: (Condition and Source)  
ORIGINAL POST NOT FOUND.

FOUND IRON PIPE AND BRASS CAP SET AT PROPORTIONED POSITION (M 69-4) FIRMLY SET IN MOUND OF STONE AND MARKED.

T 30 S R 1 W

1/4 S 27  
S 34

RLS 866  
1978

Accessories Found:

M 69-4 BT 5:

A 10" FIR WITH PARTIALLY HEALED DOUBLE BLAZE BEARS N 61 1/2° W 80 ± FEET (REC. N 64° W 80 ± FT) FROM THE FOUND MONUMENT

A 9" FIR NOW AN 11" D. FIR WITH PARTIALLY HEALED DOUBLE BLAZE BEARS S 45° W 127 ± FEET (REC. S 42° 42' W 128 ± FT) FROM THE FOUND MONUMENT.

ALSO FOUND (NOT NOTED PER. M 69-4) ORIGINAL 8" DIAM. FIR NOW A PARTIALLY DECAYED FIR STUMP APPROX. 18" DIAM. 24" HIGH. STUMP HAS PREVIOUSLY OPENED BLAZE WITH SCRIBING VISIBLE "1/4 S". WE OPEN LOWER BLAZE AND FIND SCRIBING "BT". WE COUNT 110 GROWTH RINGS FROM BLAZE TO THE BARK OF DECAYED STUMP. RECORD BEARING AND DISTANCE TO ORIGINAL CORNER IS N 88° W 33.0 FEET. SEE PHOTOS

#229 X

C.S. File No. 62/29-22

RENEWAL

Monument Set (Procedure and Description)

AT RECORD BEARING AND DISTANCE FROM THE FOUND ORIGINAL BT AS NOTED WE SET A 1" X 30" GALV. IRON PIPE WITH BRASS CAP ATTACHED MARKED AS NOTED. MONUMENT SET IN STONE MOUND APPROX. 2' ACROSS BASE AND 2' HIGH

THE PROPORTIONED POSITION MONUMENT PER M 69-4 BEARS N 36 1/2° W 22.9 FEET.

Monument Detail

DOUGLAS COUNTY SURVEYOR  
 T 30 S  
 1/4 527  
 534  
 R 1 W  
 1985

New Accessories

NEW TIES TO BT'S MARKED FROM M 69-4  
 (NW 10" FIR) 10" FIR WITH PARTIALLY HEALED BLAZE BEARS N 56° W 101 1/2 FEET  
 (SW 9" W FIR) 11" D. FIR WITH PARTIALLY HEALED BLAZE BEARS S 55 1/2° W 126 1/2 FEET

NEW BT'S.  
 30" D. FIR DOUBLE BLAZED AND SCRIBED "1/4 527 CS BT" BEARS N 14° W 27 1/2 FEET.  
 8" MADRONE BARK SCRIBED "1/4 534 CS BT" BEARS S 1 1/2° W 28 1/2 FEET.

Sketch of Monument, Accessories, and General Area

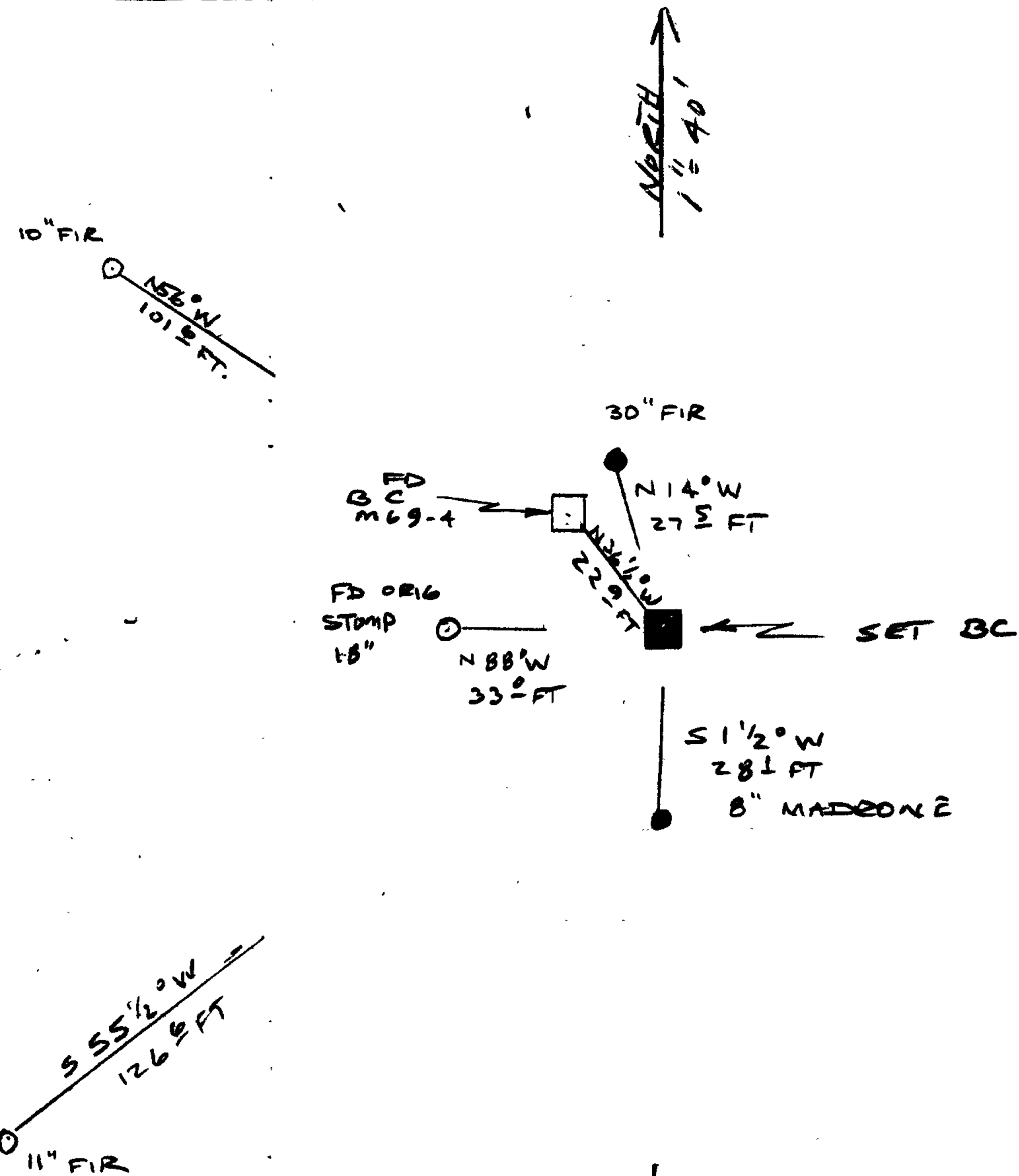

Location & Comments

Comp. Declin. 18 1/2° EAST  
 Agency DOUGLAS COUNTY SURVEYOR'S OFFICE  
 Party Chief LARRY E. MONREAN  
 Notekeeper Janey E. Monrean  
 Witnesses S. J. FLAUSE

Surveyor's Seal

REGISTERED  
 PROFESSIONAL  
 LAND SURVEYOR

*Janey E. Monrean*

OREGON  
 JULY 13, 1979  
 LARRY E. MONREAN  
 #1830

Rm. 205 - JUSTICE HALL  
ROSEBURG, OR 97470

DOUGLAS COUNTY SURVEYOR

PH. 440-4272

CORNER RENEWAL REQUEST

Section 27 Twp. 30S Rge. 1W

Date SEPT. 18 1985

Condition of Corner and Accessories: FOUND ORIGINAL BT STUMP :  
AN 18" D. FIR STUMP (REC.: PINE, 6") WITH HEALED DOUBLE BLAZE. I  
OPEN UPPER BLAZE AND FIND SCRIBE MARKS "4 S" AT 6" DIAMETER. BLAZE  
IS FACING FOR S76°W BT. (REC: S60°W, 12 LKS [79 FT.]). BRASS CAP SET  
IN 1978 BY PROPORTION (RENEWAL # 162) IS APPROXIMATELY N49°E, 25 FT.  
(CAP OUT OF POSITION ABOUT 17 FT.). OTHER ORIGINAL BT. (FIR, 8", N88°W,  
50 LKS) NOT FOUND, BUT MAY STILL BE THERE AS I DIDN'T HAVE THE  
ORIGINAL SURVEY NOTES WITH ME.

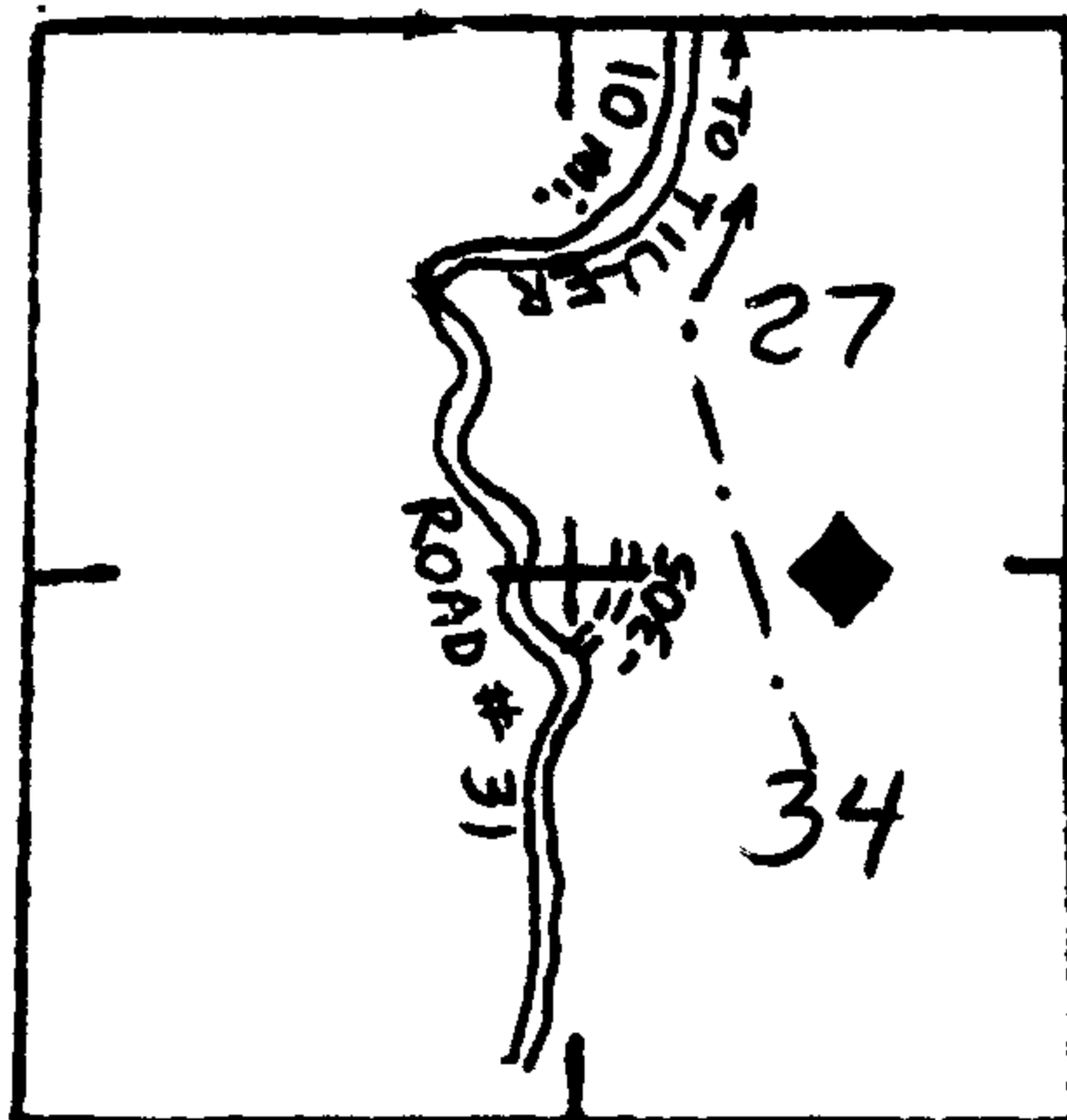

TO REACH: (Please show approximate distances, clearcuts, roads, fences, etc.) FROM THE JUNCTION OF  
FOREST ROADS # 31 AND # 3100-305, DRIVE NORTH ON ROAD # 3100-305 450 FT.  
TO THE SECTION LINE OF SECTIONS 27 & 34. THENCE WALK EAST ONE HALF MILE TO  
1/4 CORNER. CORNER IS ACROSS BEAVER CREEK WHICH MAY BE IMPASSABLE IN THE WINTER. TRAIL  
BRIDGE NEAR C 1/4 S34 IS WASHED OUT.

Notify immediately prior to renewal visit? Yes  No

Notify following renewal visit? Yes  No

Is corner in immediate danger of being lost or disturbed? Yes  No

Name LEONARD E. HERZSTEIN

Address 2900 STEWART PARKWAY

ROSEBURG, OR, 97470

Telephone 672-6601 X 439

ADDITIONAL COMMENTS A COPY OF YOUR TYPED RENEWAL IS SUFFICIENT NOTICE  
FOR OUR FOREST.

M69-A

C.S. File No. 162/29

Index No. V-15  
 File No. 30 S R 1 W  
 Merid. WILLAMETTE  
 R.D. TILLER  
 N.F. OREGON

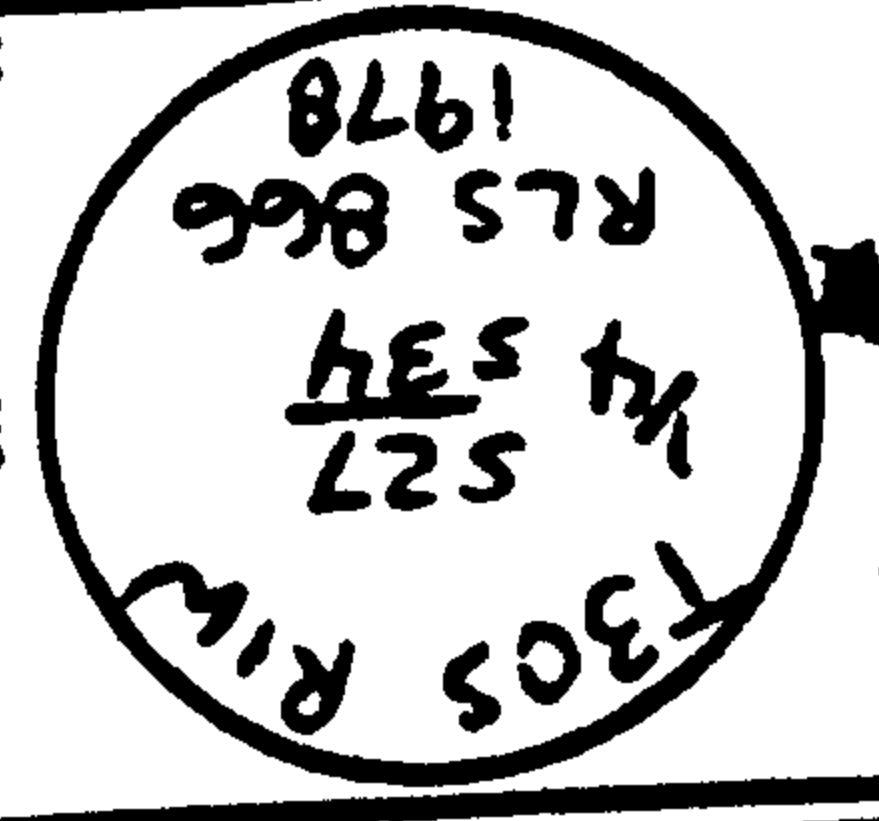

DESCRIBE CORNER MONUMENT FOUND B.C. OUT-OF-POSITION:  
 2 1/2" O.D. IRON PIPE, FAMILY SET, FLUSH WITH  
 3" DIAMETER MOUND OF STONE WITH A BRASS  
 CAP MARKED AS SHOWN. SET BY PROPORTION  
 BY WILLIAM RUPERT, L.S. 866, IN 1978.  
 TRUE CORNER IS 544' W, 17 1/2' FT. FROM B.C.

DESCRIBE BEARING TREES OR OTHER OFFICIAL ACCESSORIES FOUND  
 ORIG. BT: AN 18" D.F.I.R. STUMP, WITH HEALED DOUBLE BUTTE. I  
 OPEN UPPER BUTTE & FIND SCRIBE MARKS "45" @ 6" DIAMETER.  
 BUTTE IS FACING FOR 576' W BT. I LEAVE LOWER BUTTE  
 UNOPENED. ORIG. BEARING & DISTANCE IS 560' W, 12 LKS  
 (72 FT) THIS BT IS APPROX. 549' W, 25 FT. FROM B.C. DID NOT  
 LOCATE OTHER ORIG. BT [N 88° W, 50 LKS (235 FT)] AS I DID NOT HAVE  
 ORIGINAL FIELD NOTES.

DESCRIBE CORNER LOCATION RELATIVE TO NEAR-BY FEATURES, ALSO HOW TO REACH CORNER  
 FOUND 1978 BT: A 12" D.F.I.R., N 64° W, 80 1/2' FT. WITH DOUBLE BUTTE.  
 DID NOT LOCATE OTHER 1978 BT (543° W, 28 1/2' FT.) AS I  
 DID NOT HAVE THE CORNER NOTES.  
 CORNER IS AT EDGE OF OLD CUTTING LINE, RUNNING E-W,  
 ABOUT 300 FT. EAST OF BEAVER CREEK.

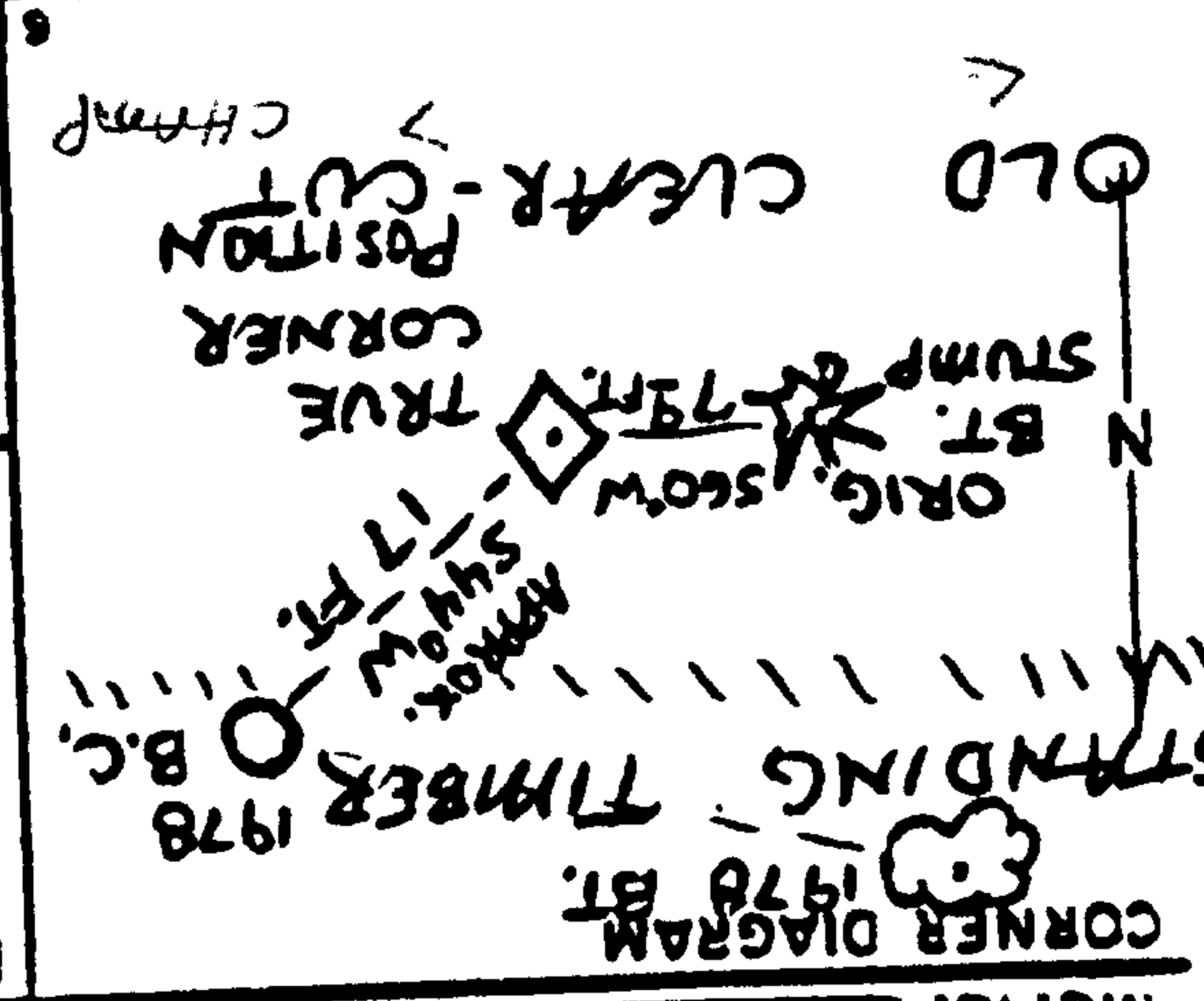

PHOTO IDENTIFICATION DATA  
 Photo No. \_\_\_\_\_  
 Filed At. \_\_\_\_\_  
 Object Ident. \_\_\_\_\_  
 Ident. By \_\_\_\_\_  
 Signature \_\_\_\_\_

PLANE COORDINATE POSITION DATA  
 State \_\_\_\_\_  
 Zone \_\_\_\_\_  
 X \_\_\_\_\_  
 Y \_\_\_\_\_  
 Estab. By \_\_\_\_\_  
 Agency \_\_\_\_\_  
 Signature \_\_\_\_\_

CORNER RECORD (PERPETUATION)  
 MONUMENT: DESCRIBE NEW MONUMENT SET, OR WORK DONE TO PRESERVE EXISTING MONUMENT

Signature LEONARD HERZSTEIN  
 Title SURVEYING TECHNICIAN  
 Division \_\_\_\_\_  
 Headquarters S.O.  
 Date NOV. 13, 1984  
 State Registration No. 7100-52 (3/68)

CORNER RECORD (PERPETUATION)  
 MONUMENT: DESCRIBE NEW MONUMENT SET, OR WORK DONE TO PRESERVE EXISTING MONUMENT

ACCESSORIES: DESCRIBE NEW BT'S WITNESS OBJECTS ETC. ESTABLISHED, OR WORK DONE TO PRESERVE EXISTING EVIDENCE

ATTACHED BT TO THE TO ORIG. STUMP #544 SIGN TO BACKSIDE OF  
 BOTH FOUND BT'S, AND PAINTED BUTTES & 6" RED BAND ON BOTH  
 FOUND BT'S.

Work Done By \_\_\_\_\_  
 Title \_\_\_\_\_  
 Date \_\_\_\_\_  
 State Registration No. \_\_\_\_\_  
 or Agency \_\_\_\_\_  
 Date \_\_\_\_\_  
 Remarks \_\_\_\_\_

THE OTHER ORIGINAL BT (NOW PROBABLY A STUMP) AND  
 THE OTHER 1978 BT, ARE BOTH PROBABLY STILL THERE?  
 WITHOUT THE PROPER NOTES I WAS UNABLE TO LOCATE THEM.

THE NO. 62/29  
 C.S. File No.

