

GOVERNMENT CORNER RESTORATION FORM

Township 32S Range 4W Sec. 4 County DOUGLAS

State OR Date 8/21/85 No. \_\_\_\_\_

Corner Designation

1/4 S5 | S4

- Condition Report Only
- Not Found
- Renewed
- Unrecorded
- Surveyed In
- Referenced Out

Previous Renewals #34, 1959 REMON. OF SUB. COR.

Monument(s) Found: (Condition and Source)

A BLM DISK ON AN I.P.  
PROTRUDES 11 IN. ABOVE GROUND  
MARKED AS NOTED (PER 1959  
REMON. OF SUB. COR.)

1 IN. I.P. (PER REN#34) RESET  
ALONG SIDE BLM I.P. (PER 1959  
REMON. OF SUB. COR.) NOT FOUND  
PROTRUDING ABOVE GROUND. WE DID NOT  
DISTURB GROUND AROUND BLM I.P TO  
LOOK FOR 1 IN. I.P.

Accessories Found:

REN #34  
30" NOW A 41" DIA. 1 1/2 FT. HIGH PONDEROSA PINE STUMP WITH PARTIAL SCRIBED  
VISIBLE "BT", BEARS N 1 1/2° W 91.9 FT (REC. N 2° 50' W, 90.9 FT  
DIST. IS TO FACE OF BLAZE PER REN #34) (REC. N 3° W, 92.7 FT  
DIST. IS IN ERROR PER 1959 REMON. OF PROPORTIONED COR.)

24" NOW A 27" DIA. PONDEROSA PINE WITH A WELL HEALED  
DOUBLE BLAZE, BEARS N 31 1/2° E, 70.2 FT (REC N 33° 13' E, 69.1 FT  
DIST. IS TO FACE OF BLAZE PER REN #34) (REC. N 34 1/4° E, 68.6 FT  
DIST IS TO EDGE OF BARK PER 1959 REMON. OF PROPORTIONED COR.)

MONUMENT DETAIL

US CADASTRAL SURVEY

1/4

S5 | S4

T32S R4W

1959

BUREAU OF LAND MANAGEMENT

#148 X

C.S. File No. 62/29-18

RENEWAL

Monument Set (Procedure and Description)

Monument Detail

NONE

N/A

New Accessories

11" DIA. I. CEDAR DOUBLE BLAZED AND SCRIBED "1/4 S 5 CS BT" BEARS S 52° W, 68 FT.

7" DIA. D. FIR DOUBLE BLAZED AND SCRIBED "1/4 S 5 CS BT" BEARS N 60° W, 65 FT.

9" DIA. P. PINE DOUBLE BLAZED AND SCRIBED "1/4 S 4 CS BT" BEARS S 62 1/2° E, 47 FT.

Sketch of Monument, Accessories, and General Area

41" P. PINE STUMP  
N 1 1/2° W, 91.9'

- BT'S PER REN#34
- NEW BT'S
- ▼ 1959 BLM DISK

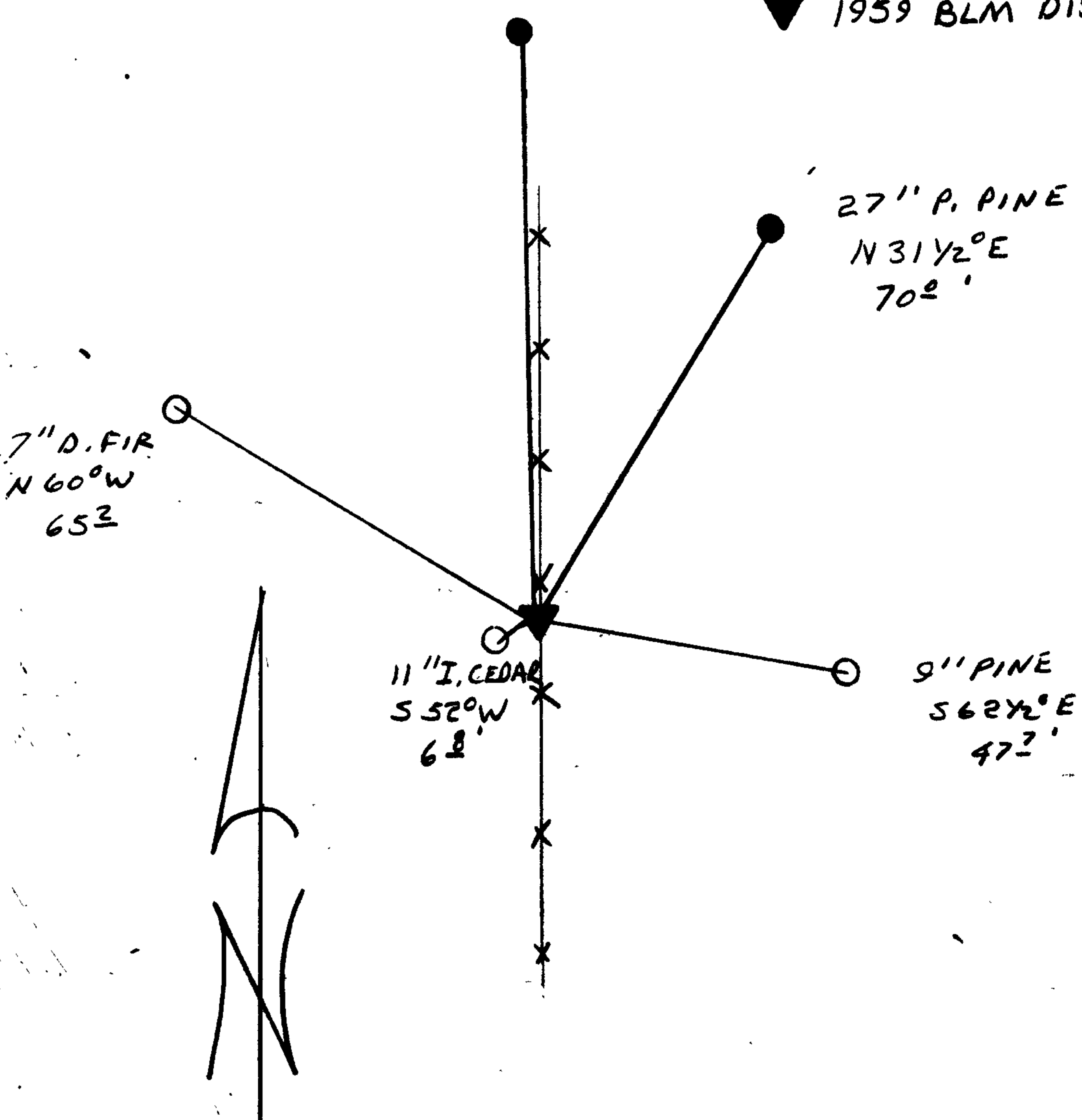

Location & Comments

CORNER LIES IN A N-S FENCE LINE

Comp. Declin. 18 1/2° E  
 Agency DCSO  
 Party Chief RANDALL W SMITH  
 Notekeeper Randall W Smith  
 Witnesses STEPHEN J. FLAUSE

Surveyor's Seal

REGISTERED  
PROFESSIONAL  
LAND SURVEYOR

*Larry E. Monrean*

OREGON  
JULY 13, 1979  
LARRY E. MONREAN  
#1830