

GOVERNMENT CORNER RESTORATION FORM

Township 27 S Range 4 W Sec. 1 County DOUGLAS

State OREGON Date SEPT. 11, 1985 No. _____

Corner Designation

		T	27	S	
R					R
4	S1		S6		3
W	S12		S7		W

- _____ Condition Report Only
- _____ Not Found
- Renewed
- _____ Unrecorded
- _____ Surveyed In
- _____ Referenced Out

Previous Renewals ORIG 1855, REN. #26 1889, 1917 RESURV. 1958 RES. #97 MONUMENT DETAIL

Monument(s) Found: (Condition and Source)

ORIG 1855 POST NOT FOUND
REN. #26 1889 DOES NOT INDICATE SETTING MONUMENT
1917 RESURVY 16X12X4 SANDSTONE NOT FOUND
1958 RESURVY MONUMENT A 2 1/2" X 28" IRON
PIPE SET AT CORNER WAS NOT FOUND.
MR. STAN HENDY (PROPERTY OWNER) PRODUCED
A 3 1/4" DIAM. BRONZE DISK MARKED AS
NOTED. THE DISK WAS FOUND LYING
LOOSE ON THE GROUND SURFACE NEAR
THE AREA WE DETERMINE TO BE THE
CORNER LOCATION.

		T	27	S	
R	4	W			R
					3
					W
	S1		S6		
	S12		S7		
					1958

Accessories Found:

NO ORIGINAL OR REN. #26 BT'S WERE FOUND
(NO BT'S SCRIBED PER ORIGINAL NOTES)

1917 BT. A 28" DIAM. FIR NOW A BADLY DECAYED FIR STUMP
WITH NO SCRIBING FOUND ON OLD BLAZE BEARS N 19° W 40 1/2 FT.
(REC. 40 3/4 FT). SIZE AND CENTER OF STUMP INDETERMINABLE.

FOUND 11" NOW 21" DIAM FIR (1958 RESURVY) WITH WELL HEALED SINGLE
BLAZE BEARS S 50° E 90 1/2 FEET LEVEL TO CENTER (REC. 93 1/2)
BT IS ALIVE AND IN GOOD CONDITION.

BT'S PER RENEWAL # 97

11" NOW 13" W. DAK WITH WELL HEALED BLAZE BEARS S 28 1/2° E 68 1/2 FT.

2" NOW 9"
9" NOW 7" DECAYED FIR STUMP 24 INCHES HIGH WITH SCRIBING "R S6CS BT"
VISIBLE IN PARTIALLY HEALED DOUBLE BLAZE BEARS N 44 1/2° E 162 1/2
FT. (REC N 45 1/2° E 163.2 FEET).

NO OTHER BEARING TREES WERE FOUND.

#150 T27-3 ✓
#145 T27-4 ✓

RENEWAL

Monument Set (Procedure and Description)

AT THE POINT REFERENCED BY BEARINGS & DISTANCES WE SET A 1" X 30" GALV. IRON PIPE WITH BRASS CAP ATTACHED. BRASS CAP IS MARKED AS NOTED AND MONUMENT PROTRUDES 9 INCHES FROM GROUND.

Monument Detail

DOUGLAS COUNTY SURVEYOR
T 27 S

R	S1	S6	R
A			3
W	S12	S7	W

1985

New Accessories

15" DIA. W. OAK DOUBLE BLAZED AND SCRIBED "T27S R4W S6 CS BT" BEARS N47°E 171² FT.

Sketch of Monument, Accessories, and General Area

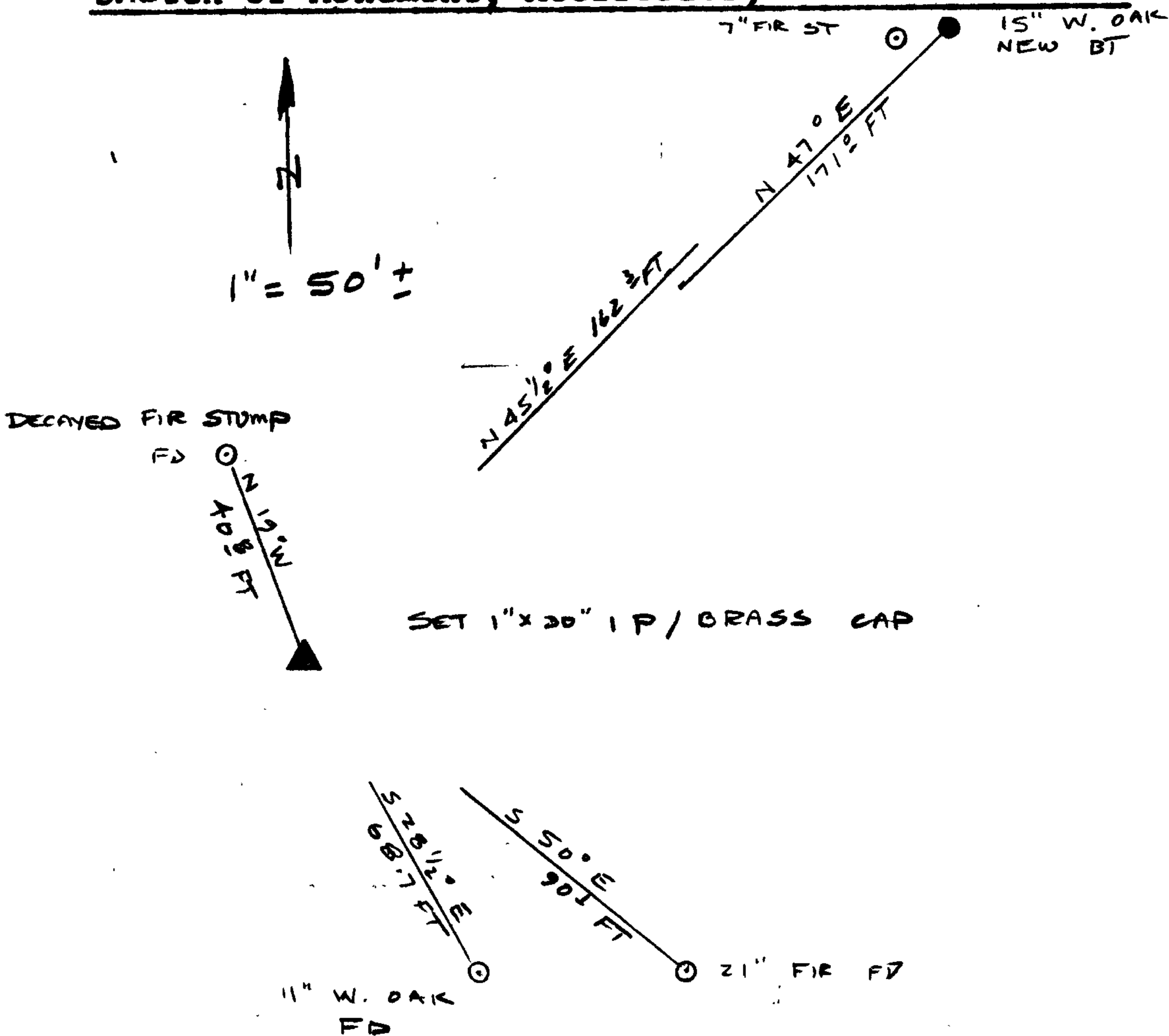

Location & Comments

Comp. Declin. 18 1/2° EAST
 Agency DOUGLAS COUNTY SURVEYOR'S OFFICE
 Party Chief LARRY E. MONREAN
 Notekeeper JERRY T. JAMES
 Witnesses MR. STAN HENDY
R. W. SMITH
S. J. FLAUS

Surveyor's Seal

REGISTERED
PROFESSIONAL
LAND SURVEYOR

Larry E. Monrean

OREGON
JULY 13, 1979
LARRY E. MONREAN
#1830