

GOVERNMENT CORNER RESTORATION FORM

Township 265 Range 3W Sec. 2 County DOUGLAS

State OREGON Date DEC 19, 1985 No. \_\_\_\_\_

Corner Designation

$\frac{1}{4}$   $\frac{S2}{S11}$

- \_\_\_\_\_ Condition Report Only
- \_\_\_\_\_ Not Found
- Renewed
- \_\_\_\_\_ Unrecorded
- \_\_\_\_\_ Surveyed In
- \_\_\_\_\_ Referenced Out

Previous Renewals 200, 205

MONUMENT DETAIL

Monument(s) Found: (Condition and Source)

FROM RENEWAL # 205 BY THE DC SO,  
A DC SO BRASS CAP ON AN IRON PIPE  
MARKED AS AT RIGHT, FIRMLY SET AND  
PROTRUDING 4 INCHES ABOVE GROUND.  
FROM RENEWAL # 200 BY BAUGHMAN,  
A 5/8 INCH DIAM. IRON ROD FIRMLY SET  
AND PROTRUDING 10 INCHES FROM GROUND  
ON NW EDGE OF DC SO BRASS CAP.

\_\_\_\_\_  
 \_\_\_\_\_  
 \_\_\_\_\_  
 \_\_\_\_\_  
 \_\_\_\_\_  
 \_\_\_\_\_  
 \_\_\_\_\_  
 \_\_\_\_\_  
 \_\_\_\_\_  
 \_\_\_\_\_

DOUGLAS COUNTY SURVEYORS OFFICE

T265 R3W

$\frac{1}{4}$   $\frac{S2}{S11}$

1976

Accessories Found:

FROM RENEWAL # 200, TWO BEARING TREES FOUND. A 12" D. FIR  
NOW A 13 INCH D.B.H. DOUGLAS FIR WITH A FULLY HEALED DOUBLE  
BLAZE BEARS N 11° W, 24.2 FEET DIST. (RECORD N 8° W, 24.0 FT.)  
A 24" D. FIR NOW A 26 INCH D. B. H. DOUGLAS FIR WITH A  
FULLY HEALED DOUBLE BLAZE BEARS S 11° E, 25.2 FEET DIST. (RECORD  
S 8° E, 25.2 FT.)

FROM RENEWAL # 205 ONE BEARING OBJECT IS FOUND  
A 5/8 INCH DIAMETER IRON ROD MARKING POSITION OF EPPSTEIN'S  
1/4 CORNER FOR SECTIONS 2 AND 11 (SEE RENEWALS # 5, 54, 113, 164)  
IS FIRMLY SET AND PROTRUDING 6 INCHES ABOVE GROUND  
BEARS N 28 3/4° E, 119.2 FEET DIST (AS PER RECORD).

#246

RENEWAL

Monument Set (Procedure and Description)

Monument Detail

MONUMENT POSITION IS ACCEPTED AS FOUND. MAGNETIC BEARING AND TAPED DISTANCE AGREE WITH TRAVERSE BEARING AND DIST. RECORDED TO EPPSTEIN'S 1/4 CORNER IN RENEWAL # 205.

AN ERROR IN DECLINATION IS APPARENTLY REPEATED IN MEASUREMENT TO THE BEARING TREES IN RENEWALS # 200 & 205.

New Accessories  
(NONE)

Sketch of Monument, Accessories, and General Area

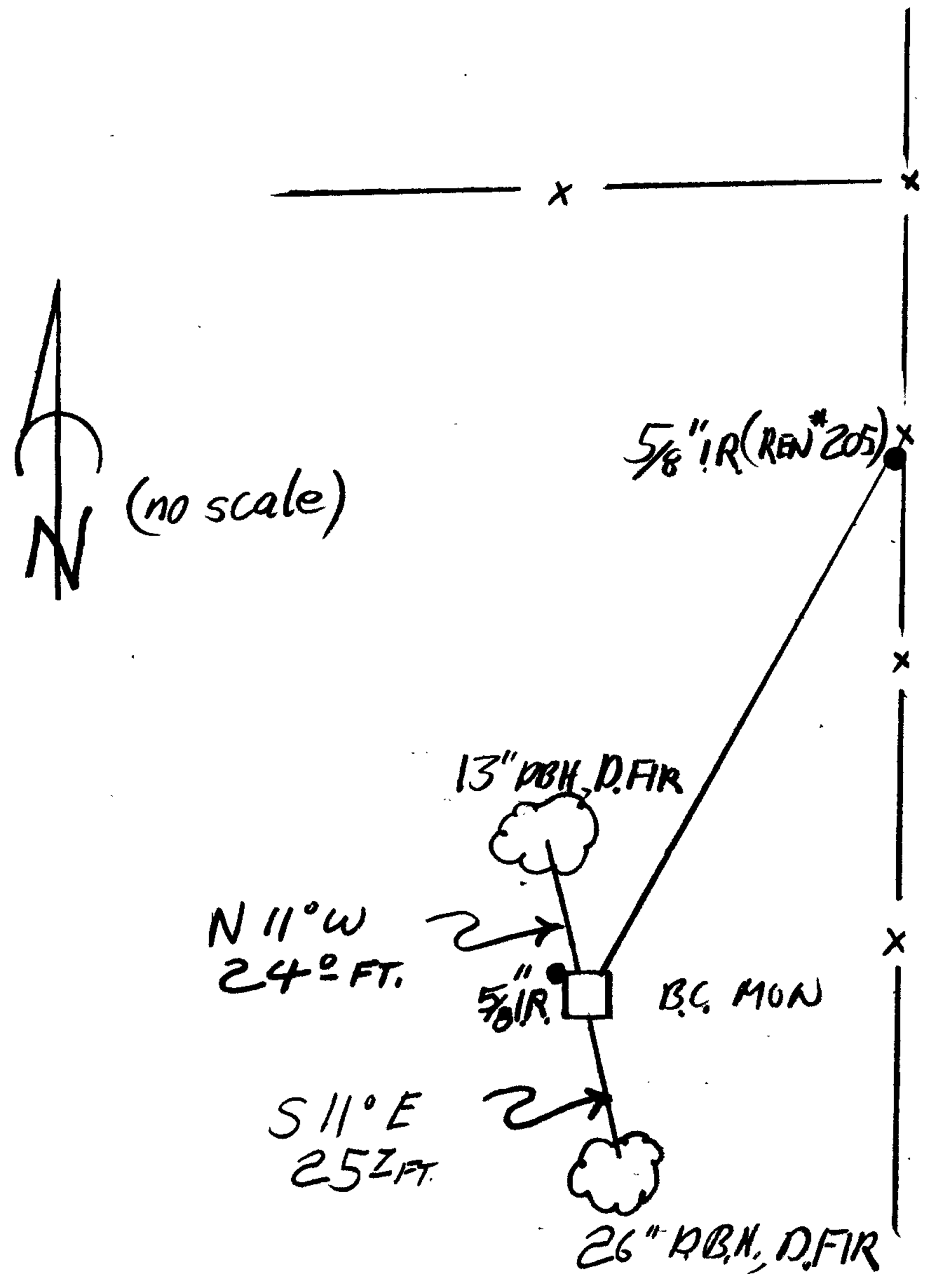

Location & Comments  
COR. LIES ON SMALL BENCH NEAR TOP OF A STEEP SOUTHERLY SLOPE AND IS APPROXIMATELY 1700' NORTH EAST OF THE POINT WHERE KIMMEL LANE TURNS WEST IN T26S, R3W, S11.

Comp. Declin. 18 1/2° E  
 Agency DCSO  
 Party Chief Stephen John Flase  
 Notekeeper R.W. SMITH  
 Witnesses CAROL OUBE

**Surveyor's Seal**  
 REGISTERED  
 PROFESSIONAL  
 LAND SURVEYOR

*Larry E. Monrean*  
 OREGON  
 JULY 13, 1979  
 LARRY E. MONREAN  
 #1830