

GOVERNMENT CORNER RESTORATION FORM

Township 28S Range 1W Sec. 33 County DOUGLAS

State OREGON Date JUNE 13, 1985 No. _____

Corner Designation

T28S R1W S1/4 S33

- _____ Condition Report Only
- _____ Not Found
- Renewed
- _____ Unrecorded
- _____ Surveyed In
- _____ Referenced Out

Previous Renewals ^{T28-1 #114 T29-1} #26 & 1922 RESURVEY

MONUMENT DETAIL

Monument(s) Found: (Condition and Source)

AN IRON PIPE WITH A BRASS MARKED AS AT RIGHT, FIRMLY SET AND PROTRUDING 8 INCHES FROM GROUND. THIS MONUMENT FROM 1975 RENEWAL.

FROM ORIGINAL SURVEY A STONE MARKED 1/4 ON NORTH FACE PROTRUDES APPROX 5 INCHES FROM GROUND AT NE EDGE OF BRASS CAP MONUMENT. PORTION OF STONE EXPOSED MEASURES APPROX. 5x13 INCHES.

COUNTY SURVEYORS OFFICE

T28S R1W

1/4 S33

1975

Accessories Found:

TWO ORIGINAL BEARING TREES: A FIR 12 INS. DIAM. NOW A 19 INCH DIAMETER, 4.2 INCH TALL FIR STUMP BEARS N 14° E, 11.2 FT DIST (AS PER RECORD) THIS TREE HAS A WELL HEALED SINGLE BLAZE POINTING APPROX. S 54° W.

AND A CEDAR 24 INS. DIAM. NOW A 36 INCH DIAM. 15 INCH TALL CEDAR STUMP BEARS S 16° W, 29.7 FT. DIST. (AS PER RECORD), SHOWS SIGNS OF 1922 OBLITERATION OF ORIGINAL BLAZE (THIS IS NO LONGER A BT FOR THE S 1/4 OF S33).

FROM THE 1922 RESURVEY A FIR 9 INS DIAM. NOW A 9 INCH DIAMETER 2.6 INCH TALL FIR STUMP BEARS N 30° W 10.6 FT DIST. (AS PER RECORD) WELL HEALED SINGLE BLAZE.

#151 T29-1 ✓
#41 T28-1 ✓

RENEWAL

Monument Set (Procedure and Description)

MONUMENT POSITION IS ACCEPTED AS FOUND.

Monument Detail

New Accessories

A BOAT SPIKE STAMPED B O 1 SET IN A 30 INCH DIAMETER, 16 INCH TALL FIR STUMP AND BEARING N 86 3/4° E, 27° FT. DIST.
A BOAT SPIKE STAMPED B O 2 SET IN A 31 INCH DIAMETER, 18 INCH TALL FIR STUMP AND BEARING N 42 1/4° W, 55 1/2 FT. DIST.

Sketch of Monument, Accessories, and General Area

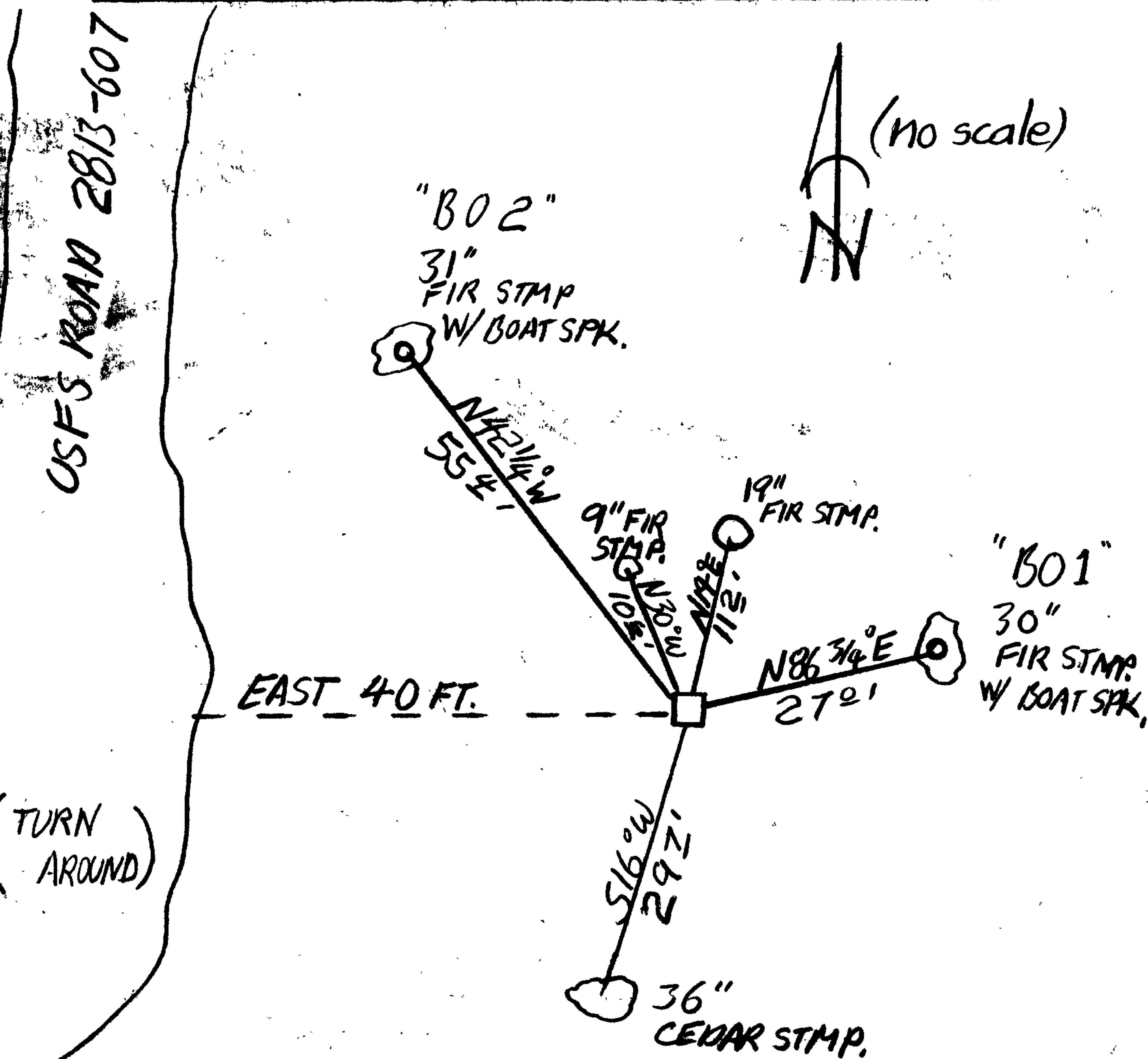

Location & Comments

FROM THE END OF USFS ROAD #2813 - 607 MONUMENT BEARS EAST APPROX. 40 FT. DIST. AND SLIGHTLY LOWER THAN ROAD.

CORNER IS IN CLEAR CUT NO TREES AVAILABLE FOR SCRIBING

Comp. Declin. 18 1/2° E

Agency DCSO

Party Chief RANDALL W. SMITH

Notekeeper STEPHEN JOHN FLAUS

Witnesses Stephen John Flaus

Surveyor's Seal

REGISTERED PROFESSIONAL LAND SURVEYOR

Larry E. Monrean

OREGON JULY 13, 1979 LARRY E. MONREAN #1830