

GOVERNMENT CORNER RESTORATION FORM

Township 28S Range 1W Sec. 7 County DOUGLAS

State OR Date AUG. 14, 1985 No. L.S. 1181

Corner Designation

1/4 CORNER TO SECTIONS 7 AND 18,
T28S, R1W, WILLAMETTE MERIDIAN

- Condition Report Only
- Not Found
- Renewed
- Unrecorded
- Surveyed In
- Referenced Out

MONUMENT DETAIL

Previous Renewals

Monument(s) Found: (Condition and Source)

SEARCHED FOR AND DID NOT FIND ORIGINAL CORNER STONE. THIS AREA WAS CLEARCUT IN 1983. THE STONE WAS NOT FOUND BY DISTRICT PERSONNEL PRIOR TO THE TIMBER CUTTING. IN MY VISIT TO THE SITE IN JULY, 1983 THE CORNER POINT WAS COVERED BY FRESHLY FALLEN AND BUCKED TIMBER. IN AUGUST, 1985 THE AREA WAS COVERED WITH SLASH AND HAD OBVIOUSLY BEEN DISTURBED.

RECORD BEARING TREE DISTANCES FROM CENTER OF TREES WOULDN'T INTERSECT, BUT DISTANCES MEASURED FROM THE BLAZED FACES MATCH THE RECORD BEARINGS.

FILED
RECEIVED
SEP 4 1985
COUNTY SURVEYOR
DOUGLAS COUNTY, ORE

Accessories Found:

ORIGINAL BEARING TREES ESTABLISHED BY HOMER D. ANGELL, DEPUTY SURVEYOR, IN 1902:

A 28" W. FIR STUMP, N44°E, 16⁵ FT. TO FACE, 17⁴ FT. TO 60d. NAIL SET IN CENTER OF STUMP (REC: HEMLOCK, 16⁵ FT.), WITH SCRIBE MARKS "ST BT" VISIBLE ON SINGLE BLAZE WHICH I OPENED.

A 40" DOUG. FIR STUMP, S21°W, 15⁸ FT. TO FACE, 17⁰ TO 60d NAIL SET IN CENTER OF STUMP (REC: HEMLOCK, 15⁸ FT.), WITH HEALED SINGLE BLAZE.

#424

RENEWAL

Monument Detail

Monument Set (Procedure and Description)

AT THE INTERSECTION OF THE RECORD BEARINGS AND DISTANCES FROM THE BLAZED FACES, I SET A 2 1/4" OUTSIDE DIAMETER IRON PIPE, 30" LONG, SET 12" IN THE GROUND WITH A 4 FT. DIAMETER MOUND OF STONE TO THE TOP WITH A BRASS CAP MARKED AS SHOWN:

INSIDE THE IRON PIPE I PLACED A 1/2" WIRE ROPE, 12" LONG, WITH BELL ON THE BASE AS A MEMORIAL.

I SET A 6 FT. STEEL FENCE POST, EAST, 3.0 FT. DRIVEN 15 FT. IN THE GROUND AS A GUARD POST WITH FOREST SIGN # 54-4 ATTACHED.

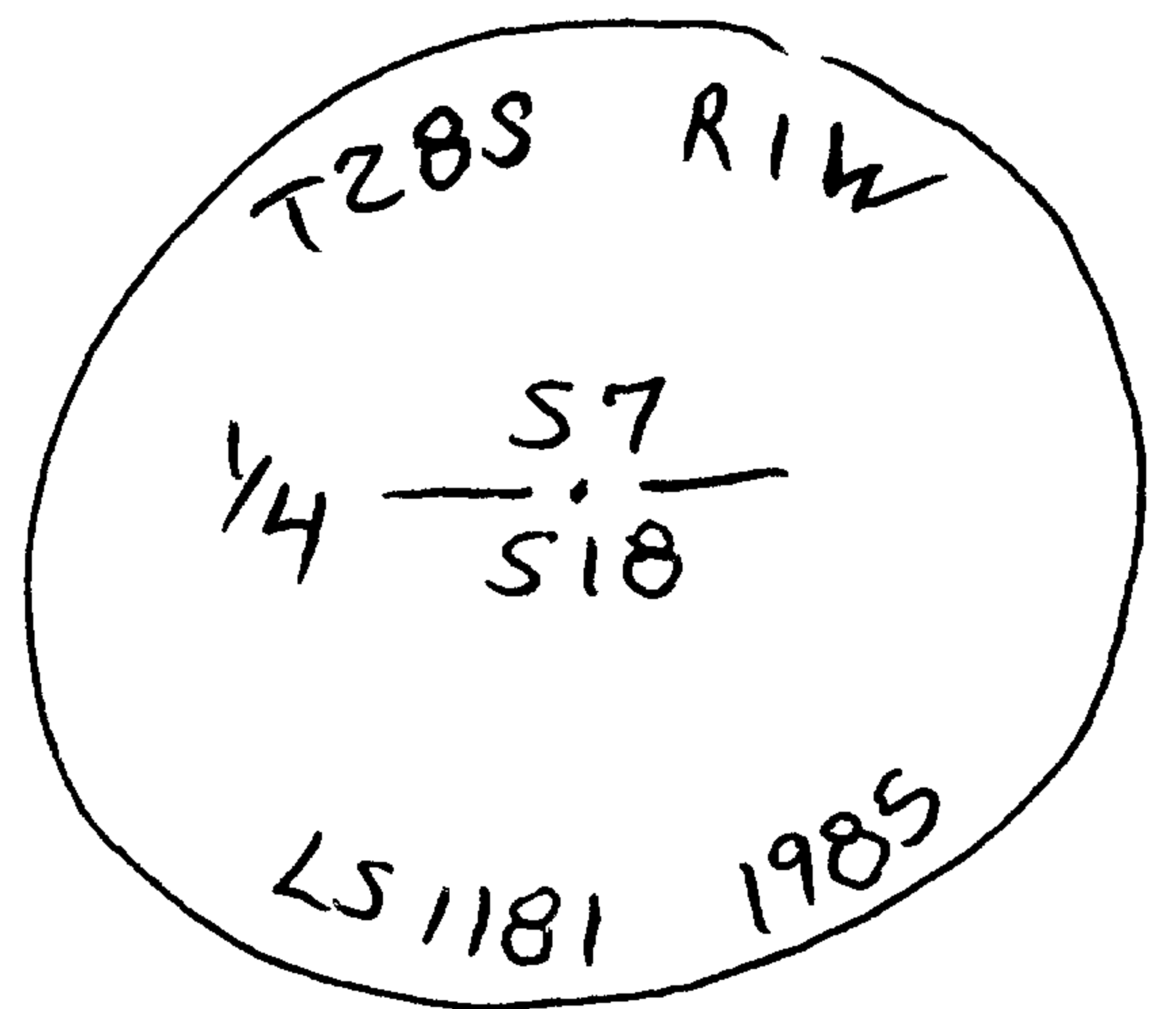

New Accessories

I MARKED NEW BTS: IN 1983 AN 8" HEMLOCK, N10°E, 76 2/3 FT., ~~BT~~ SCRIBED "1/4 S7 BT" ON A SINGLE BLAZE.

AND A BT IN 1985: A 5" HEMLOCK, S45 1/4°E, 86 2/3 FT., SCRIBED "1/4 S18 BT" ON A SINGLE BLAZE WITH A 3/4" BRASS WASHER, STAMPED "LS 1181", NAILED FLUSH TO BASE OF BLAZE.

Sketch of Monument, Accessories, and General Area

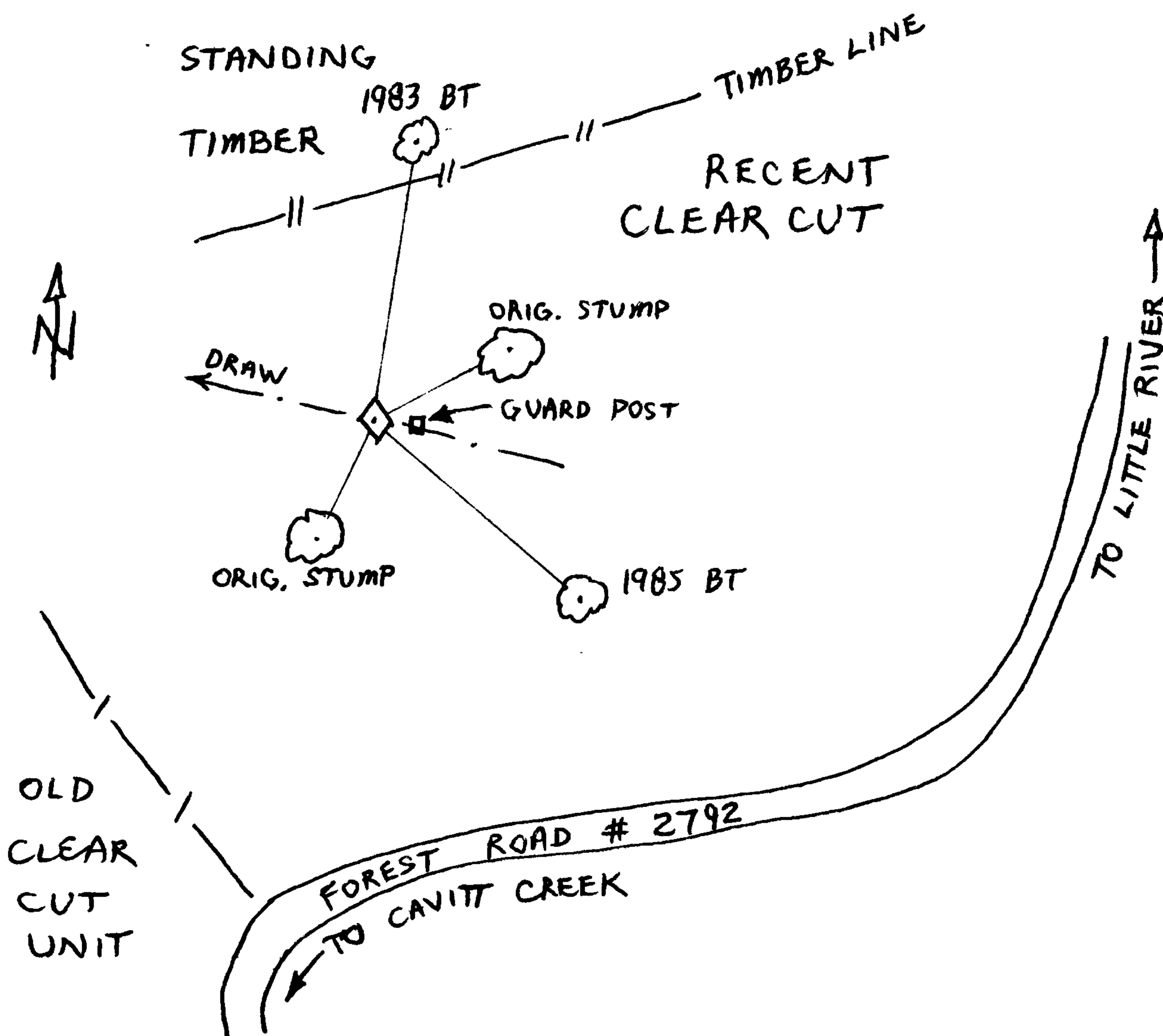

Location & Comments

CORNER IS 2 FT. SOUTH OF DRAW WHICH DRAINS N70°W AND 60 FT. SOUTH OF THE TIMBER LINE IN UNIT #14 OF THE RED IDIOT TIMBER SALE.

CORNER IS APPROXIMATELY 300 FT. NORTH OF FOREST ROAD #2792.

Comp. Declin. 19° EAST.
 Agency USDA FOREST SERVICE
 Party Chief LEONARD HERTSTEIN
 Notekeeper LEONARD HERTSTEIN
 Witnesses RANDY LOPEZ.

REGISTERED PROFESSIONAL LAND SURVEYOR

Maurice E. Farr

OREGON
 SEPT. 23, 1977
 MAURICE E. FARR
 1181

Surveyor's Seal

ok