

FILED
RECEIVED

OCT 18 1984

OREGON CORNER RESTORATION FORM

Section 29 Township 29S Range 4W

County Douglas Date 10/16/84

COUNTY SURVEYOR
DOUGLAS COUNTY, ORE.

Corner Designation

$\frac{1}{4}$ $\frac{S20}{S29}$

- Condition Report Only
- Not Found
- Renewed
- Unrecorded
- Surveyed In
- Referenced Out

Previous Renewals/Surveys, etc.

Reestablished by BLM survey 1969 approved 1977

Monument(s) & Accessories Found: (Condition and Source)

BTs of 1969 record
A maple 21" Bears N.15°E, 52 1/2 dist., fragmentary scribe marks visible on partially healed blaze.

A maple 17", Bears S.45°E, 4 1/2 1/2 dist., fragmentary scribe marks visible on partially healed blaze.

iron post found out of the ground.

Monument Detail

Sketch

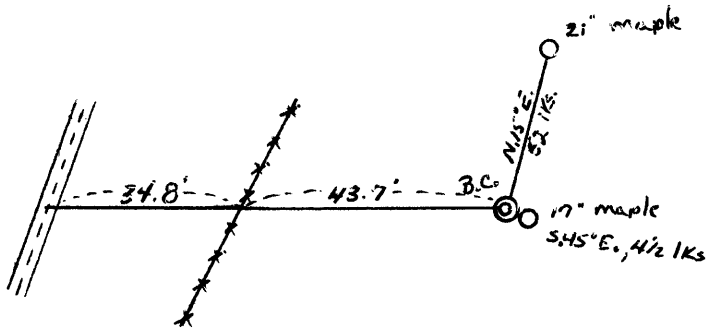

Monument Set (Procedures and Description)

BLM iron post reset at record bearing and distance from bearing trees marked in 1969.

New Accessories

No new accessories marked

Location & Comments

Surveyor's Seal

Compass Declination _____

Firm/Agency BLM

Address _____

Party Chief James White

Notes _____

Witness Wayne Rogers

262 ✓

C.S. File No. 62/24-1c

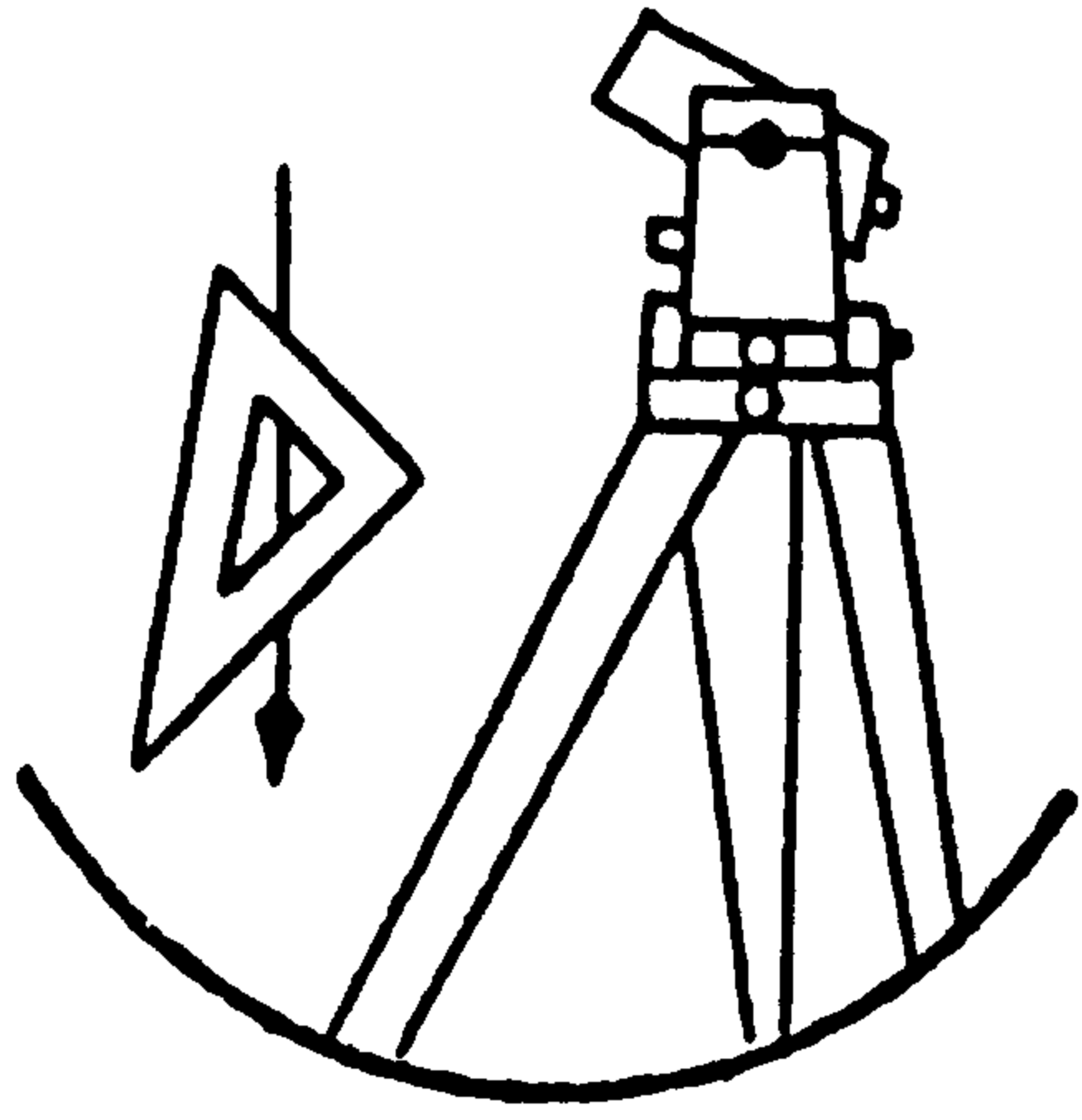

DOUGLAS COUNTY SURVEYOR'S OFFICE

ROOM 205 - JUSTICE BUILDING
ROSEBURG, OREGON 97470
PHONE 440-4272

9-26-84

FRITZ INGRAM
COUNTY SURVEYOR

T 29 S R 4 W $\frac{1}{4}$ $\frac{S 20}{S 29}$

Found BLM Monument, out of ground, leaning against fence.
Found two maple BT's of record, 1969, approved 1977 BLM plat (per BLM record)
Determine a temporary point, from which:

17", now 21" maple bears North 13° East 32.6 feet (Record North 15° East 34.3 feet checks well with center of trunk, breast height). We open well-healed blaze and find scribing "4 S 20 BT".

A 7", now 16" maple bears South $30\frac{1}{2}^{\circ}$ East 3.0 feet (record South 45° East 3.0 feet, checks well with center of trunk at breast height). We open well-healed blaze and find fragmentary scribe marks.

From this point we check the following calls from the 1978 plat records:

*West 21.1 feet, a fence, course North 20° East and South 20° West, we measure 41 feet.

*West 47.5 feet, a road, course North 20° East and South 20° West, we measure 65 feet.

A 1973 survey by Don Garrett in County Surveyor's file M 48-33 records a U.S. Cadastral Survey brass cap at a position conflicting with that of the previously noted record. By using the same bearing trees noted earlier, we establish a temporary point using Garrett's 1973 BT information as follows:

A 21" maple bears North 71° East 8.9 feet (Record North $67\frac{1}{2}^{\circ}$ East 8.9 feet).
a 9" maple bears South $5\frac{1}{2}^{\circ}$ East 31.7 feet (Record South $4\frac{1}{2}^{\circ}$ East 31.7 feet).

A fence, course North 20° East and South 20° West bears West 34.0 feet (record 21.1 feet). Edge of road bears West approximately 55 feet (record 47.5 feet). See sketch of conditions as related.

We note the following:

The Garrett Survey shows BT measurements in feet and tenths to all corners used except for the corner in question. It seems as though he was following a BLM record.

The notes show this position to be monumented in 1969. The plat was approved in 1978; five years after the Garrett survey. Was the position amended after the Garrett survey?

C.S. File No. 62/24-1

The blaze in the Northerly BT favors the BLM record position. A partially healed injury (appears to be an axe blaze on the same tree) favors the Garrett record position.

NOTE: 10-1-84, Mark Garrett brought in his father's computation file on this survey (M 48-33). The field note's bearings and distances agree with the map. (Also, the bearing and distance information was recorded in links at the corner).

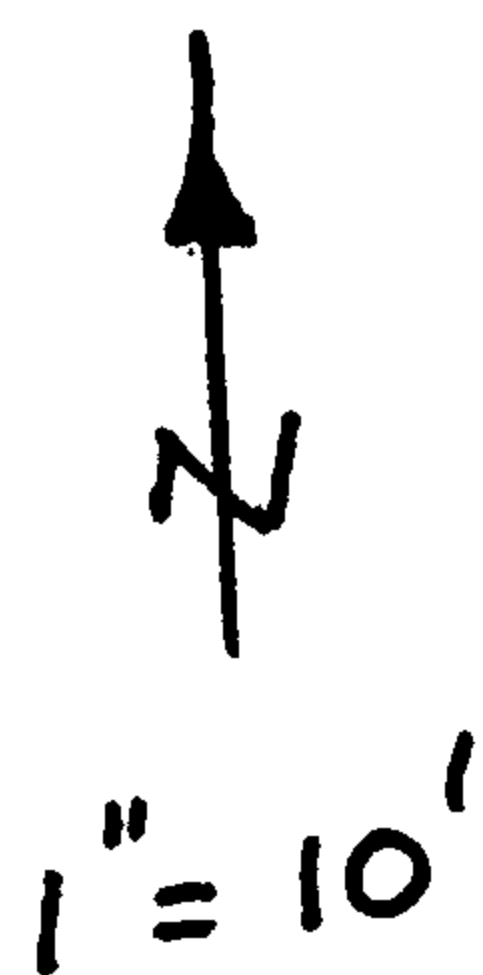
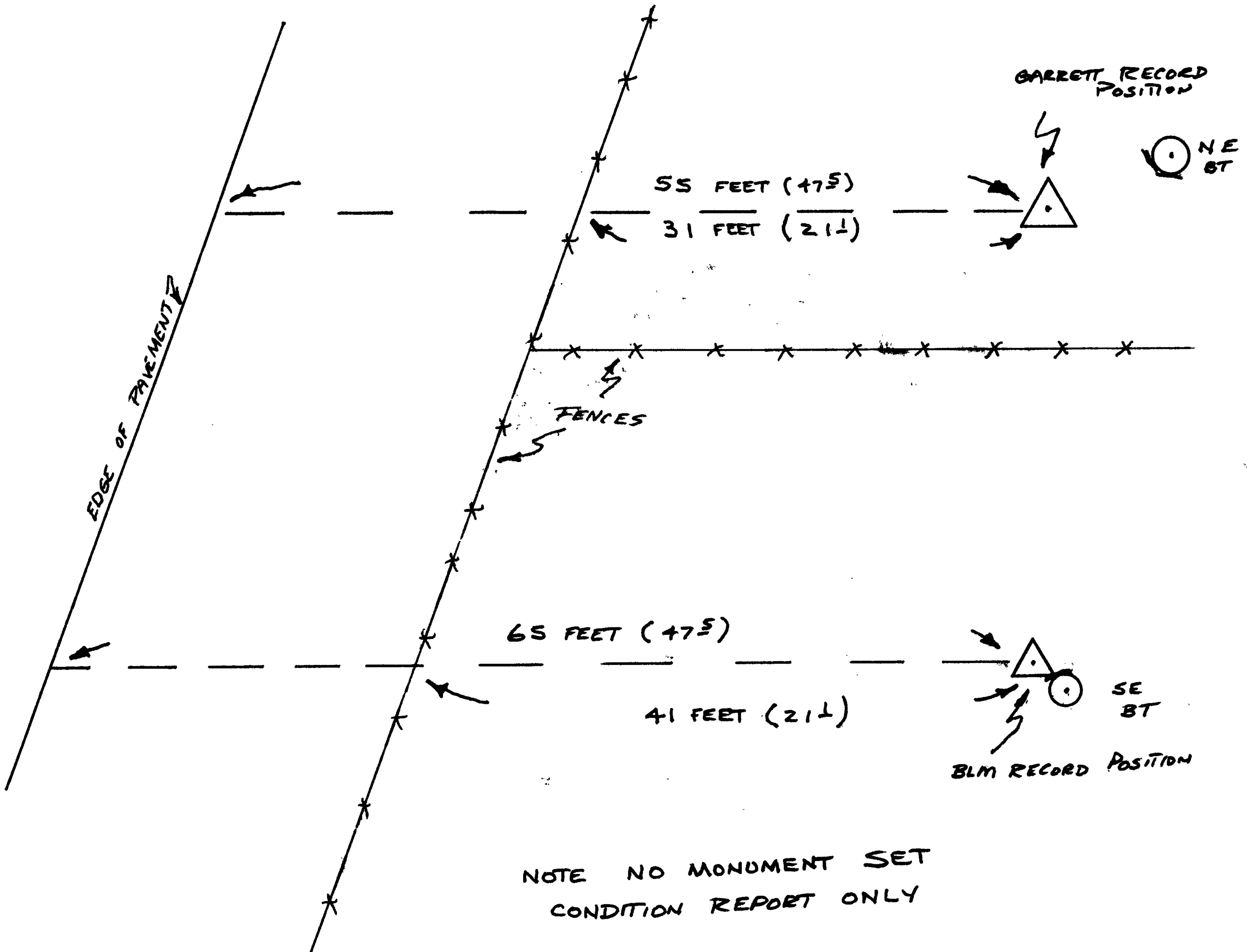

REGISTERED
PROFESSIONAL
LAND SURVEYOR

Larry E. Monrean

OREGON
JULY 13, 1979
LARRY E. MONREAN
#1830