

GOVERNMENT CORNER RESTORATION FORM

Township 32S Range 5W Sec. 1 County DOUGLAS

State OR Date 11/7/84 No. _____

Corner Designation

1 x 6

- Condition Report Only
- Not Found
- Renewed
- Unrecorded
- Surveyed In
- Referenced Out

Previous Renewals 114 (T.32-5) #69 (T.32-4)

Monument(s) Found: (Condition and Source)

FD 3/4" IRON PIPE W/ METAL TAG
STAMPED "RE 3024"

Accessories Found:

FD 12" FIR (NOW 19" DIAM FIR SNAG 4 FT. TALL) BEARS
N 52 1/2° W 34.1 FT. SCRIBING IS VISIBLE, "1/4 2"
(REC N 54° W 34.3)

FD 22" FIR (NOW 24" DIAM - TREE DOWN WITH SCRIBING STUMP)
STUMP REMA BEARS S 15 1/2° W 44.0 (REC.) "RE 3024"

MONUMENT DETAIL

215 T. 32-5 X
147 T. 32-4 X

C.S. File No. 62/21-44 C

RENEWAL

Monument Set (Procedure and Description)

Monument Detail

WE REFERENCE IRON PIPE AND REPLACE WITH 2 1/4" BRASS CAP ON 1' X 30" PIPE AND MOUND ROCKS AROUND MONUMENT. 3/4" IRON PIPE IS BURIED ALONGSIDE

DOUGLAS COUNTY
T32S
R4W
SURVEYOR
1/4 S. 1/56.

1984

New Accessories

11" DIAM INCENSE CEDAR - CENTER OF BASE BEARS N 23 1/2° W 57.6' & IS SCRIBED "1/4 S. 1 CSBT" ON A DOUBLE BLAZE
 12" DIAM MAPLE - CENTER OF BASE BEARS S 58° W 35.9' AND IS SCRIBED "1/4 S. 1 CSBT" ON A DOUBLE BLAZE
 12" DIAM MAPLE - CENTER OF BASE BEARS S 34 1/2° E 13.2' AND IS SCRIBED "1/4 S. 6 CSBT" ON A DOUBLE BLAZE
 10" DIAM FIR - CENTER OF BASE BEARS S 83° E 25.0' AND IS SCRIBED "1/4 S. 6 CSBT" ON A DOUBLE BLAZE

Sketch of Monument, Accessories, and General Area

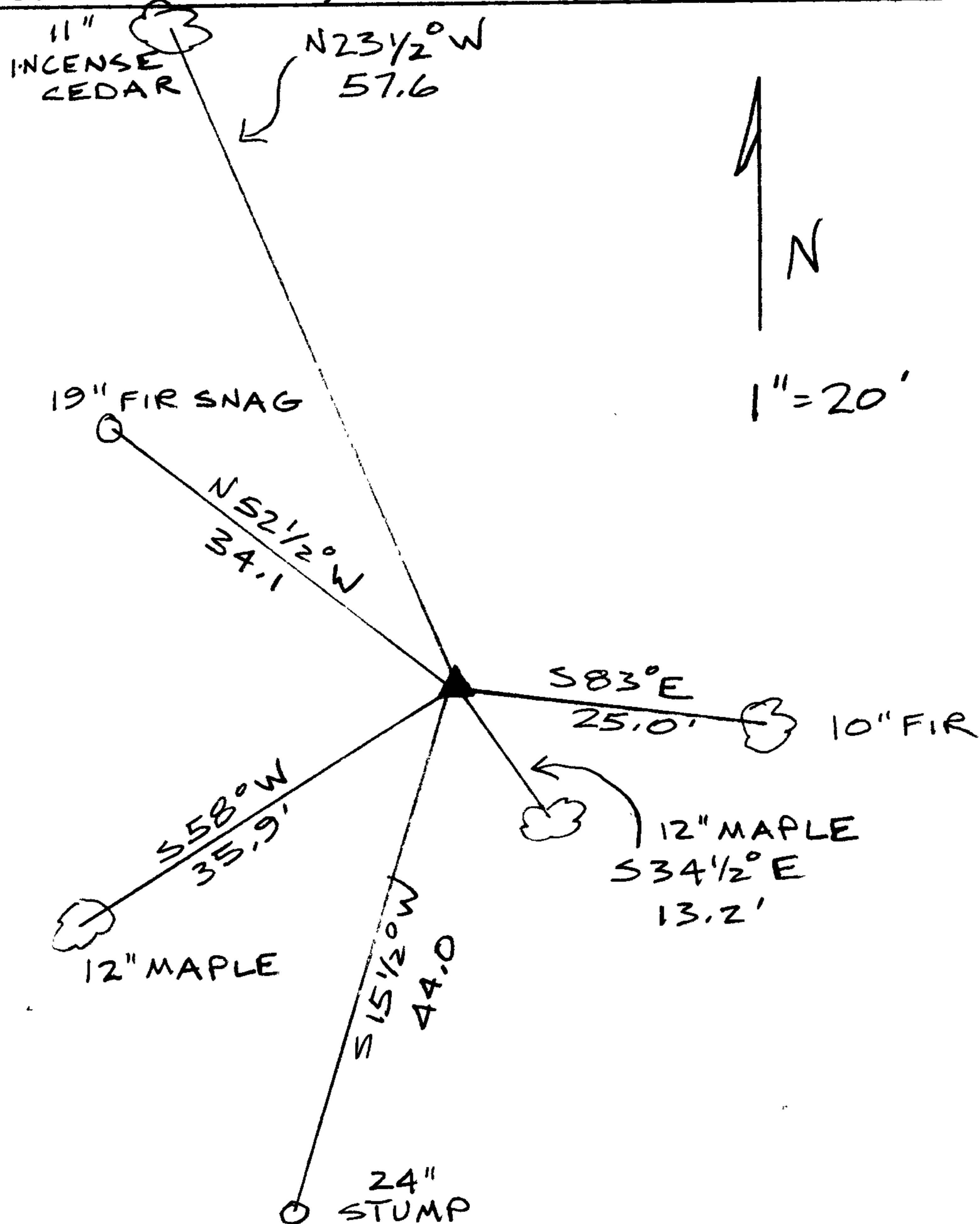

Location & Comments

Comp. Declin. 19° E 18 1/2° E
 Agency DCSO
 Party Chief LEM
 Notekeeper JRL
 Witnesses RWS

Surveyor's Seal
 REGISTERED
 PROFESSIONAL
 LAND SURVEYOR

Larry E. Monrean

OREGON
 JULY 13, 1979
 LARRY E. MONREAN
 #1830