

GOVERNMENT CORNER RESTORATION FORM

Township 30 S Range 2 W Sec. 8 County DOUGLAS

State OREGON Date 8-13-84 No. _____

Corner Designation

1/4 S 8/59

- _____ Condition Report Only
- _____ Not Found
- Renewed
- _____ Unrecorded
- _____ Surveyed In
- _____ Referenced Out

Previous Renewals 164, E 240

Monument(s) Found: (Condition and Source)

FOUND FIRMLY SET AND 8" BELOW THE SURFACE THE IRON PIPE WITH BRASS CAP MARKED AS NOTED FROM RENEWAL NO. 164. ALSO FOUND THE ORIGINAL STONE MEASURES APPROX 11 X 8 1/2 X 5 INCHES. THE CENTER OF THE STONE BEARS N 44° E 0.5 FEET FROM THE BRASS CAP MONUMENT. THE FAULT MARK "1/4" WAS LOCATED ON THE BOTTOM OF THE STONE AS FOUND (SEE PHOTO)

MONUMENT DETAIL

COUNTY SURVEYORS OFFICE
T 30 S
1/4 S 8/59
R 2 W
1968

Accessories Found:

1. ORIGINAL 12" MAPLE DOUBLE TRUNK WITH NORTHERLY TRUNK SPLIT & DEAD NO SCRIBING FOUND BEARS S 53 1/2° W 5 3/4 FT TO CENTER OF ROOT CROWN. RENEWAL # 240 CALLS 4 1/2 FEET DISTANCE WHICH CHECKS WELL TO CENTER OF TRUNK AT APPARENT GROUND ABL LEVEL (SLIDE ACTIVITY HAS COVERED LOWER PORTION OF THE TRUNK)
2. ORIGINAL FIR BT NOT FOUND
REN. # 164 BT'S AS RECORDED IN RENEWAL # 240
2. 8" FIR NOW AN 11" FIR SNMP WITH TIN ROOF, PARTIALLY HEALED BLAZE BEARS N 55° E, 54° FEET
12" W. FIR DEAD AND DOWN
3. RENEWAL # 240 BT'S.
3. 14" NOW 20" D. FIR WITH SCRIBING "1/4 S 8 BT" VISIBLE IN PARTIALLY HEALED BLAZE BEARS S 78 1/2° W 63.3 FEET (REC. S 76° W)
4. 16" NOW 22" D. FIR WITH SCRIBING "1/4 S 9 BT" VISIBLE IN PARTIALLY HEALED BLAZE BEARS S 40° E 48 1/2 FEET.

#250 ✓

C.S. File No. 62/21-420

RENEWAL

Monument Set (Procedure and Description)

Monument Detail

NONE

NOTE: AREA EXCAVATED TO EXPOSE
BRASS CAP.

New Accessories

17" D. FIR DOUBLE BLAZED AND SCRIBED "1/4 S B C S B T" BEARS S 36 1/2° W 14 5 FEET.
15" MAPLE DOUBLE BLAZED AND SCRIBED "1/4 S B C S B T" BEARS N 69° W 30 7 FEET
(LOWER BLAZE BEARS N 67° W)

Sketch of Monument, Accessories, and General Area

Location & Comments

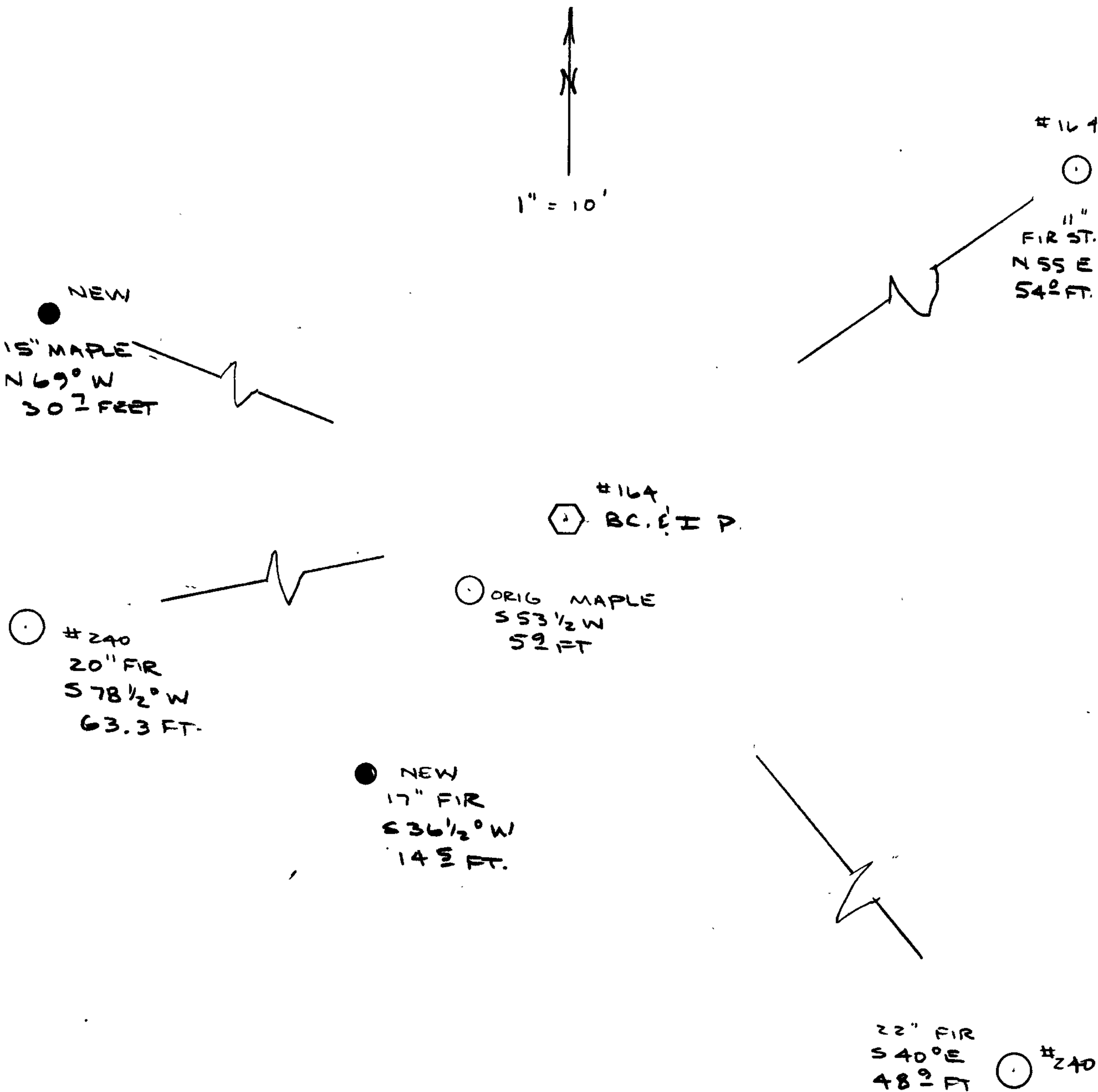

#164
FIR ST.
N 55° E
S 42° FT.

Comp. Declin. 19° EAST
Agency DOUGLAS COUNTY SURVEYOR'S OFF.
Party Chief LARRY E. MONREAN
Notekeeper " " "
Witnesses R. W. SMITH
S. J. FLAUSE

Surveyor's Seal

REGISTERED
PROFESSIONAL
LAND SURVEYOR

Larry E. Monrean

OREGON
JULY 13, 1979
LARRY E. MONREAN
#1830