

GOVERNMENT CORNER RESTORATION FORM

Township 26 S Range 6 W Sec. 13 County DOUGLAS

State OREGON Date 7-27-84 No. _____

Corner Designation

1/4 S14|S13

- Condition Report Only
- Not Found
- Renewed
- Unrecorded
- Surveyed In
- Referenced Out

Previous Renewals # 89 (BYRON)

Monument(s) Found: (Condition and Source)

ORIGINAL MONUMENT NOT FOUND

IRON PIPE AND BRASS CAP SET BY BYRON
 RECENTLY SET AND PROTRUDING 16" ABOVE
 GROUND IS MARKED

MONUMENT DETAIL

COUNTY SURVEYOR'S OFFICE
 T 26 S R 6 W
 1/4 S14|S13
 1961

Accessories Found:

ORIGINAL NE BT NOT FOUND.

ORIGINAL 15" W. OAK IS DEAD AND DOWN. FOUND STUMP SHELL 30" DIAMETER WITH DECAYED REMAINS OF TRUNK LAYING ALONGSIDE (NO SCRIBING FOUND). STUMP BEARS S 62° W 207 3/4 FEET (RECORD BEARING N 59 1/4° E CHECKS WELL FROM BT STUMP TO CAP. AGREES WITH BYRON'S COMMENTS ON LOCAL MAGNETIC ATTRACTION NEAR THE CORNER MONUMENT).

BYRON BT: A 10" NOW 14" W. OAK WITH WELL HEALED DOUBLE BLAZE BEARS S 37° E 63 1/2 FEET. BT SITUATED ALONG S.E. EDGE OF DRY POND BED.

#186 ✓

RENEWAL

Monument Set (Procedure and Description)

NONE

Monument Detail

N/A

New Accessories

SE CORNER OF DEL RIO RANCH ESTATES (PER M 33-74) A 3/4" IRON ROD 2' SOUTHERLY OF FENCE INTERSECTION (FENCES RUNNING NORTHERLY - WESTERLY - AND SOUTHERLY) BEARS S 49 1/2° E 139 6 FEET.

TIED FOOTING CORNER (NOT BLOCK STEM WALL) AT SOUTH EAST CORNER OF BARN BEARS N 13 1/2° E 115 3 FEET. WE MARK SOUTHERLY FACE OF FOOTING "B O".

Sketch of Monument, Accessories, and General Area

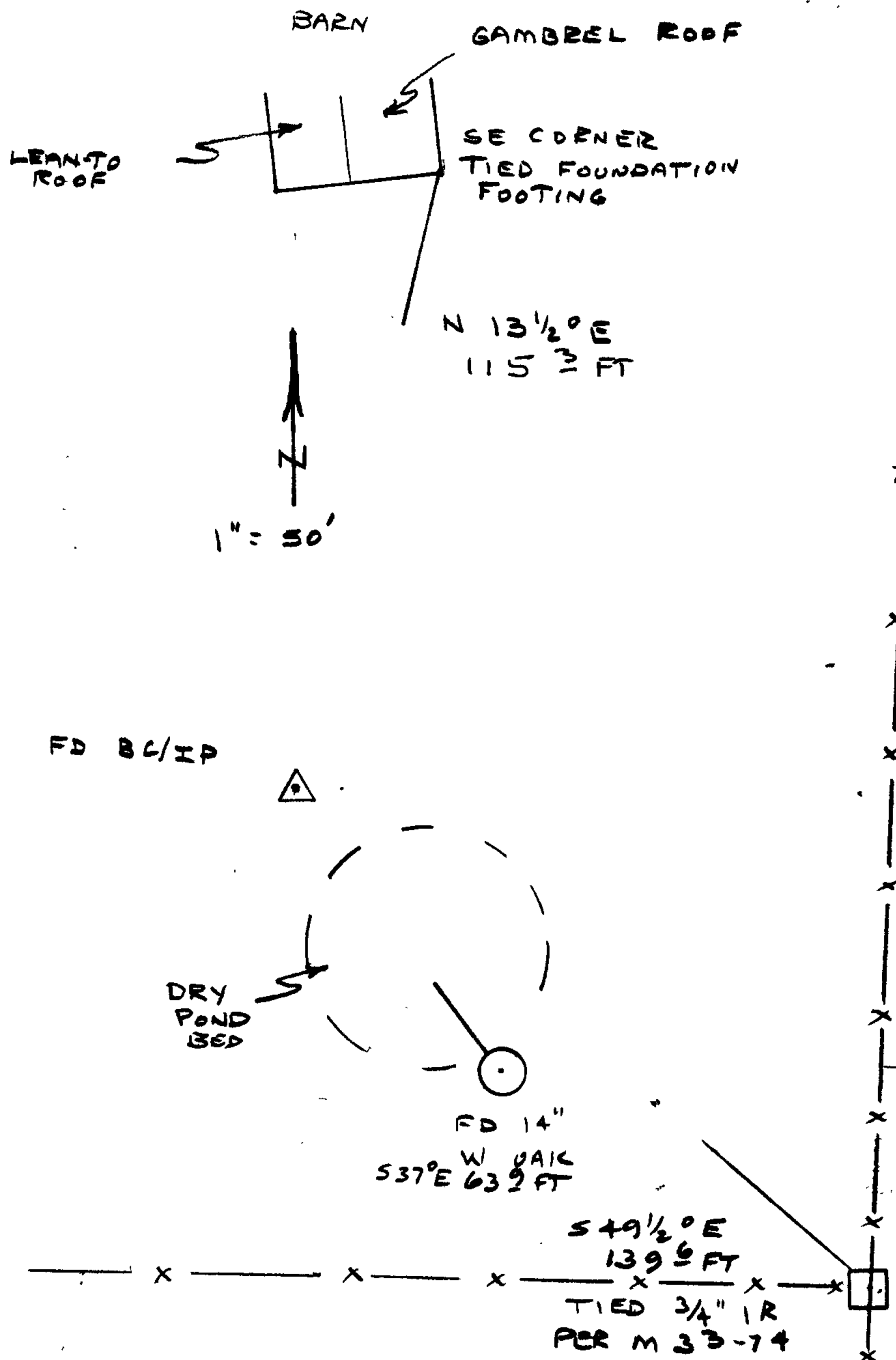

Location & Comments

BASED ON BEARINGS NOTED ARE MAGNETIC NORTH AND OBSERVED FROM THE CORNER. THE 18 1/2° DECLINATION ~~WAS USED~~ THE NOTED LOCAL MAGNETIC SHOULD BE CONSIDERED AND APPLIED IF NEEDED

Comp. Declin. 18 1/2° EAST
Agency DOUGLAS COUNTY SURVEYOR'S OFFICE
Party Chief LARRY E. MONROE
Notekeeper " " "
Witnesses S. J. FLAUS

Surveyor's Seal

REGISTERED
PROFESSIONAL
LAND SURVEYOR

Larry E. Monroe

OREGON
JULY 13, 1979
LARRY E. MONROE
#1830