

GOVERNMENT CORNER RESTORATION FORM

Township 26S Range 3W Sec. 17 County DOUGLAS

State OREGON Date 12/2/84 No. _____

Corner Designation

WIT. COR.

1/4 S18 | S17

- Condition Report Only
- Not Found
- Renewed
- Unrecorded
- Surveyed In
- Referenced Out

Previous Renewals #70, #140, #211

Monument(s) Found: (Condition and Source)

A DISK ON AN I.P. PROTRUDING
3 IN. ABOVE GROUND. MARKED AS
NOTED (PER REN# 211).

MONUMENT DETAIL

DOUGLAS COUNTY SURVEYOR

T26S R3W

WIT. COR.

S18 | S17

21.3 FT. N. TO 1/4 COR.

1977

Accessories Found:

8" NW AN 1 1/2" DIA. B. OAK WITH A WELL HEALED SINGLE BLAZE
BEARS N79°W, 43.8 FT (PER REN# 140).

6" NW AN 8" DIA. W. OAK WITH A PARTIALLY HEALED DOUBLE
BLAZE SCRIBING VISIBLE "1/4 S18 CS", BEARS N9°W, 6.4 FT
(PER REN# 211).

C.S. File No: 62/24-17

#2384

RENEWAL

Monument Set (Procedure and Description)

Monument Detail

NONE

N/A

New Accessories

10" DIA. SW. OAK DOUBLE BLAZED AND SCRIBED "WC 1/4 S17CS BT"
BEARS N50°E, 20.4 FT

Sketch of Monument, Accessories, and General Area

Location & Comments

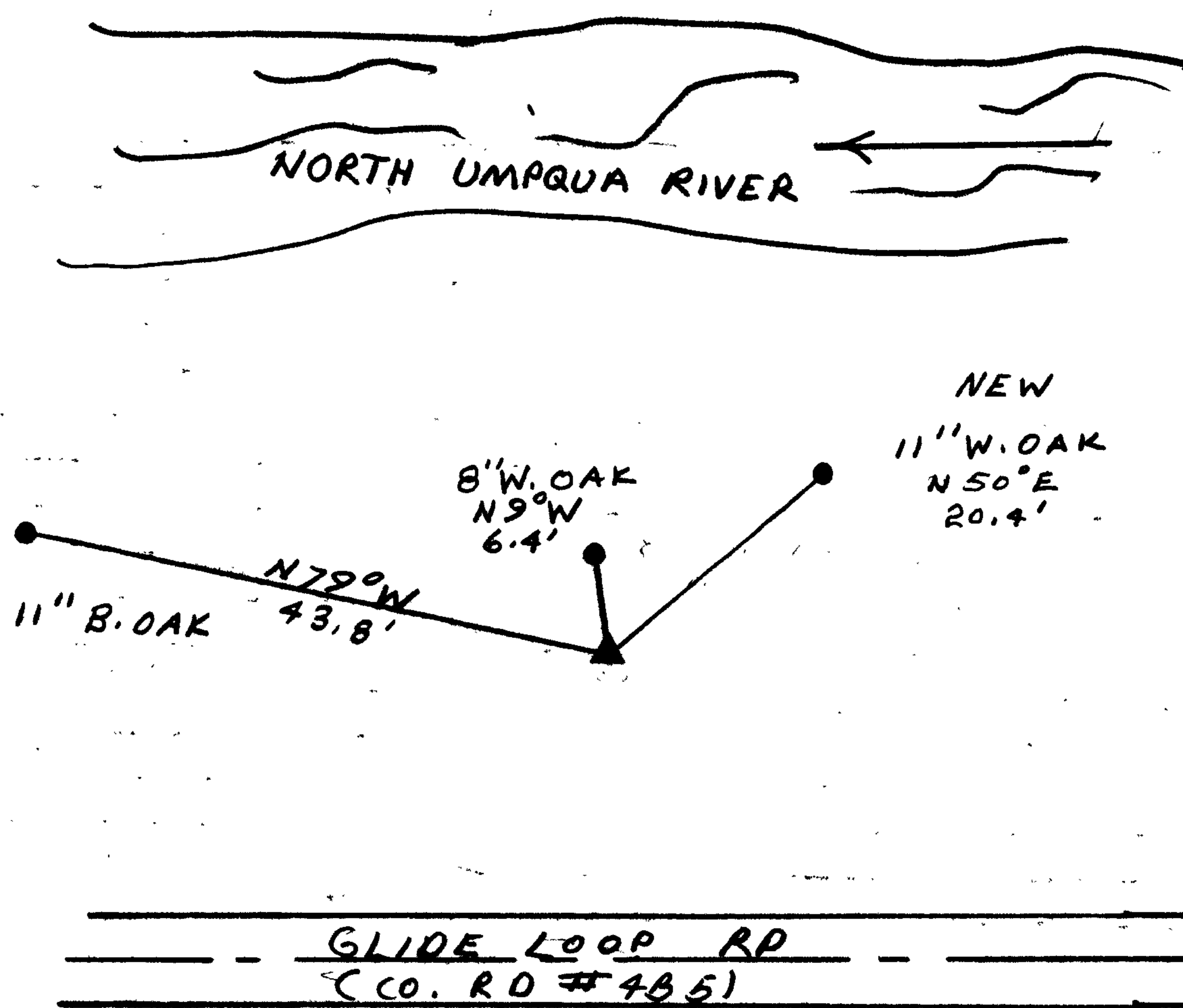

W. CO. LIES 22 FT
NORTH OF GLIDE LOOP RD
CENTER LINE (CO. RD. #485)

NO SCRIBABLE TREES SOUTH
OF CORNER.

SCOTT MTN. LOOK OUT NOT
OBSERVED DUE TO CLOUD COVER.
SEE REN #140

Comp. Declin. 18 1/2° E

Agency DCSO

Party Chief RANDALL W. SMITH

Notekeeper STEPHEN J. FLAUSÉ

Witnesses

Surveyor's Seal

REGISTERED
PROFESSIONAL
LAND SURVEYOR

Larry E. Monrean

OREGON
JULY 13, 1979
LARRY E. MONREAN
#1830