

GOVERNMENT CORNER RESTORATION FORM

Township 26S Range 3W Sec. 10 County DOUGLAS
State OREGON Date DEC. 21, 1984 No. _____

Corner Designation

W. C.
1/4 S10 | S11

- _____ Condition Report Only
- _____ Not Found
- Renewed
- _____ Unrecorded
- _____ Surveyed In
- _____ Referenced Out

Previous Renewals 23, 37, 61, 201, 208

Monument(s) Found: (Condition and Source)

FROM RENEWAL #208
 A D.C.S.O. 2 3/8 INCH DIAMETER BRASS CAP
 ON A 1 1/4 INCH DIAMETER IRON PIPE
 FIRMLY SET, PROTRUDING 4 INCHES ABOVE
 GROUND AND MARKED AS AT RIGHT.
 A 5/8 INCH DIAMETER IRON ROD IS
 SET PROTRUDING 3 INCHES ABOVE GROUND
 AT NORTH EDGE OF ABOVE BRASS CAP MONUMENT.
 IRON ROD RECORDED FIRST IN RENEWAL #201.

MONUMENT DETAIL

DOUGLAS COUNTY SURVEYOR

W. C.

T26S R3W

N. TO

1/4 S10 | S11

16.0 FT.

1977

Accessories Found:

REMAINING BEARING TREES FROM RENEWALS 23-61 HAVE EFFACED
BLAZES; BEARING AND DISTANCES OF THESE TREES RELATE ONLY TO
ERRONEOUS CORNER POSITION (SEE CS. FILE 59/21), THEY ARE NOT
CHECKED.

FROM RENEWAL #201 TWO BTs AS FOLLOWS: A 7" OAK, NOW
A 10 INCH D.B.H. WHITE OAK WITH A WELL HEALED DOUBLE BLAZE
BEARS S 80° E, 12 3/4 FT DIST. (REC. S 75° E, 12 3/4 FT), SCRIBING AND
BLAZE FROM 1957 RENEWAL REMOVED PREVIOUSLY.

AN 8" OAK, NOW A DOUBLE TRUNK WHITE OAK WITH THE MOST EASTERN
AND BLAZED TRUNK MEASURING 6 INCHES D.B.H. HAS A PARTIALLY HEALED
DOUBLE BLAZE WITH THE SCRIBING WC 1/4 S10 BT VISIBLE AND BEARS
S 60° W, 18.9 FT. DIST. (REC. S 58° W, 18.6 FT. DIST.; THIS MEASUREMENT IS GOOD
TO CENTER OF BLAZED TRUNK AT GREATEST HEIGHT.)

FROM RENEWAL #208 A 5/8 INCH DIAM. IRON ROD (MARKING POSITION
OF 1957 BRASS CAP) BEARS N 77° E, 84° FT DIST. (REC. N 80° E, 84° FT.)
FIRMLY SET AND PROTRUDING 3 INCHES FROM GROUND.

#240 ✓

C.S. File No. 62/21-16 c

RENEWAL

Monument Set (Procedure and Description)

NA

Monument Detail

NA

New Accessories

A 1/2 INCH DIAM IRON ROD FIRMLY SET AND PROTRUDING 6 INCHES ABOVE GROUND BEARS S 66° W, 23.0 FT. DIST. (REC. S 67 1/2° W, 23 1/5 FT, M 85-58) THIS MONUMENT IS THE MOST EASTERLY SOUTHEAST CORNER OF PARCEL 1 IN DC.S.O. MAP FILE M 59-8.

Sketch of Monument, Accessories, and General Area

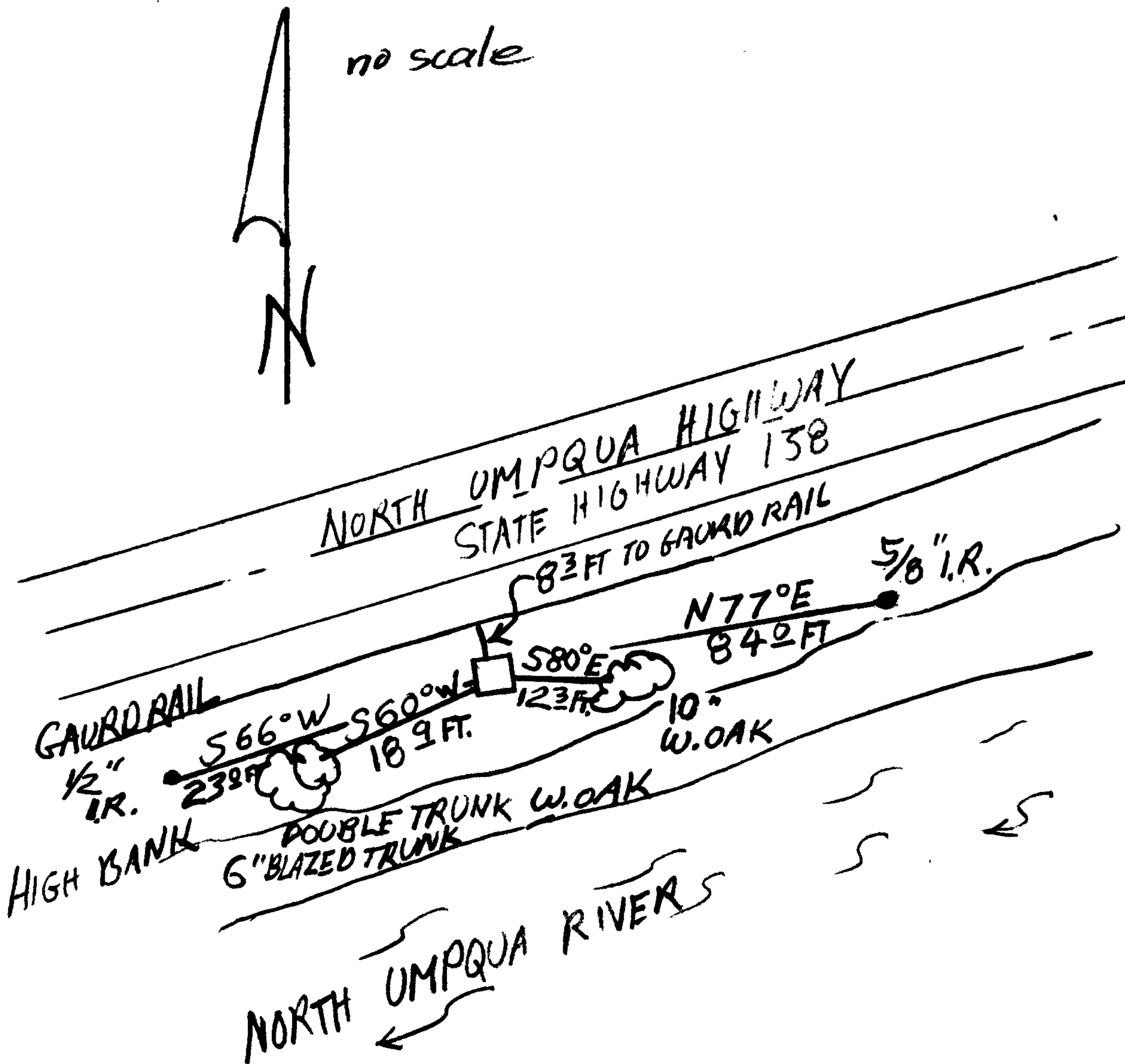

Location & Comments

MONUMENT IS LOCATED 93 FT SOUTH OF SOUTH GAURURAIL OF HIGHWAY 138 AND JUST NORTH OF HIGH BANK OF NORTH UMPQUA RIVER.

Comp. Declin. 18 1/2° E
Agency DC SO
Party Chief S J FLAUSE
Notekeeper Nicole John Flause
Witnesses R.W. SMITH

Surveyor's Seal

REGISTERED PROFESSIONAL LAND SURVEYOR
Larry E. Monrean
OREGON JULY 13, 1979 LARRY E. MONREAN #1830