

GOVERNMENT CORNER RESTORATION FORM

Township 26S Range 2W Sec. 16 County DOUGLAS

State OREGON Date 12/19/84 No. _____

Corner Designation

S17	S16
	COA2 TR37

Condition Report Only
 Not Found
 Renewed
 Unrecorded
 Surveyed In
 Referenced Out

Previous Renewals # 102

MONUMENT DETAIL

Monument(s) Found: (Condition and Source)

A U.S. GENERAL LAND OFFICE DISK
ON AN I.P. PROTRUDING 21 IN.
ABOVE GROUND MARKED AS NOTED
(ORIG).

(U.S. GENERAL LAND OFFICE SURVEY

TR6S	S16
R2W	
S17	<u>2</u> TR 37

1918

Accessories Found:

42" NOW A 31" DIA. 2 YR FT HIGH DECAYED FIR STUMP NO
SCRIBING OR FACE FOUND BEARS S42°E, 59.9 FT (ORIG.)

37" DIA. MAPLE WITH PARTIALLY HEALED SINGLE BLAZE, ILLEGIBLE
SCRIBING VISIBLE, BEARS S33°E, 43.3 FT (PER REN#102)

#135 X

C.S. File No. 62/2/12 c

RENEWAL

Monument Set (Procedure and Description)

SET A 2 1/2 FT DIA. 1 1/2 FT HIGH
MOUND OF STONE AROUND I.P.

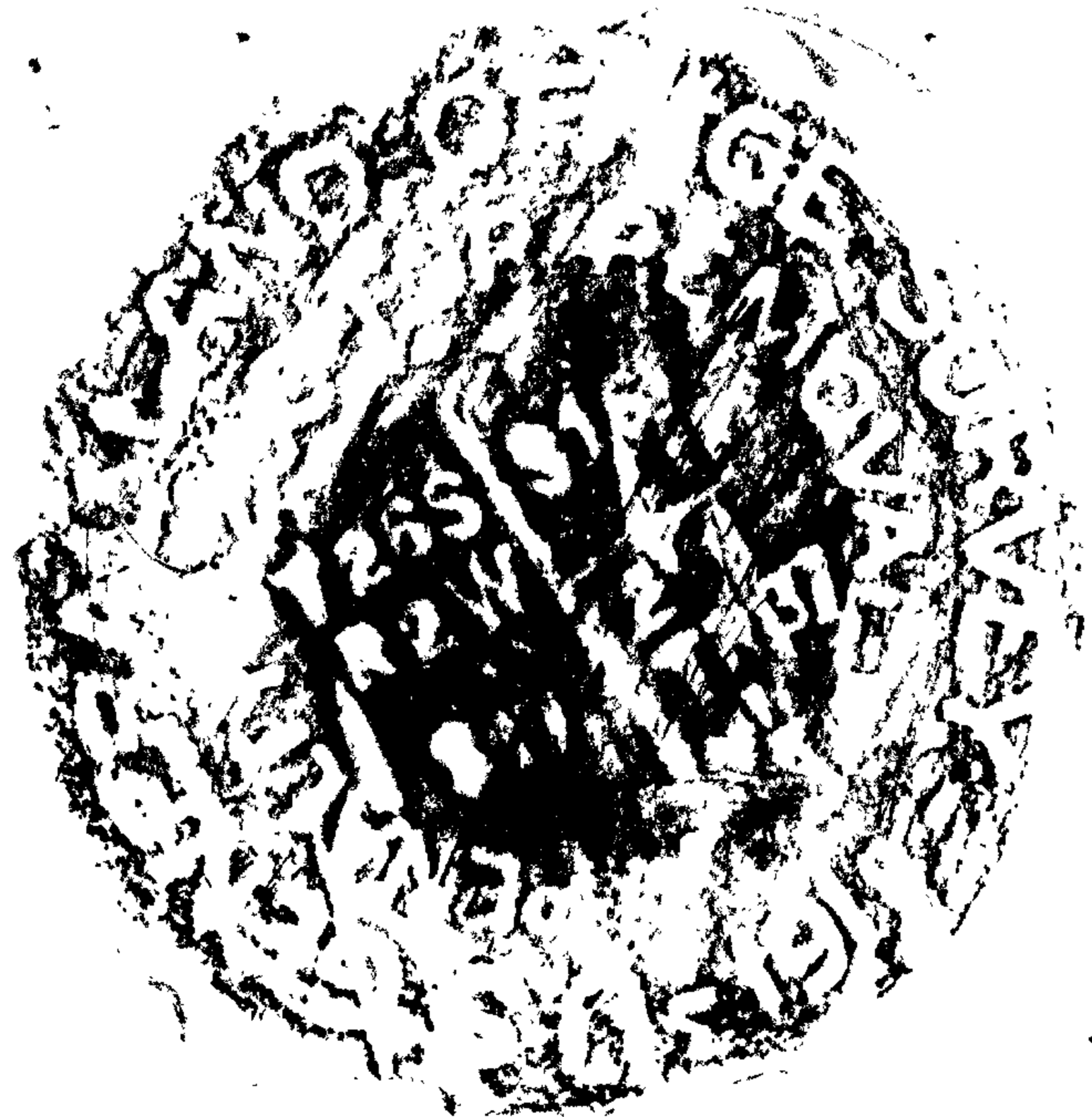

New Accessories

11" DIA. D. FIR WITH A DOUBLE BLAZE SCRIBED "2 TR 37 CS BT"
BEARS S70°E, 45.2 FT.

13" DIA. D. FIR WITH A DOUBLE BLAZE SCRIBED "2 TR 37 CS BT"
BEARS N43°E, 36.9 FT.

Sketch of Monument, Accessories, and General Area

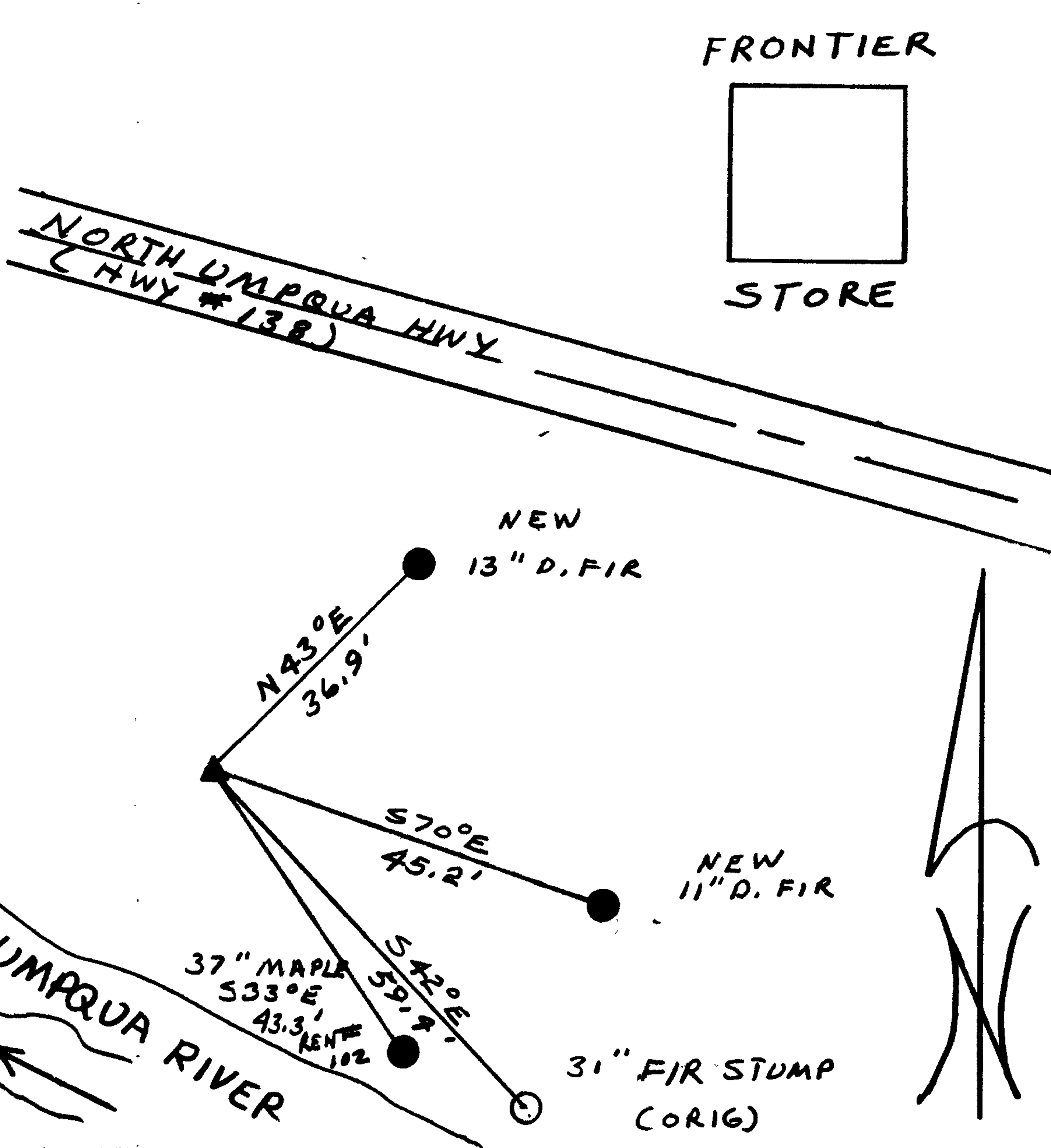

Location & Comments

CORNER LIES BETWEEN
NORTH UMPQUA HWY AND
NORTH UMPQUA RIVER ACROSS
HWY FROM FRONTIER STORE.

Comp. Declin. 18 1/2° E
Agency DCSO
Party Chief RANDALL W SMITH
Notekeeper Randall W Smith
Witnesses STEPHEN J FLAUSE

Surveyor's Seal
REGISTERED
PROFESSIONAL
LAND SURVEYOR

Harry E. Monrean

OREGON
JULY 13, 1979
HARRY E. MONREAN
#1830