

GOVERNMENT CORNER RESTORATION FORM

Township 285 Range 7W Sec. 23 County DOUGLAS

State GREGON Date JULY 26, 1984 No. \_\_\_\_\_

Corner Designation

T285 RTW  
S23  
C1/4

- Condition Report Only
- Not Found
- Renewed
- Unrecorded
- Surveyed In
- Referenced Out

Ren. # 237

Previous Renewals ~~NONE~~ (FILED AS CS. 60/5)

Monument(s) Found: (Condition and Source)

A 3/4 INCH (I.D.) IRON PIPE PROTRUDING  
8 INCHES FROM GROUND AND FIRMLY  
SET. (RECORD. A 3/4 INCH I. ROD, AS PER  
RENEWAL # 237)

MONUMENT DETAIL

N/A

Accessories Found:

(NONE)

RENEWAL

Monument Set (Procedure and Description)

Monument Detail

(NONE)

N/A

New Accessories

A 14 INCH D.B.H. DOUGLAS FIR, SCRIBED C<sup>1</sup>/<sub>4</sub> 523 CS BT, ON A DOUBLE BLAZE, BEARS N 20 1/2° E, 4<sup>2</sup> FT. DIST.

A 10 INCH D.B.H. DOUGLAS FIR SCRIBED C<sup>1</sup>/<sub>4</sub> 523 CS BT, ON A DOUBLE BLAZE, BEARS N 54 1/2° W, 11<sup>2</sup> FT. DIST.

Sketch of Monument, Accessories, and General Area

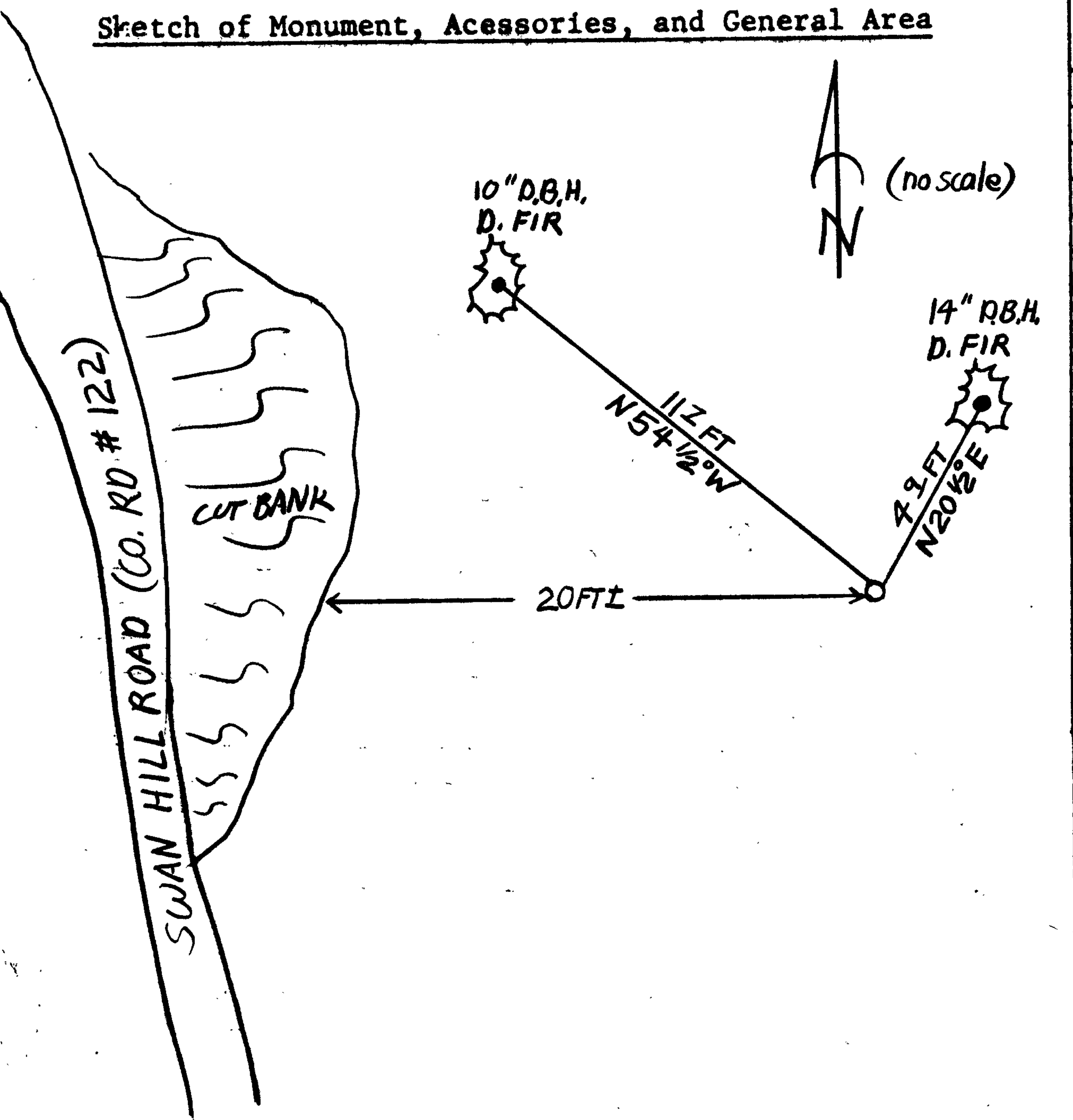

Location & Comments

MONUMENT LIES APPROX. 20 FT. NE OF TOP OF CUT BANK, APPROX. 800 FT. SE OF END OF COUNTY MAINTAINED PORTION OF SWAN HILL ROAD (CO. RD. #122)

Comp. Declin. 18 1/2° E

Agency DCSD

Party Chief STEPHEN JOHN FLAUSE

Notekeeper Stephen John Flause

Witnesses RANDY W. SMITH

Surveyor's Seal

REGISTERED  
PROFESSIONAL  
LAND SURVEYOR

Larry E. Monrean

OREGON  
JULY 13, 1979  
LARRY E. MONREAN  
#1830