

GOVERNMENT CORNER RESTORATION FORM

Township 31S Range 2W Sec. 15 County DOUGLAS

State OREGON Date NOV. 30, 1983 No. _____

Corner Designation

NW 1/16 CORNER OF SECTION 15

- Condition Report Only
- Not Found
- Renewed
- Unrecorded
- Surveyed In
- Referenced Out

Previous Renewals C.S. FILE 58/28

Monument(s) Found: (Condition and Source)

2 1/2" I.P., FIRMLY SET, FLUSH WITH A
 3 FT. DIAMETER MOUND OF STONE, WITH
 A BRASS CAP MARKED AS SHOWN, SET
 BY GLEN BAUGHMAN, L.S. 536, IN
 1974.

MONUMENT DETAIL



Accessories Found:

BTS MARKED BY BAUGHMAN IN 1974:
 A 8" PINE SNAG, N10°E, 40 3/4 FT. (REC. 43 1/4 FT.) WITH
 SCRIBE MARKS "NW 1/16 S15 BT" VISIBLE ON PARTIALLY HEALED
 DOUBLE BLAZE WITH A BRASS WASHER STAMPED "RLS 536" NAILED
 TO BASE OF LOWER BLAZE.
 A 12" PINE, N74°W, 40 3/4 FT. WITH A HEALED DOUBLE BLAZE.

RENEWAL

Monument Set (Procedure and Description)

Monument Detail

NONE

New Accessories

I MARK A NEW BT:
A 8" I. CEDAR, N10°E, 49.7 FT, SCRIBED "NV '16 SIS BT"
ON A SINGLE BLAZE.

Sketch of Monument, Accessories, and General Area

Location & Comments

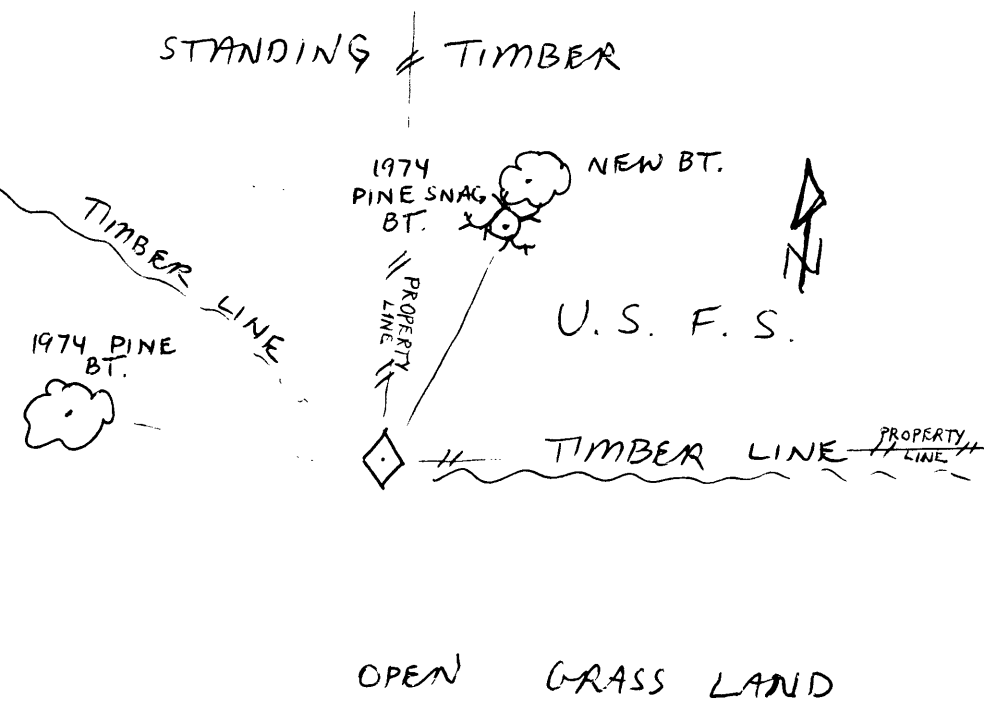

Comp. Declin. 20°4'E
Agency U.S. F.S.
Party Chief LEONARD HERZSTEIN
Notekeeper LEONARD HERZSTEIN
Witnesses JIM HAMILTON

Surveyor's Seal
REGISTERED
PROFESSIONAL
LAND SURVEYOR

Jan N. Landrum 4/15/84
JAMES N. LANDRUM