

DATE: June 25, 1984

Condition Report Only
 Not Found
 Renewed
 Unrecorded
 Surveyed In
 Referenced Out

Previous Renewal #'s #19 T19-10 #10 T19-9

Monument(s) Found: (Condition and Source) _____

Found sandstone 1⁸' x 1⁰' x 0⁶' with "X" chiseled on top

Found Hales' 5/8" re-bar (1984) brs. S59¹/₂°E, dist. 13⁴/₉' from
original stone.

Accessories Found: (Condition and Source) _____

Original BT: 42" Cedar stump brs. S3°W, dist. 100⁴/₁'; found reverse
original scribing. Stump was rescribed by Hales: "BT 1/4 S36".

31" Cedar stump (Hales) brs. S32°W, dist. 66²/₁', open face,
scribing visible: "BT 1/4 S36"

#37 T19-9 +
#38 T19-10 +

C.S. File No. 62/15-16 Page 1 of 1

C

T195 R Hales

4

SLOPE
DIST

VERT
4

TEMP

✓
DIST

RAW
SLOPE

BRNG

6/25/84
E.R. Alvarez 18
C Dickison
P. Smith

S. 36 F 1/4 Cor

1

Fd sandstone 13' x 12' x 0.6' w/ "x" on top
long wide

M

Fd dist & bearing to BT to be
S 3° W, 101²²' (to center) @ scribing
from x on top of stone.

Set brass cap
at position of stone; placed stone alongside cap

1

2

M

31" Cedar stamp (Hales)

Brs. S 32° W

Dist. 66³'

Open face scribing vis.

3/8" rebar in

center of

stamp

Scribed:

"BT 1/4 S36"

(by Hales)

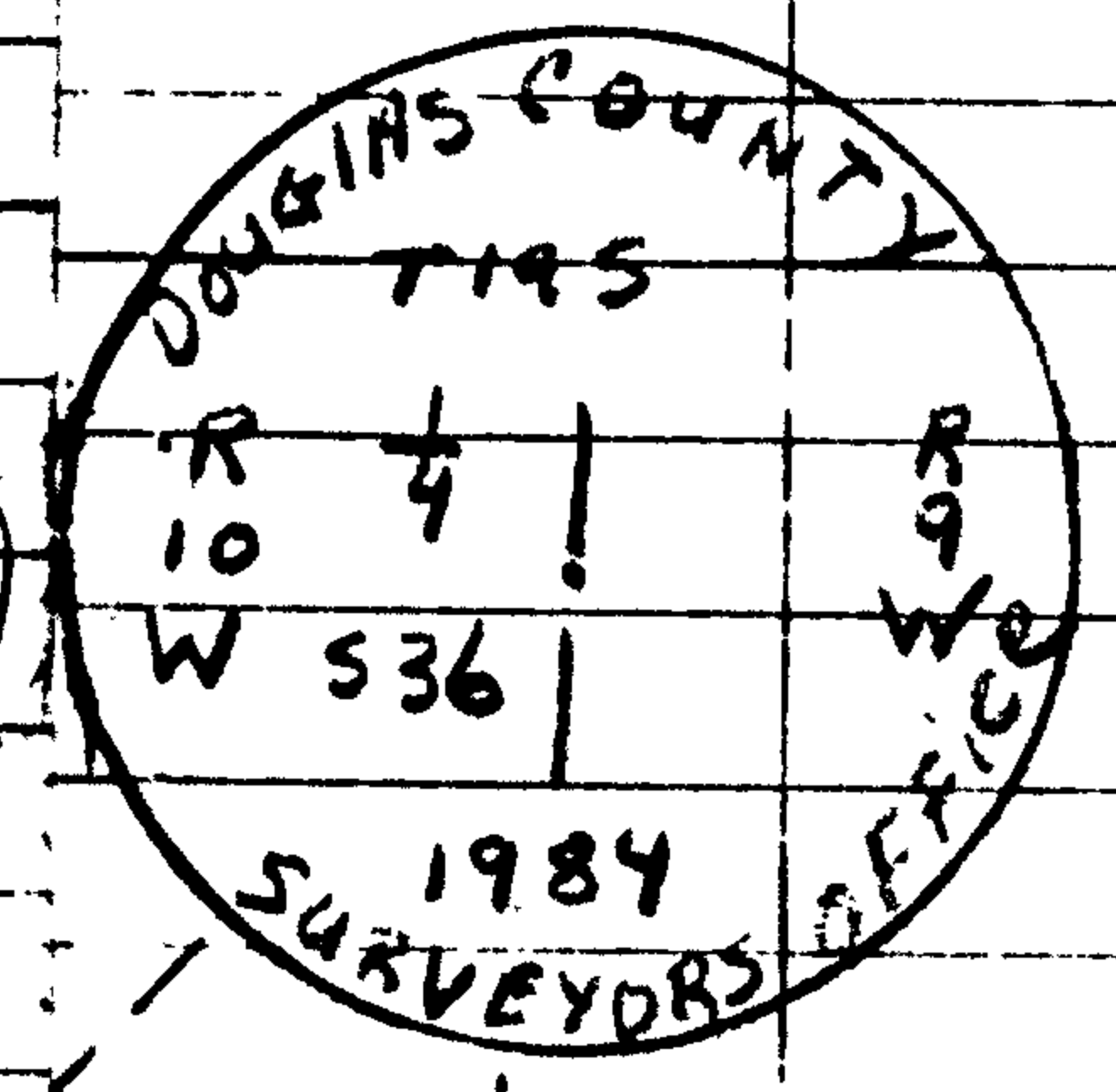

5/8" Rebar set by Hales (1984)

Brs. S 54 1/2° E

Dist. 134⁹'

1

2

M

orig BT:

42" Cedar stamp

Brs. S 3° W

Dist 101²⁵'

Fd reverse scribing

"BT 1/4 S36" (rescribed by Hales)

3/8" rebar driven into top center

To the orig. face
- scribing

BRASS/
CAP
Dist.
to center
of stamp
↓
100 1/4'
BYS.
S 3° W



DATE: 9/24/82

T19S R10W

25
36

- Condition Report Only
- Not Found
- Renewed
- Unrecorded
- Surveyed In
- Referenced Out

Previous Renewal #'s T19-10 T19-9
2 #2

Monument(s) Found: (Condition and Source)

Corner tree: 28" D-Fir, uprooted

Brass cap on root wad

FILED
RECEIVED

NOV 15 1982

COUNTY SURVEYOR
DOUGLAS COUNTY, ORE

Accessories Found: (Condition and Source)

38" Hemlock, uprooted

40" D-Fir, uprooted

#24 T19-9 ✓
#29 T19-10 ✓

RENEWAL

Monument Set: (Procedure and Description) _____

Corner Point: Set 5' steel post $1\frac{1}{2}$ ' above ground.

Brass cap placed alongside.

New Accessories: (Description) _____

38" Hemlock to rootwad brs. N87°W, dist. 33.6'
Uprooted Hemlock. Determined center of tree. At location set

5' steel post, brs. S82°W, dist. 47.0'

38" Hemlock stump brs. S74°W, dist. 47.3. R.P. 8"x3/8" nail.

Brng. and dist. to top of nail head.

36" Hemlock stump brs. S41°W, dist. 45.5'. R.P. 8"x3/8" nail.

Brng. and dist. to top of nail head.

Referenced Point: 43" Hemlock snag brs. N71°E, dist. 73.7'.

8"x3/8" nail. Brng. and dist. to top of nail head.

(Continued on Page 2)

Location and Comments: _____
Corner referenced out due _____
to logging. The landing _____
is just above the corner. _____

Compass Declination
Agency
Party Chief
Notekeeper
Witnesses

RENEWAL

Monument Set: (Procedure and Description) _____

New Accessories: (Description) (continued from page 1)

Uprooted 28" D-Fir brs. N23°E, dist. 19.3' (to rootwad)

Original Corner Tree

40" uprooted D-Fir brs. N2°E, dist. 24.1' (to rootwad)

Location and Comments:

20°E

Compass Declination

Go up FS Rd. #23 approx.

U.S.F.S.

Agency

5.0 miles to location

Ernesto R. Alvarado

Party Chief

poster on North side of

E. R. Alvarado

Notekeeper

road. From poster, go

Elwin Price

Witnesses

North 10 chains to

corner, which lies on

North face.

ok
jem

T195R10W sec. 25 & 36

Referenced-out due
to Logging. The Landing
is just above the corner.
FD - corner Tree - uprooted
FD - Both BTs - uprooted

NW BT
40" D-Fir up-rooted
Brs N 20° E
Dist 24' ±
root wad

24
PC E.R.
E.L.

NW BT
determined center
of tree location
set 5' steel post
Brs N 30° W
Dist 4' ±

corner Tree
28" D-Fir uprooted
Brs N 230° E
Dist 19' ±
Root wad

SW BT
38 Hemlock
Brs N 89° W
Dist. 33' ±
Root wad

determined center of tree
location set 5' steel post
Brs S 82° W
Dist. 47' ±

Douglas County
B/C alongside

@ corner point
set 5' steel post
1 1/2 feet above
ground

43 He
Brs
Dist
RP 8
Bearing
to
hem

38" Hemlock
Brs S 74° W
Dist. 47' ±
RP 8" x 3/8 Nail
Bearing & Dist. to
top of Nail Head.

36" Hemlock stump
Brs S 41° W
Dist 45' ±
RP 8" x 3/8 Nail
Bearing & Dist. to
top of Nail head.

5
2
6
2
1
5

49+14.10 56+15.60 66+17.80

35 SE. 1/4, SEC. 34 T. 19S., R. 10W. NATIONAL FOREST 40 45 N.E. 1/4, SEC. 34 T. 19S., R. 10W. NATIONAL FOREST 50

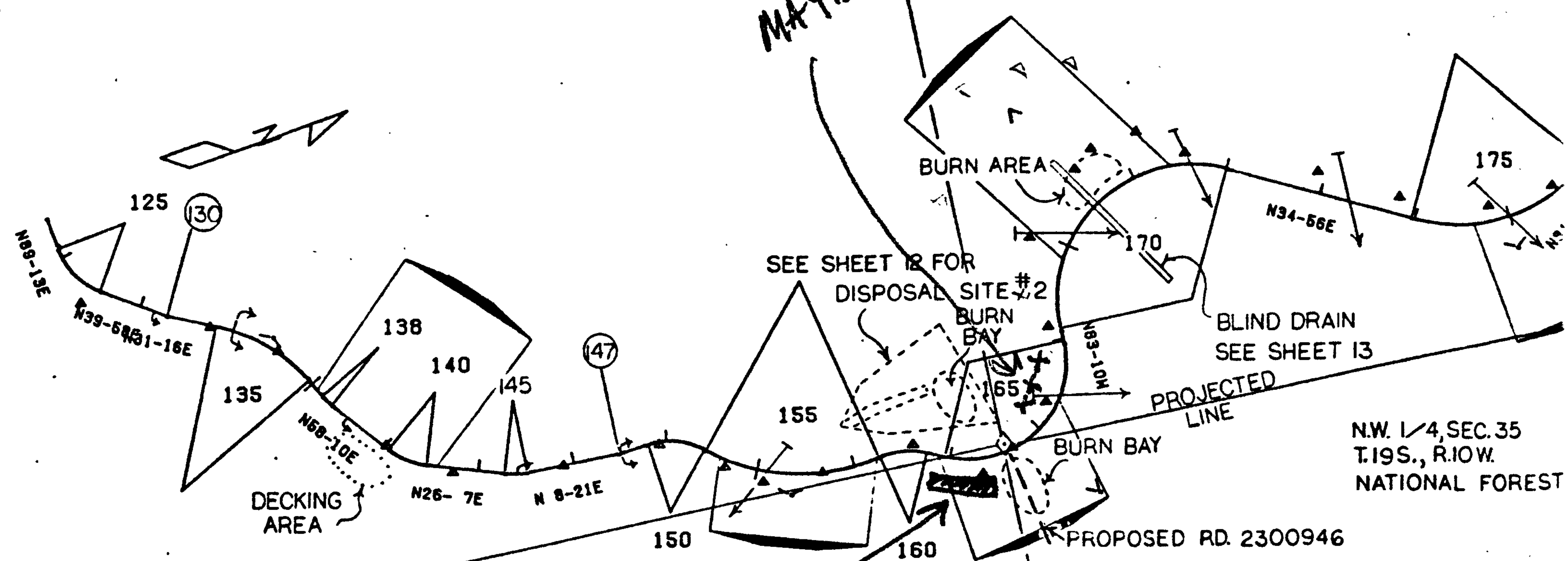

125	135	138	140	145	150	155	160
PI 32+23.89	PI 34+40.29	PI 35+24.07	PI 38+26.44	PI 37+38.91	PI 39+12.93	PI 40+41.79	PI 41+52.00
PC 31+89.51	PC 33+81.03	PC 35+17.17	PC 36+04.90	PC 37+27.19	PC 38+80.64	PC 39+43.67	PC 41+27.00
PT 32+53.98	PT 34+95.31	PT 35+30.94	PT 36+48.85	PT 37+50.45	PT 39+41.62	PT 41+26.12	PT 41+76.00
Δ 49-15 L	Δ 37-25 R	Δ 10-31 L	Δ 32-3 L	Δ 17-46 L	Δ 46-35 R	Δ 52-18 L	Δ 37-10
D= 76-23	D= 32-44	D= 76-23	D= 76-23	D= 76-23	D= 76-23	D= 28-38	D= 76-
L= 64.46	L= 114.27	L= 13.78	L= 41.94	L= 23.25	L= 60.98	L= 182.44	L= 48-
R= 75.00	R= 175.00	R= 75.00	R= 75.00	R= 75.00	R= 75.00	R= 200.00	R= 75-
E= 7.50	E= 9.76	E= -32	E= 3.03	E= .91	E= 6.66	E= 22.77	E= 4-
T= 34.37	T= 59.25	T= 6.89	T= 21.63	T= 11.71	T= 32.28	T= 98.11	T= 25-

4, SEC. 35 T. 19S., R. 10W. NATIONAL FOREST
 PI 33+28.56
 Δ 8-42L
 DOWN IN HERE SOMEPLACE ???

CLEARING ACRES 3.92 INCLUDES 0.36 ACRES FOR

