

DATE: May 7, 1984

Condition Report Only
 Not Found
 Renewed
 Unrecorded
 Surveyed In
 Referenced Out

Previous Renewal #'s 2429 T.19-10 ^{#2124 T.19-9} C.S. File #53/66

Monument(s) Found: (Condition and Source) The corner tree is uprooted
with brass cap at the base of tree, on the root-wad. September 9, 1982 ^{Ren. #29}
I referenced out the corner point from the up-rooted corner tree and
and uprooted BT's, so that the area could be logged. My reference
point is S11⁰E, Dist. 4⁶ feet from the center of the root hole.

Accessories Found: (Condition and Source) Both BT's up-rooted.

40" Douglas-Fir (uprooted) brs. N0¹/₂OW, Dist 19⁶' (to center of root-wad)
38" Hemlock (uprooted) brs. S86¹/₂OW, Dist. 48⁷' (to center of root-wad)

#36 T.19-94
#37 T.19-104

C.S. File No. 62/5-14

Page 1 of 1

C

RENEWAL

Ren. #2

Monument Set: (Procedure and Description) Reset old 1964 Douglas

County brass cap at the center of root hole, of the corner tree.

Cap marked: $\begin{array}{c} T19S \\ R \quad S25 \quad R \\ 10 \quad \text{---} \quad 9 \\ W \quad S36 \quad W \end{array}$

1964

Corner Tree root wad brs. N28-3/4°E, Dist. 152' (to center of rootwad)

New Accessories: (Description) Used the same stumps for BT's as previously used for reference points. Set 3/8" steel rebar on center of all three stumps and an 8"x3/8" nail facing the corner.

Bearings and distances are to the center rebar of the stumps.

43" Hemlock stump brs. N78-3/4°E, dist. 77⁵', scribed CSBT:

36" Hemlock stump brs. S44°W, dist. 50⁵', scribed T19S R10W S36 CSBT

38" Hemlock stump brs. S75°W, dist 51⁰⁵', scribed CSBT

(No stump available is Section 25)

Location and Comments:
Go up Rd. #23 approx.
5.0 miles to location
poster on Section Line
post on South side of
road. Corner lies
N1°E, dist. 580' on
N. slope North of
landing in clearcut.

20°E

U.S.D.A.-Forest Service,

Ernesto R Alvarado

David Braley - T.M.A.

Jennifer Hawks - Job Corps

Compass Declination

Agency Mapleton R.D.

Party Chief U.S.F.S.

Notekeeper Land Surveyor

Witnesses

ofw

May 7, 1984

① Reset old county
BRASS CAP AT THE
CENTER OF THE ROOT
HOLE OF THE COR. TREE.

② NO STUMP AVAILABLE
IN SECTION 25

③ Posted Boundary MAINTENANCE
HAVE BEEN DONE ON THE
PERIMETER OF SECTION 36.

40" D-Fix UP rooted
BYS $N0\frac{1}{2}^{\circ}$ W
Dist. 196
(To center ROOT WAD)

up-rooted Cor. Tree
28" D-Fix
BYS $N28\frac{3}{4}^{\circ}$ E Dist. 152
(TO CENTER OF ROOT WAD)

0719
38" Uprouted Hemlocks
BYS. $S86\frac{1}{2}^{\circ}$ W
Dist. 48 7

3/8 Rebar on center
38" Hemlock stump
BYS $S75^{\circ}$ W
Dist. 51 05
scribed CSBT

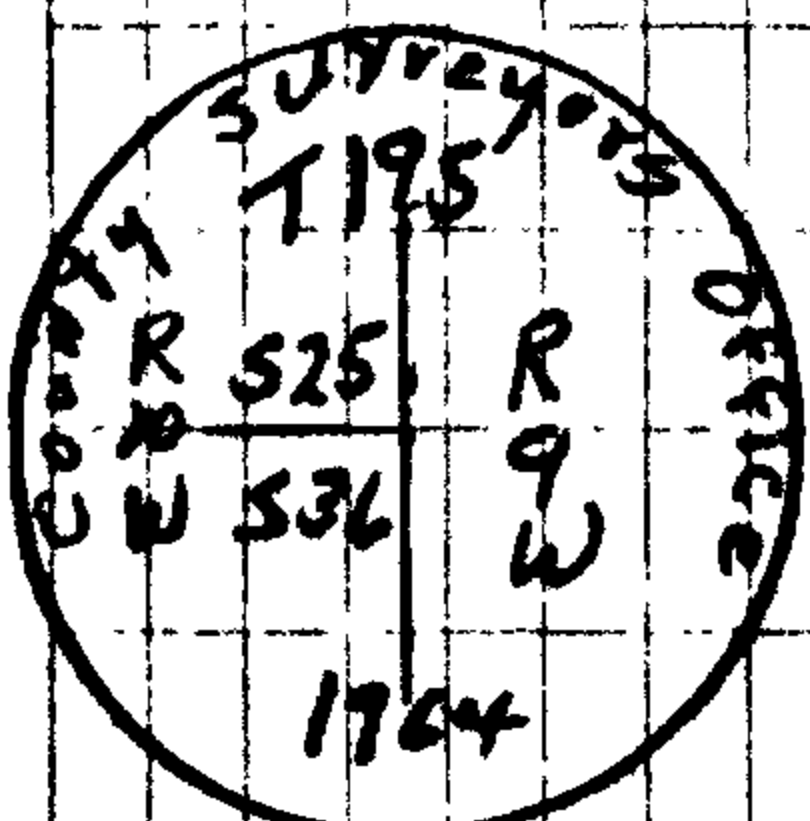

3/8 Rebar on center
36" Hemlock stump
BYS. $S44^{\circ}$ W
Dist. 50 5
scribed T195 R10W
S-36 CSBT

[* old Referenced Point
BYS. $S11^{\circ}$ W Dist. 46]

Location: Go up North Fork
Road #23 Approx 2.7 mile from
junction with Road #48; then
go to the NE Landing, then
CORNER LAY APPROX 200ft
North of the Landing.

F. R. ALVARADO P.C.

Witnesses:
DAVID BRALCY TMA
JENNIFER HAWK
Job Corps.

C.S. File No. 62/15-14