

GOVERNMENT CORNER RESTORATION FORM

FILED RECEIVED

Township 31S Range R2W Sec. 35 County DOUGLAS
 State OREGON Date 17 DEC. 84 No. _____

DEC 31 1984

DOUGLAS COUNTY SURVEYOR
 DOUGLAS COUNTY, OREGON

Corner Designation

CW 1/16 CORNER

Condition Report Only
 Not Found
 Renewed
 Unrecorded
 Surveyed In
 Referenced Out

Previous Renewals M42-72

MONUMENT DETAIL

Monument(s) Found: (Condition and Source)

AFTER MUCH SEARCH AND DIGGING, I DO NOT LOCATE IRON PIPE WITH BRASS CAP SET BY WILLIAM S. BARNES, P.E. 2128, IN 1972. I FIND OLD BENT STEEL GUARD POST OUT OF THE GROUND. BARNES NOTES INDICATE CORNER WAS SET IN EAST DITCH OF ROAD, AND IT APPARENTLY HAS BEEN DESTROYED BY ROAD MAINTAINENCE.

RECORD DISTANCES OF BARNES 2 BTS DONT INTERSECT. I MEASURE BETWEEN THE 2 BTS AND FIND THEM TO BE 1227 FT. APART (VS. 1218 FT - THE SUM OF BARNES RECORD BT DISTANCES). I ASSUME THE LONGER BT DISTANCE TO BE IN ERROR, BECAUSE THE SHORTER BT DISTANCE IS COMPATABLE WITH THE RECORD BT BEARINGS. I DETERMINE THE CORNER POINT TO BE THE INTERSECTION OF THE RECORD BEARING AND DISTANCE FROM THE NE BT AND THE RECORD BEARING FROM THE SW BT. THE CORNER POINT FALLS IN THE DITCH. THE BEARINGS AND DECLINATION WERE DETERMINED BY BACKSIGHTING ON A STEEL PROPERTY POST, WITH USFS SIGN #54-2 ATTACHED, (300 FT±) SET BY BARNES IN 1972 WITH A BEARING OF N010'E (M42-72).

Accessories Found:

BTS BY BARNES IN 1972:
 A 10" D. FIR, N47°E, 90 FT., WITH SCRIBE MARKS "CW 1/16 S35 PE 2128 BT" VISIBLE ON PARTIALLY HEALED DOUBLE BLAZE.
 A 14" I. CEDAR, S81°W, 1153 FT. (REC. 1128 FT.), WITH SCRIBE MARKS "CW 1/16 S35 PE 2128 BT" VISIBLE ON PARTIALLY HEALED DOUBLE BLAZE.

RENEWAL

Monument Set (Procedure and Description)

AT CORNER POINT I DRIVE A 6 FT STEEL FENCE POST 3 FT. IN THE GROUND WITH USEFS SIGNS #54-2 AND #54-9 ATTACHED.

Monument Detail

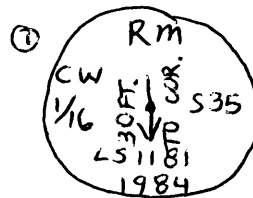

New Accessories

I SET 2 REFERENCE MONUMENTS, EACH 2 1/4" OUTSIDE DIAMETER IRON PIPE, 30" LONG, SET 30" IN A 2 FT. DIAMETER MOUND OF STONE.

1) BEARS NORTH, 30° FT., WITH A 6 FT. STEEL FENCE POST SET 2° FT. SOUTH OF RM WITH USEFS SIGNS #54-2 & #54-9 ATTACHED, AS GUARD POST.

2) BEARS EAST, 15° FT., WITH A 6 FT. STEEL FENCE POST SET 2° FT. EAST OF RM WITH USEFS SIGN #54-9 ATTACHED, AS A GUARD POST.

BRASS CAPS ARE MARKED AS SHOWN ABOVE.

ALSO SET A 4" X 4" WOOD POST, 6 FT. LONG, 2 FT. IN GROUND, 7° FT. NORTH, ~~OF CORNER~~ WITH USEFS SIGNS #54-2 AND #54-6 ATTACHED.

Sketch of Monument, Accessories, and General Area

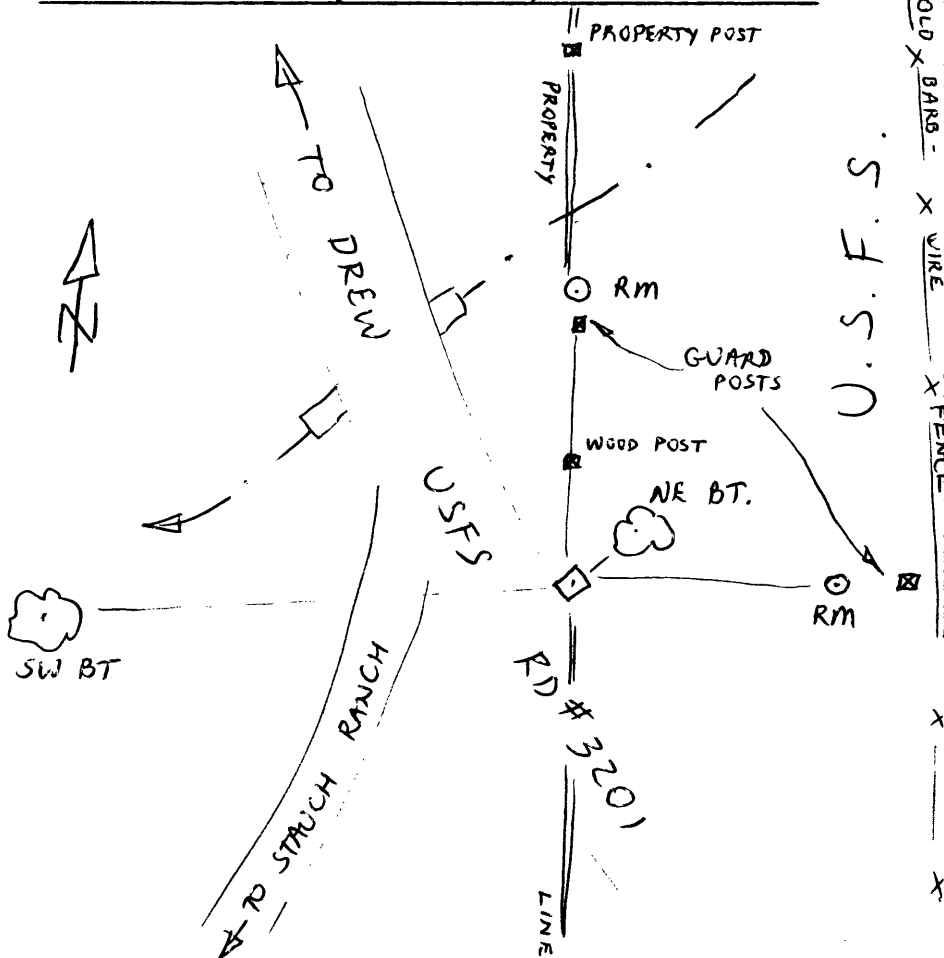

Location & Comments

CORNER IS 4° MILES ON USFS RD. # 3201 FROM STATE HIGHWAY 227. AND IS 40 FT. ± SOUTH OF SEASONAL CREEK. ALSO AT JUNCTION TO ROAD TO STAUCH RANCH

Comp. Declin. 19 1/2° E
 Agency U.S. FOREST SERVICE
 Party Chief LEONARD HERZSTEIN
 Notekeeper LEONARD HERZSTEIN
 Witnesses RANDY LOPEZ

Surveyor's Seal

REGISTERED
 PROFESSIONAL
 LAND SURVEYOR

Maurice E. Farr

OREGON
 SEPT 23, 1977
 MAURICE E. FARR
 1181

12/21/84