

GOVERNMENT CORNER RESTORATION FORM

Township 30 S Range 6 W Sec. 36 County DOUGLAS

State OREGON Date 7-22-83 No. _____

Corner Designation

$\frac{1}{4}$ $\frac{S36}{S1}$

#1, 61, 141 T31-6

Previous Renewals (FB 109 PGS 2, 49, 54) # 8, 42, 230 T30-6

Monument(s) Found: (Condition and Source)

1983 BLM BRASS CAP MONUMENT SET IN STUMP OF FIR MARKED BY CAIN IN 1921 WITH $\frac{3}{4}$ " IP SET BY WENDEROTH ALONG WEST SIDE OF STUMP. BLM CAP IS MARKED AS NOTED

FROM WHICH DOUGLAS CO. SURVEYORS 1979 (REN # 230) IRON PIPE AND BRASS CAP BEARS S $40\frac{1}{2}^\circ$ E 15 $\frac{3}{4}$ FEET.

Accessories Found:

22" FIR BEARS S 36° W 26 $\frac{1}{2}$ FT TREE IS SINGLE BLAZED AND SCRIBED "X 51 BT".

5" FIR BEARS N 23° E 15 $\frac{1}{2}$ FT TREE IS SINGLE BLAZED AND SCRIBED "X 336 B".

- _____ Condition Report Only
- _____ Not Found
- Renewed
- _____ Unrecorded
- _____ Surveyed In
- _____ Referenced Out

MONUMENT DETAIL

T 30 S R 6 W

$\frac{1}{4}$ $\frac{S36}{S1}$

T 31 S R 6 W
1983

#239 T30-6 ✓
#157 T31-6 ✓

G.L. No. 62/9-24 C

RENEWAL

Monument Set (Procedure and Description)

WE REMOVE THE BRASS CAP FROM THE 1" IRON PIPE SET BY THE COUNTY SURVEYOR IN 1979 AND PLACE A YELLOW PLASTIC CAP MARKED DOUG. CO. SURVEYOR IN THE PIPE FOR IDENTIFICATION PURPOSES.

Monument Detail

New Accessories

WE REMOVE SCRIBING AND TAGS FROM TREES NOTED IN RENEWAL #230 (1979 DCSD TREES) AS NOTED. BEARINGS AND DISTANCES TO THE FOLLOWING DECEASED TREES FROM 1979 DCSD MON.
 16" FIR BEARS WEST 26 1/2 FT.
 10" MADRONE BEARS N 66 1/2° W 45 3/4 FT.
 12" FIR BEARS N 40° E 32 2 FT.
 18" FIR BEARS S 8° E 34.6 FT.
 THE TWO BLM BT'S REFERENCING THE 1983 BLM CAP ARE NOW LEFT IN TAG.

Sketch of Monument, Accessories, and General Area

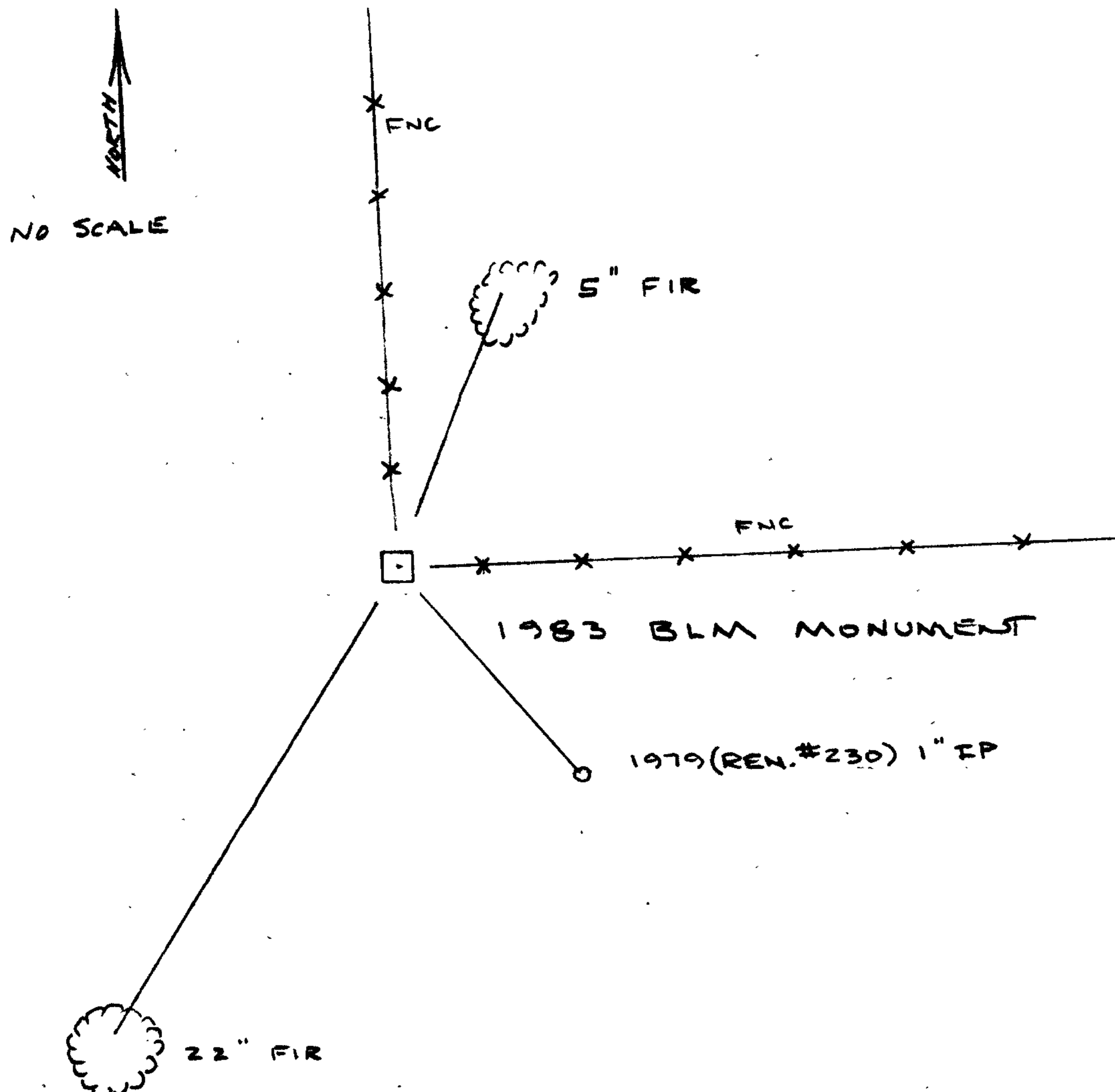

Location & Comments

Comp. Declin. 19° EAST
 Agency DOUGLAS COUNTY SURV. OFF.
 Party Chief LARRY E. MONREAN
 Notekeeper " " "
 Witnesses JM POWELL

Surveyor's Seal

REGISTERED
 PROFESSIONAL
 LAND SURVEYOR

Larry E. Monrean

OREGON
 JULY 13, 1979
 LARRY E. MONREAN
 #1830