

GOVERNMENT CORNER RESTORATION FORM

Township 30 S Range 3 W Sec. 35 County DOUGLAS

State OREGON Date 7-11-83 No. _____

Corner Designation

T 30 S R 3 W
S 1/4 SECTION 35

- Condition Report Only
- Not Found
- Renewed
- Unrecorded
- Surveyed In
- Referenced Out

Previous Renewals 60 & 180

MONUMENT DETAIL

Monument(s) Found: (Condition and Source)

ORIGINAL HEMLOCK CORNER TREE IS DOWN AND ROTTED - REMAINS OF TRUNK SHOW SIGNS OF A HEALED BLAZE (NO SCRIBING VISIBLE) ALSO FOUND A 1952 LOCATION POSTER, ON DECAYED TRUNK.

FROM THE CENTER OF THE DECAYED STUMP A 1 1/2" DIA. IRON PIPE (REN. NO. 60) BEARS N 15° E 10 FEET.

ALSO FOUND 1" IRON PIPE WITH GRASS CAP (NOT MARKED AS SHOWN AT RIGHT) SET IN REN. #180 IS ALONG NORTHERLY SIDE OF IRON PIPE.

COUNTY SURVEYORS OFFICE

T 30 S R 3 W

1/4 S 35

T 31 S

1965

Accessories Found:

REN. #60

1. 28" CEDAR NOW A DECAYED STUMP WITH SCRIBING "S2 TREE" VISIBLE BEARS S 29° E 37 1/2 FT FROM 1 1/2" IP (REC. S 33 E 37 1/2 REN #60 & S 30° E REN #180)
2. A HEMLOCK 18 NOW 20 INCH DIA WITH HEALED BLAZE BEARS N 28° W 40 1/2 FEET (REC. N 30° W 40 1/2 FT REN. #60 AND N 33° W REN. #180) FROM THE 1 1/2" IRON PIPE REN. #180
3. A HEMLOCK 5" NOW 9" DIA. WITH WELL HEALED BLAZE BEARS N 58° E 24 1/2 FT (REC. N 57° E 24 1/2 FT) FROM THE 1 1/2" IRON PIPE.

#225 T 30-3 X
#253 T 31-3 X

C. S. File No. 12/9-21

RENEWAL

Monument Detail

Monument Set (Procedure and Description)

AS THE IRON PIPE (1 1/2" DIA.) FROM RENEWAL #60 IS FIRMLY SET I LEAVE IT IN POSITION OF THE WITNESS CORNER. I REMOVE THE FOUND 1" DIAMETER X 36" IRON PIPE WITH ATTACHED BRASS CAP (REN. #180). AS THIS MONUMENT IS IN GOOD CONDITION I SET ~~THE~~ IT IN THE TRUE CORNER POSITION AND ADD THE FOLLOWING "RESET 1983"

New Accessories

6" DIA FIR DOUBLE BLAZED AND SCRIBED "S2 CS BT" BEARS S 37° E 10 1/2 FEET
8" DIA D. FIR DOUBLE BLAZED AND SCRIBED "S2 CS BT" BEARS S 23 1/2° W 13 1/2 FEET
NEW BEARINGS AND DISTANCES TO BT'S FROM PREVIOUS RENEWALS
20" HEMLOCK (SEE FOUND ACC. #3; REN #60) BEARS N 26 1/2° W 40 1/2 FEET.
9" HEMLOCK (SEE FOUND ACC. #3; REN #180) BEARS N 56 1/2° E 24 1/2 FEET.

Sketch of Monument, Accessories, and General Area

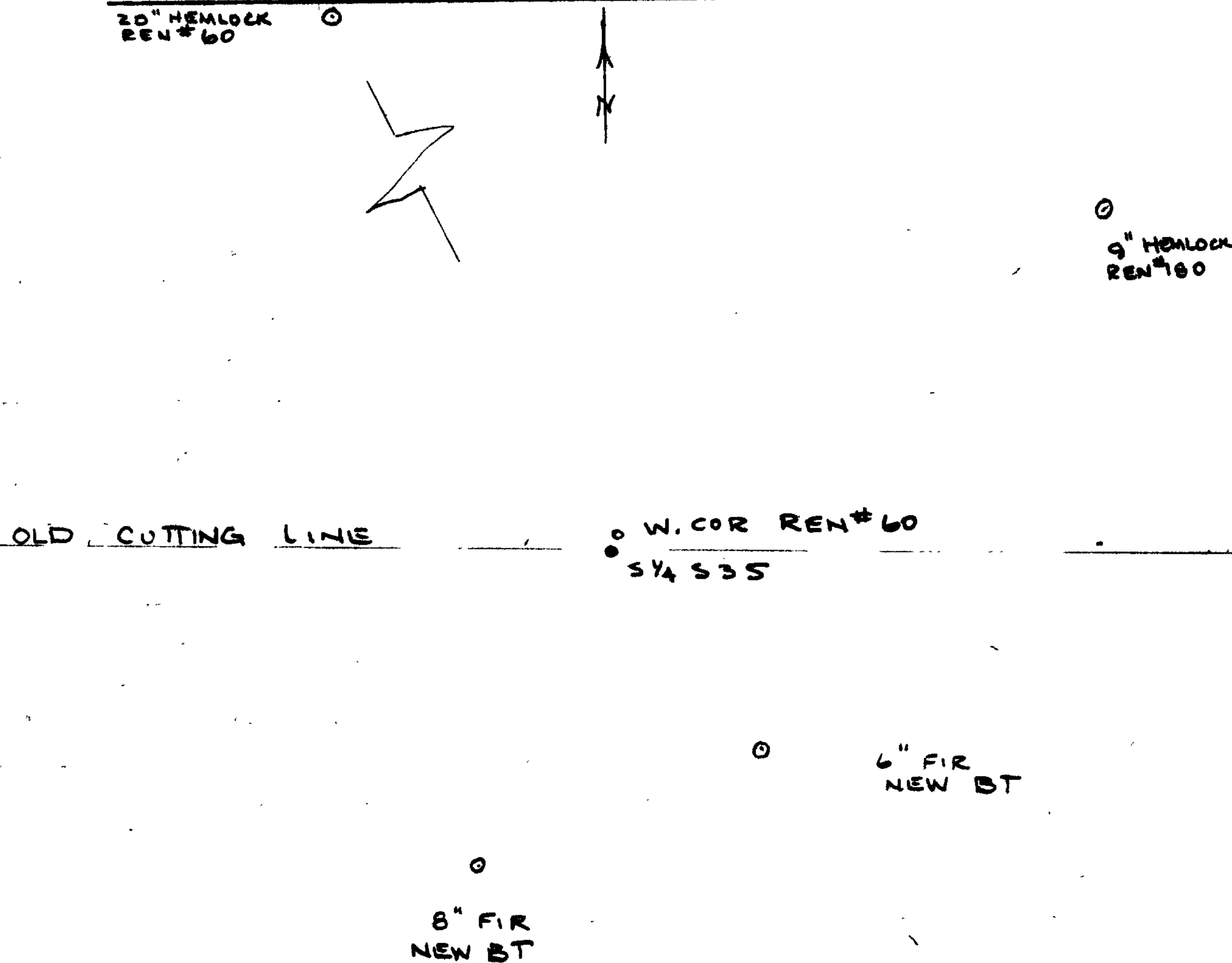

NO SCALE

Location & Comments

THIS CORNER LIES IN E-W CUTTING LINE (TIMBER TO THE NORTH) APPROX 400 FT WEST OF ROAD

Comp. Declin. 19° EAST
Agency DOUGLAS CO. SURVEYOR'S OFF.
Party Chief LARRY E. MONREAN
Notekeeper Larry E. Monrean
Witnesses J. M. Powell
7-11-83

Surveyor's Seal

REGISTERED
PROFESSIONAL
LAND SURVEYOR

Larry E. Monrean

OREGON
JULY 13, 1979
LARRY E. MONREAN
#1839