

GOVERNMENT CORNER RESTORATION FORM

Township 26 S Range 7 W Sec. 24 County DOUGLAS

State OREGON Date 6-10-83 No. _____

Corner Designation SECTION 24

NE COR.
DLC 46

- _____ Condition Report Only
- _____ Not Found
- Renewed
- _____ Unrecorded
- _____ Surveyed In
- _____ Referenced Out

Previous Renewals 15, 41, & 104

Monument(s) Found: 41 (Condition and Source)
IN 1960 (REN. #15) BYRON FOUND EVIDENCE OF
THE NE CORNER OF DLC 46. BYRON SET A WITNESS
CORNER 88' FT. WEST. WE FIND BYRON'S CAP OUT
OF GROUND AND LEANING AGAINST A BEARING
TREE. MONUMENT IS 1" X 36" IRON PIPE WITH BRASS
CAP STAMPED AS NOTED. WE DETERMINE POSITION
OF WITNESS CORNER FROM BEARING TREES AS
FOUND BELOW.

COUNTY SURVEYORS OFFICE
T 26 S R 7 W

TO
88' E
N.E. COR.
D.L.C. 46

WIT.
COR.

1960

Accessories Found:

REN. #41 - 34 NOW 36 INCH W. OAK WITH WELL HEALED
DOUBLE BLAZE BEARS N 69° W 5.0 FEET.

14" FIR NOW A 17" DIA. STUMP WITH LOWER PORTION OF WELL HEALED
BLAZE REMAINING BEARS S 5 1/2° W 34.5 FEET.

REN. #104 - A FIR 23 NOW 26 INCH DIA WITH WELL HEALED DOUBLE BLAZE BEARS
S 17 1/2° E 57.2 FEET (REC. S 18 1/2° E).

NOTE: FROM TEMPORARY POSITION OF WITNESS CORNER WE THEN MEASURE EAST 88 FT.
AND SET A TEMPORARY POINT FOR THE APPROXIMATE CORNER POSITION. FROM THIS
POSITION WE FIND A 48" DIA. B. OAK WITH A PREVIOUSLY OPENED BLAZE WITH
A BOTTED FACE. AS THE LAND OWNER DOES NOT WANT TO HAVE THE TREES
IN THIS AREA DEFACED WE DO NOT OPEN FOR SCRIBING. AS THIS TREE
FITS WELL FOR BEARING AND DISTANCE FROM OUR TEMPORARY CORNER POSITION
WE ACCEPT IT AS THE 1892 BRIGGS (REN #15 FB 4 PG 18) DT. WHICH
BYRON FOUND AND USED IN HIS RENEWAL #41. BY INTERSECTING DISTANCES
WE ARE ABLE TO DETERMINE A POSITION FOR THE N.E. CORNER OF DLC 46 FROM
WHICH

1. THE 48" B. OAK PER RENEWAL #15 BEARS S 34° W 132' FEET. (REC. S35W)
2. TEMPORARY POINT SET FOR WITNESS CORNER PER REN #41 BEARS S 89° W 88' FEET.
(REC. WEST)

#118 X

RENEWAL

Monument Set (Procedure and Description)

Monument Detail

AS THE POSITION OF THE WITNESS CORNER WILL FALL IN A DAM AND RESERVOIR AREA AND THE POSITION OF THE NE COR. DLC #46 FALLS IN AN AREA TO BE LANDSCAPED WE SET NO PERMANENT MONUMENT AT THE WITNESS CORNER OR THE DLC CORNER.

TO PERPETUATE THE CORNER WE REFERENCE THE NE COR. OF DLC #46 WITH 3 POSITIONS ON A HOUSE FOUNDATION AS NOTED BELOW IN SKETCH. THE LOCAL MAGNETIC ATTRACTION OF STRUCTURE PROHIBITS USE OF BEARINGS TO NEW ACCESSORIES IN THIS REPORT.

New Accessories

Sketch of Monument, Accessories, and General Area

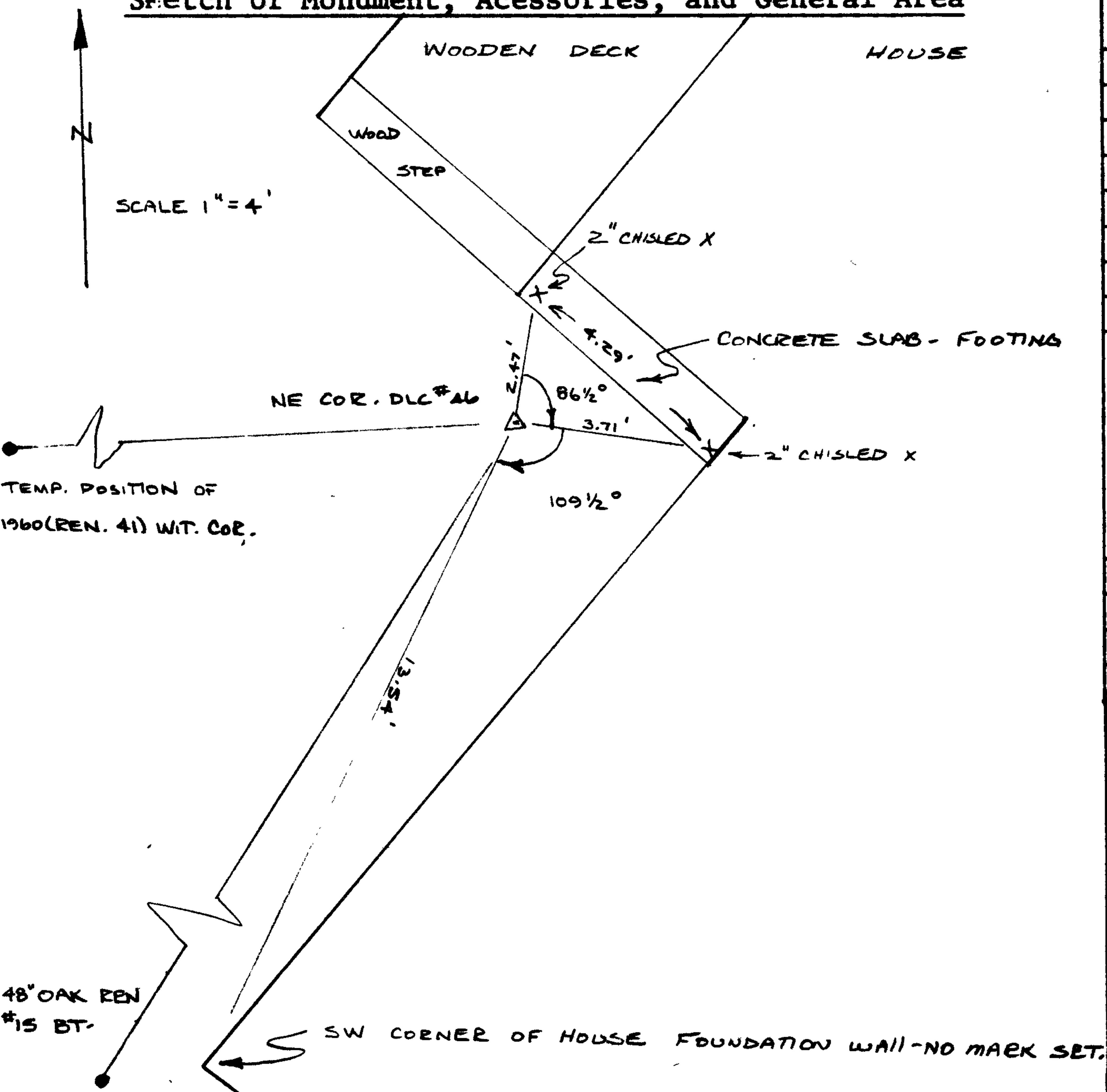

Location & Comments

Comp. Declin. 19° EAST
Agency DOUGLAS Co. SURVEYORS OFFICE
Party Chief LARRY E. MONREAN
Notekeeper Jerry E. Monrean
Witnesses J. R. LUNDEEN

Surveyor's Seal

REGISTERED
PROFESSIONAL
LAND SURVEYOR

Jerry E. Monrean

OREGON
JULY 13, 1979
LARRY E. MONREAN
#1830