

GOVERNMENT CORNER RESTORATION FORM

Township 24 S Range 1 W Sec. 28 County DOUGLAS

State OREGON Date 9-28-63 No. _____

Corner Designation

$\frac{1}{4}$ $\frac{S 28}{S 33}$

- _____ Condition Report Only
- _____ Not Found
- Renewed
- _____ Unrecorded
- _____ Surveyed In
- _____ Referenced Out

MONUMENT DETAIL

Previous Renewals # 23

Monument(s) Found: (Condition and Source)

FOUND IRON PIPE WITH BRASS CAP PER RENEWAL #23 MARKED AS NOTED.

ALSO FOUND ORIGINAL STONE WITH PORTION OF MARK "1/4" REMAINING ON EASTERLY FACE. STONE IS ON SOUTHERLY EDGE OF BRASS CAP MONUMENT.

COUNTY SURVEYORS OFFICE
T 24 S R 1 W

$\frac{1}{4}$ $\frac{S 28}{S 33}$
1962

Accessories Found:

ORIGINAL 12" FIR NOW AN 18" DIAMETER 5 FOOT HIGH STUMP BEARS N 38° E 112 FEET, (REC. PER ORIG N 41 1/2° E 113, REC. PER REN. #23 N 41 1/2° W). STUMP HAS TWO HEALED BLAZES.

ORIGINAL 12" FIR NOW 22" DIA. WITH WELL HEALED BLAZE BEARS S 7° W 16³ FEET (ORIG. REC. S 8° W 17⁸ FEET, REC. PER REN #23 16⁸ FEET).

#141 X

C & File No. 62/9-7 C

RENEWAL

Monument Set (Procedure and Description)

Monument Detail

NONE

New Accessories

SET A 1/2" x 8" SPIKE IN TOP OF AN 18" DIA. FIR STUMP BEARS N 52° W 9⁷ FEET, SPIKE SET THROUGH A "DOUGLAS COUNTY SURVEYORS OFFICE" BEARING TREE TAG.

18" D. FIR DOUBLE BLAZED AND SCRIBED "4533 CS BT" BEARS S 60° E 16² FEET

Sketch of Monument, Accessories, and General Area

Location & Comments

CLEAR CUT

- - FOUND IRON PIPE & BRASS CAP, ORIG. STONE
- - FOUND ORIG. BT AS NOTED
- - NEW REF. AS NOTED

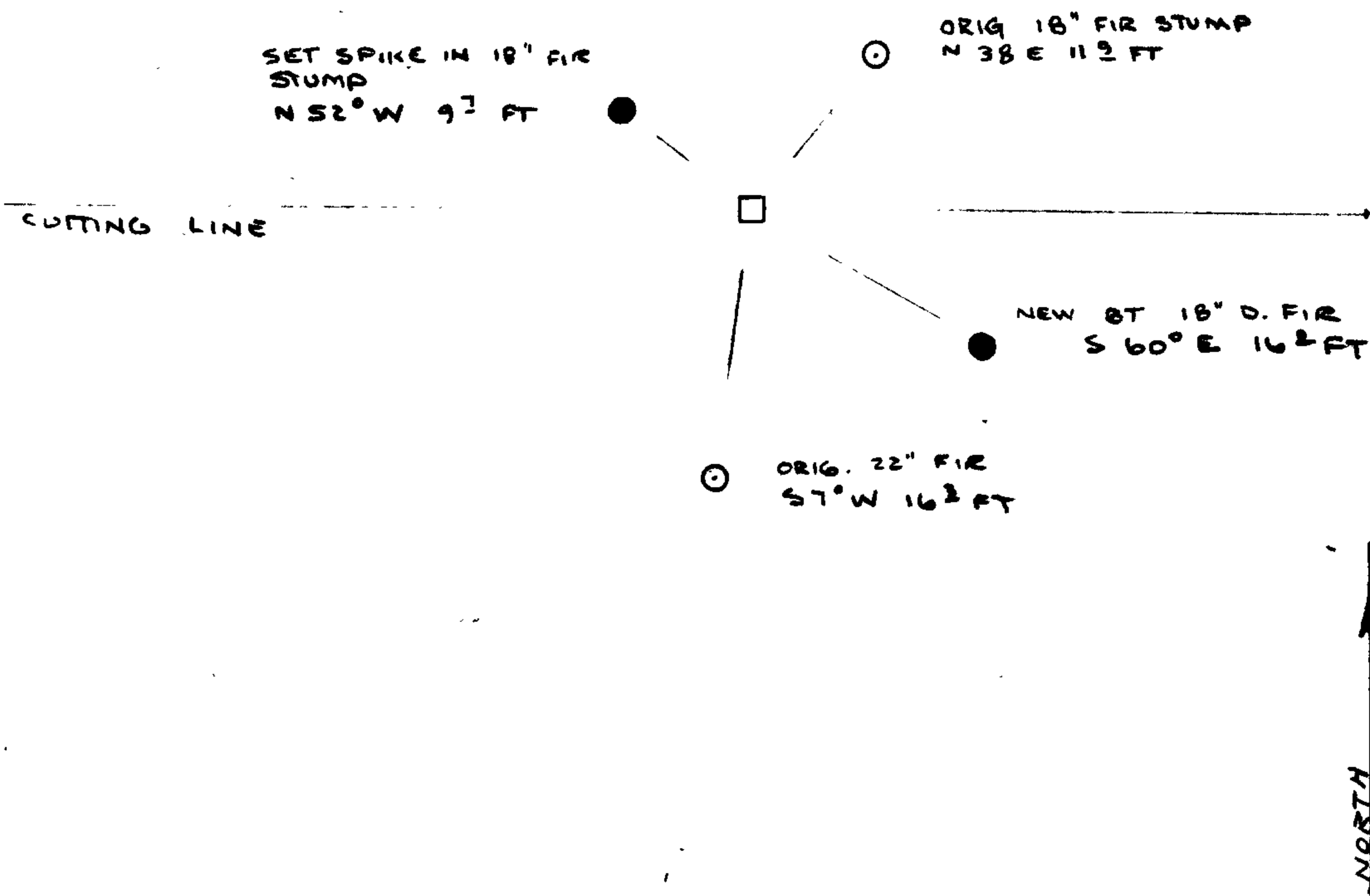

THIS CORNER LIES ON AN EAST SLOPE, IN AN E-W CUTTING LINE CLEAR CUT TO THE NORTH.

IT APPEARS THE CORNER IS APPROX 50' ABOVE ORIGINAL DRY CREEK BED TO THE EAST AND 200 FEET ± BELOW RIDGE CALL TO THE WEST.

Comp. Declin. 19° EAST

Agency DOUGLAS CO. SURV. OFF.

Party Chief LARRY E. MONREAN

Notekeeper " " "

Witnesses J. R. LUNDEEN, J. POWELL

Surveyor's Seal

REGISTERED PROFESSIONAL LAND SURVEYOR

Larry E. Monrean
OREGON
JULY 13, 1979
LARRY E. MONREAN
#1830