

GOVERNMENT CORNER RESTORATION FORM

Township 24S Range 1W Sec. 31 County DOUGLAS

State OREGON Date 10/18/83 No. _____

Corner Designation

1/4 S31/S32

- Condition Report Only
- Not Found
- Renewed
- Unrecorded
- Surveyed In
- Referenced Out

Previous Renewals # 102

Monument(s) Found: (Condition and Source)

FOUND IRON PIPE WITH BRASS CAP
PER RENEWAL # 102 MARKED AS NOTED
PROTRUDING 18" ABOVE GROUND.

NOT FOUND: ORIGINAL BASALT CORNER
STONE

COUNTY SURVEYORS OFFICE

T245

1/4 S31/S32

RIW
1970

Accessories Found:

ORIGINAL
ORIGINAL 10" FIR NOW 26" DIAM. BEARS N52°W 11.2 FT.
PARTIALLY HEALED ALAZE WITH SCRIBING VISIBLE PER RENEWAL #102

NOT FOUND ORIGINAL 16" CEDAR BT

FROM RENEWAL #102

A 42" FIR STUMP BEARS N11°E 55.8 FT (REC. 57.1 FT.)
NO SCRIBING VISIBLE

#146 X

G.S. No. 62/70

RENEWAL

Monument Detail

Monument Set (Procedure and Description)

MONUMENT WAS PROTRUDING 18" ABOVE GROUND ON STEEP ROCKY HILLSIDE WE MADE A MOUND OF ROCKS APPROX. 5'x4' AROUND MONUMENT TO PROTECT IT.

New Accessories

SET A 2"x1/2" SPIKE IN A 42" FIR STUMP, BEARS N 11° E 55.0 FEET, SPIKE SET THROUGH A "DOUGLAS COUNTY SURVEYORS OFFICE" BEARING TREE TAG IN PITCH RING OF STUMP (STUMP IS BEARING TREE FROM RENEWAL #102)

A CHISELED "X" IN FACE OF ROCK BLUFF, BEARS S 48° W 14.5 FEET.

Sketch of Monument, Accessories, and General Area

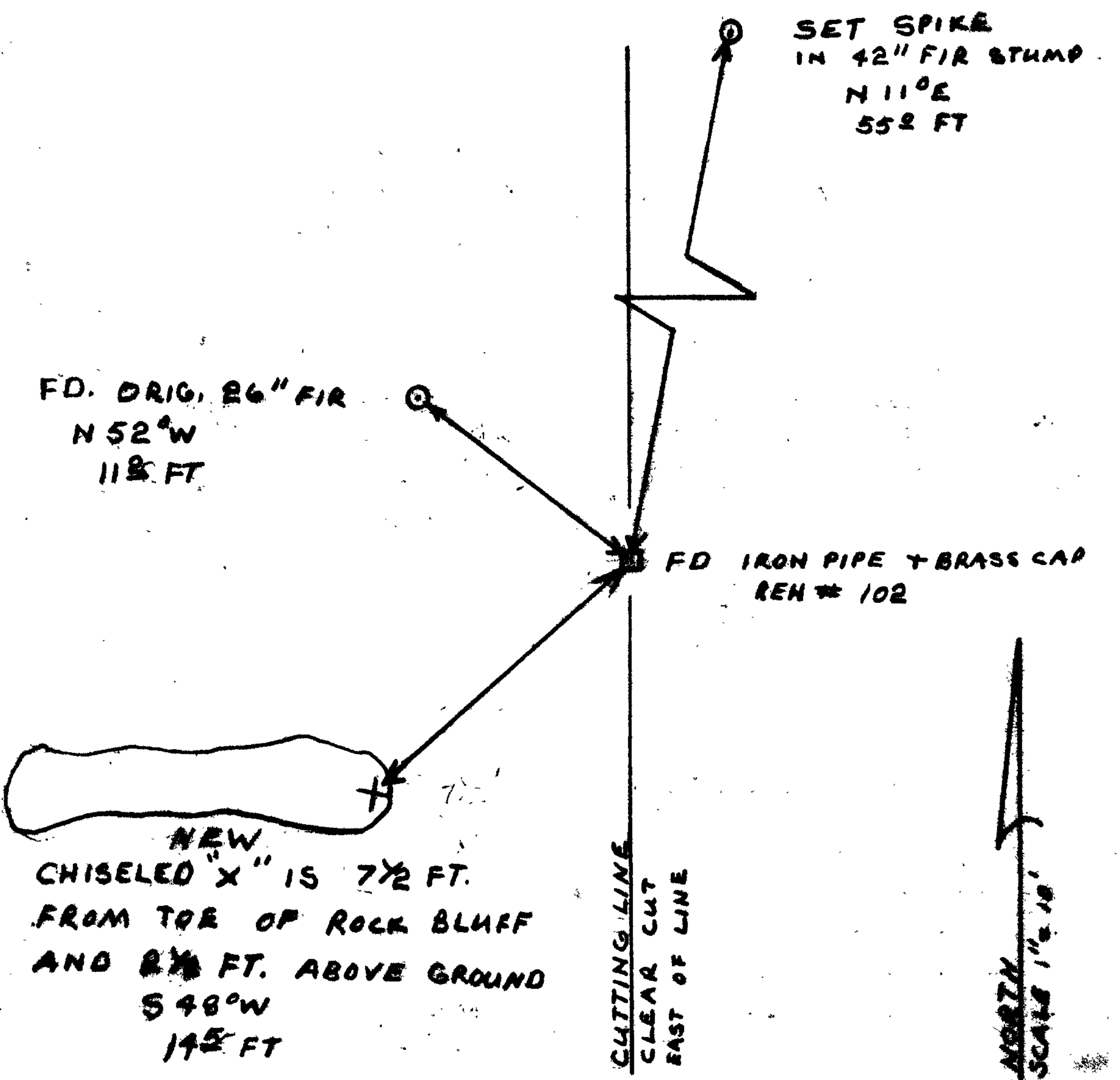

Location & Comments

CORNER LIES ON STEEP EAST SLOPE APPROX. 300' EAST OF BLM. RD. # 25-1-5.4. CORNER LIES IN CUTTING LINE A CLEAR CUT IS TO THE EAST OF CORNER.

Comp. Declin. 19° EAST
Agency DCSO
Party Chief LARRY E. MONREAN
Notekeeper Harold W. Smith
Witnesses _____

Surveyor's Seal

REGISTERED PROFESSIONAL LAND SURVEYOR

Larry E. Monrean
OREGON
JULY 13, 1979
LARRY E. MONREAN
#1830