

GOVERNMENT CORNER RESTORATION FORM

Township 23S Range 8W Sec. 3 County DOUGLAS

State OR. Date 1-13-83 No. \_\_\_\_\_

Corner Designation

T 23S R 8W

1/4 S3 |

- Condition Report Only
- Not Found
- Renewed
- Unrecorded
- Surveyed In
- Referenced Out

Previous Renewals #89, 1967 RESURVEY, M90-29

Monument(s) Found: (Condition and Source)

FD. 1" IP WITH BRASS CAP ATTACHED  
PER REN. #89.

MONUMENT DETAIL

COUNTY SURVEYORS OFFICE  
T 23S  
1/4 S3 | S2  
BLM  
1967  
R 8W  
1967

Accessories Found:

FD. ORIG. 12" CEDAR, NOW 44" WITH GOOD SCAR, BEARS  
S 2°W 38 3/4 FT.

FD. ORIG. 50" FIR, NOW 59" WITH BARK SCRIBED YAS VISIBLE,  
BEARS S 64°E 60 1/2 FT.

FD. 10" FIR PER REN. # 89, NOW 13" WITH GOOD SCAR, BEARS  
S 29°E 25 1/2 FT.

#128 ✓

G. L. No. 62/7-2  
c

RENEWAL

Monument Set (Procedure and Description)

Monument Detail

SINCE THIS COR. IS THE 1/4 COR  
TO SEC. 3 ONLY I "X" OUT THE  
"S2" WHICH WAS STAMPED ON THE  
CAP IN 1967.

SURVEYORS  
COUNTY T23S  
OFFICE 1/4 S3 XXX  
BLM  
1967  
R8W  
1967

New Accessories

Sketch of Monument, Accessories, and General Area

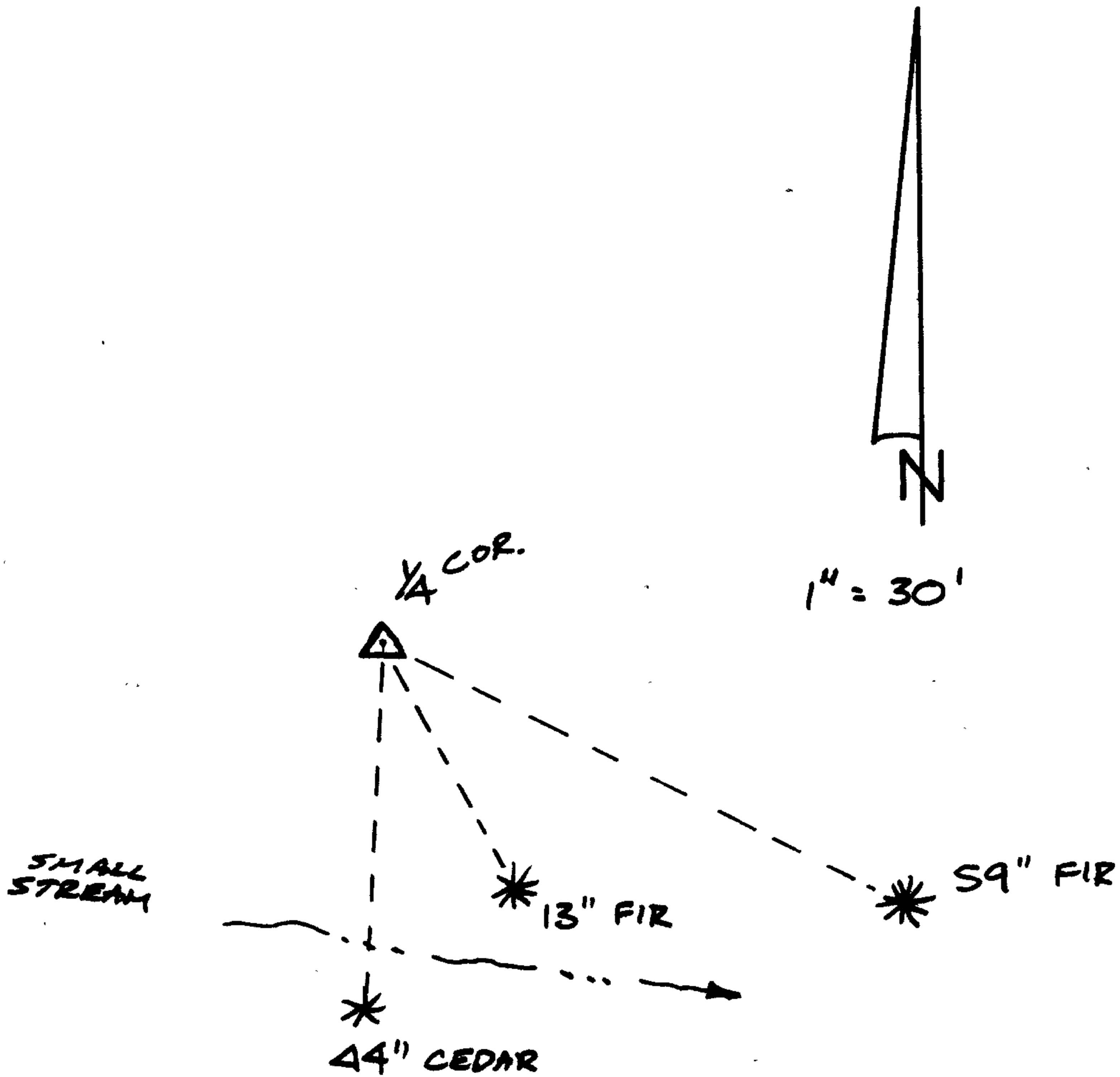

Location & Comments

NEWLY BLAZED LINE RUNS  
NORTH & SOUTH FROM COR.

Comp. Declin. 19° E  
Agency DCSO  
Party Chief GREGORY E. QUIBELL  
Notekeeper Gregory E. Quibell  
Witnesses JOHN POWELL  
RANDY SMITH

Surveyor's Seal

REGISTERED  
PROFESSIONAL  
LAND SURVEYOR  
*Gregory E. Quibell*  
OREGON  
JULY 13, 1979  
GREGORY E. QUIBELL  
1834