

FRANCIS L. (Fritz) INGRAM
COUNTY SURVEYOR

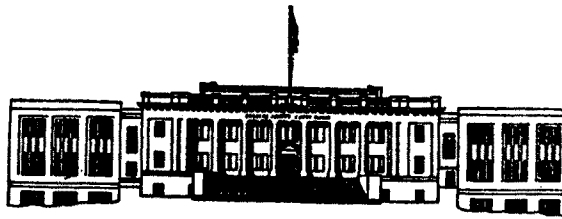

COUNTY OF DOUGLAS

OFFICE OF THE SURVEYOR
ROOM 205 - JUSTICE BUILDING
ROSEBURG, OREGON 97470

FILED ✓ TELEPHONE 672-3311
RECEIVED EXTENSION 272
SEP 23 1982
COUNTY SURVEYOR
DOUGLAS COUNTY, ORE

September 22, 1982

It has been brought to the attention of the Douglas County Surveyor that an uncertainty exists concerning the position of the quarter corner to Sections 5 and 4, Township 29 South, Range 7 West. This is shown on a 1973 survey by Glen Baughman, file number RM2-46 of the Douglas County Surveyor's Office.

The enclosed information has been gathered and filed for future reference.

A handwritten signature in cursive script that reads "Larry E. Monrean".

Larry E. Monrean
Survey Supervisor

C. S. File No. 62/3

T 29 S R 7 W

1/4 5 | 4

ORIGINAL 1854

RENEWAL # 3 N.E. RICHARDSON (3 DATE) NOT ABLE
TO LOCATE SOURCE OF TYPED INFORMATION.
CS 37/113 BBI 1927

RM 2-46-REN# 204 BAUGHMAN 1973

BBI 1927 HAD WIT. TO SCRIBING IN ORIG. BT.
IF WE COULD PROVE RICHARDSON COR AT BBI
LOCATION (EITHER BY ORIG BT, RENEWED BT, OR
MARKED STONE) IT MAY BE CONSIDERED THE CORNER
POSITION.

62/3

County Surveyor's Record, Douglas County, Oregon
1854

653
6539
23

Subdivision, of T. 29 S., R. 7 W.

WEST COAST PRINTING & BINDING CO., PORTLAND 18785

CHAINS

Va. 18°20'E.

East, on Random, between secs. 4 and 9.

- 40.00 Set temporary $\frac{1}{4}$ sec. post.
- 80.68 Intersect East boundary, 70 lks. North of sec. corner.
N89°30'W., on true line, between secs. 4 and 9.
- 2.00 Began to ascend small ridge, Course N. and S.
- 5.00 Top of ridge. + 30
- 20.00 Foot of hill - 50
- 30.00 Entered prairie bench land. Level
- 40.34 Set $\frac{1}{4}$ post sec., at average distance, from which,
A B. Oak, 16 ins. diam., bears S.62°W., 212 lks. dist.
A W. Oak, 10 ins. diam., bears N.83 $\frac{1}{2}$ °W., 213 lks. dist.
- 47.00 Creek bottom. - 8
- 51.00 Ten Mile Creek, Course NE.
- 54.00 Entered brush of left bank of creek.
- 60.00 Entered level prairie. Level
- 80.68 To sec. corner. Level
- I. S. Wells house, S.58 $\frac{1}{2}$ °W.
Soil, bottom land, first rate, rolling second rate.
Timber, Oak, Fir, Pine and Alder.

North, on Random, between secs. 4 and 5.

- 40.00 Set temporary $\frac{1}{4}$ sec. post.
- 81.15 Intersect North boundary, 70 lks. East of sec. corner.
S.00°30'E., on true line, between secs. 4 and 5.
- 5.00 Began to descend hill.
- 41.15 Set $\frac{1}{4}$ sec. post, at average distance, from which, - 75
A B. Oak, 12 ins. diam., bears S.25°W., 115 lks. dist. ^{75²}
A B. Oak, 10 ins. diam., bears N.63°E., 75 lks. dist. ^{49⁵}
- 81.15 To sec. corner. - 50
- Soil, first $\frac{1}{2}$, high rolling prairie land; second, Oak openings, second rate.

CLENN 62/3

Douglas County Surveyor's Record of Government Corners Renewed

29 T. S. 7 R. W. W. M.

KORE-CHAPMAN CO., EUGENE, ORE. 81082

N. E. Richardson
 Dep. Co. Surveyor
 Wit.
 E. S. Woodford

J. C. Stewart
 Wit.
 Jas. Newland
 Jas. Williams
 Apr. 21, 1919

Nov. 8, 1922.
 Witnesses
 Harold Nichols
 S. McBee
 C. Crocker
 W. H. Coats

DEP.
 FOR
 B.T.

$\frac{1}{4}$ Cor. North side of Sec. 6
 Marked new B.T. 5" Ash N.9°30'W. 11.5 Ft.

101

Angle Point #4 D.L.C. 39
 Marked new B.T. 5" Pear Tree S.87°W. 29.9 Ft.

Cor. to Secs. 5-6-7-8
 New B.T. 12" W. Oak S.74°45'E. 22.6 Ft. 1924 BRASS CAP
SEE M 6-14

$\frac{1}{4}$ Cor. 5-4
 Replaced old stake with $\frac{1}{2}$ " Iron Rod In mound of Stone
 New B.Ts.
 18" W. Oak N.49°40'W. 192.5 Ft.
 36" W. Oak N.44°15'E. 50.5 Ft.

3

204

Angle Point #1 D.L.C. #44
 New B.T. 24" Fir N.11°30'E. 185.9 Ft.

#27 OUT
 REF. FOR WORK DONE SURVEYOR C.S. 59/30
 DATE 10/20/01

CORNER BETWEEN 4, 5, 8 & 9.
 From stump of an Oak located as a witness tree
 Fred Byron, run S.4°E., 60' to set post and steel rifle
 barrel for corner from which (new trees)
 A Red Fir 14" dia. bears N.10°E., 297 lks.
 A W. Oak 24" dia. bears N.20°E., 650 lks.
 No other trees near.

59

CORNER OF D.L.C. NO. 44.
 I reset which from old B.T. now a 40" Black Oak which
 bears S. 0°W., 4.14 chains. I set in a 1" x 48" Gal Iron
 Pipe and reset old B.T. also I mark
 A 12" White Oak which bears N.17½°E., 1.14 ch.

192

CORNER OF D.L.C. # 37.
 Drove Iron Bar for corner. Marked
 A 30" Black Oak N.45°E., 113.6 ft.
 Set corner as per notes to rocks and common consent: all
 B.T.s down.

S.E. CORNER OF D.L.C. # 37.
 Drove an Iron Bar. Found stump of Original B.T. but
 stump had been moved. Set as per fence line and witnesses,
 checked with Exterior N.E. corner. Marked
 A 9" White Oak N.85½°E., 42.3 ft.
 S.33°E., 168.3 ft.

SEE 1924
GOV'T NOTES

EXTERIOR "1" N.E. CORNER No. 37
 Rock and stake, marked
 A 12" Black Oak N.45°E., 275.3 ft.

CORNER BETWEEN 16 T.293., R. 7 W., and 1 T.295., R. 8 W.
 Drove an Iron Pipe. Original B.T.s gone. Set from
 S.W. corner of claim 37. Marked
 A 14" White Oak S.41°E., 26.0 ft.
 A 30" White Oak N.85°E., 47.7 ft.
 (Ford Survey)

62/3

123

CS 37/113

BBI 1927

(13)

1/4 Cor bet Sec 4 + 5.

Identify by D.B.T. has been chopped out & robbed but Fred Byron says that he has seen marks on this tree when it was chopped out.

Found a pile of rocks proper distance but S 49° W instead S 63° W. of tree.

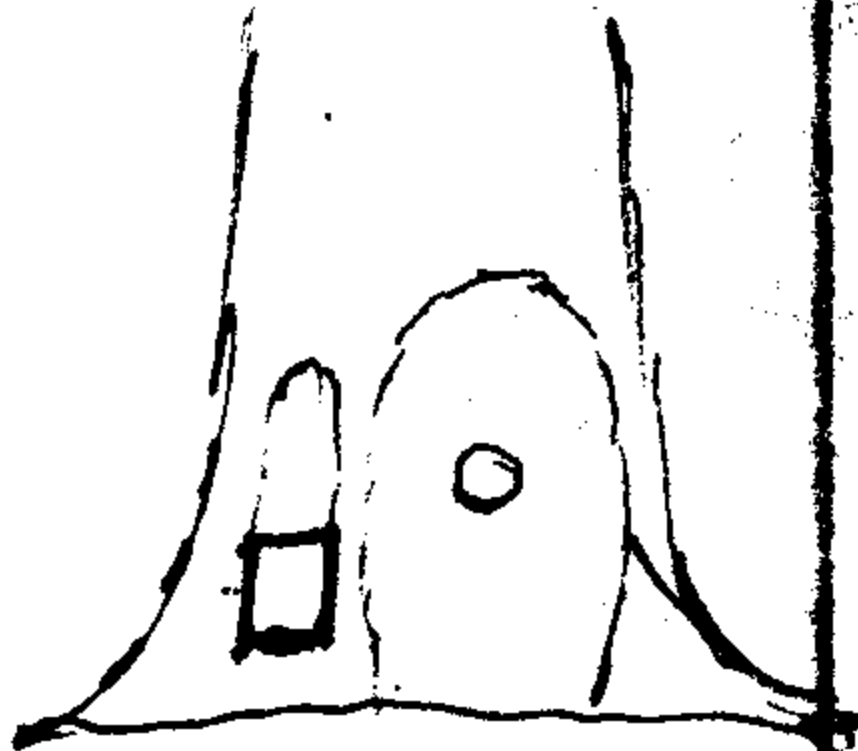

12" WD N 61° W 1947/1 slope 54°
36" WD N 43° E 49" off D.B.T.

48" N. OAK Set W.D. post in pile of rock and mtd a rock

52° E
49° FACE
N 43° E

37

62/3

Found - Brass Cap set by C.S., 1961 (Ren. #99). It appears that this corner was originally set erroneously from a survey made in Nov., 1922 by G.G. Stewart & renewed in 1927 by Co. Surv. J. Byron. Found - Sandstone set by Co. Surv. Cain, (Ren. #49). In checking the renewal notes, there seems to be a doubt as to the corner being reliable. I made a diligent search for the fence intersection mentioned by Cain, to the east, but was unable to find it. Though I did find an old fence line running North, as shown. If the stone was set at the mid-point as stated by Cain, the distance between Sec. Corners seems to be short by 55.0 feet. Therefore, I ignored the two existing N 1/4 Cors. and proportioned a new N 1/4 corner in using the existing section corner btwn. Secs. 5, 6, 31 & 32 and the existing N 1/4 corner of Sec. 4

Found - 4"x8"x10" Stone with 1/4 scribed. T28S R7W
 Set - Brass Cap Mkd: $\frac{1}{4} \begin{array}{l} S \ 32 \\ S \ 5 \end{array}$

New BT's: T29S R7W
 OLS 536 1973
 12" Laurel S. 44°E. 22.0 ft. scribed: "1/4 S5 BT".
 10" Laurel N. 1°W. 19.5 ft. scribed "1/4 S32 BT".

May, 1973
203

Section Corner to Secs. 32 & 33, T28-7 & Secs. 5 & 4, T29-7.
 Set Brass Cap by Proportion: Mkd:

T28S R7W
 $\begin{array}{l|l} S \ 32 & S \ 33 \\ \hline S \ 5 & S \ 4 \end{array}$

Bearing Objects: T29S R7W
 OLS 536 1973
 Chisled "X" in ~~10'x15'x5'~~ ^{2'x3'x2 1/2'} Rock bears ~~N. 18 1/4° W. 56.34 ft.~~ ^{S. 70° W. 92.4 ft.}
 Chisled "X" in ~~2'x6'x1'~~ ^{2'x6'x1'} Rock bears ~~S. 23 1/2° W. 19.25 ft.~~ ^{S. 47° W. 21.5 ft.}
 Chisled "X" in ~~2'x5'x1.5'~~ ^{2'x5'x1.5'} Rock bears ~~S. 34° E. 117.8 ft.~~ ^{S. 44° E. 87.3 ft.}

May, 1973
204

1/4 Corner to Sections 5 and 4.
 Found - 1/2" Iron Bolt and 2 BT's. C.S. (Ren. #3), set by N.E. Richardson, Deputy C.S. The renewal notes show no basis for this corner being the E 1/4 corner. It appears to be out of position by 307.4 feet N., & 176.4 feet E. Therefore, I set a new East 1/4 Corner by Prop. Meas. btwn. the prop. Sec. Cor. btwn. Secs. 4, 5, 32 & ~~33~~ & the found Section Corner btwn. Secs. 4, 5, 8 & 9.

Set - Brass Cap Mkd: T29S R7W
 $\frac{1}{4} \begin{array}{l} S \ 5 \\ S \ 4 \end{array}$

New BT's: OLS 536 1973
 Marked 14" Oak 1/4 S5 BT. bears ~~S. 41° W. 163.9 ft.~~ ^{S. 49° W. 152.7 ft.}
 Marked 14" Oak 1/4 S4 BT. bears ~~S. 86° E. 218.7 ft.~~ ^{N. 86 1/2° E. 204.8 ft.}

May, 1973

205

Center 1/4 Corner Section 5.
 Set - 5/8" x 30" Iron Rod 5" above ground from which bears:
 A 18" Black Oak S. 58°E. 47.8 ft. scribed "C 1/4 S5 BT".
 S 14" White Fir S. 5°W. 35.5 ft. scribed "C 1/4 S5 BT".
 Note: No tree North at Corner.
 Also Corner is 17 ft. west from North & South Fence Line.

May, 1973

Glenn S. Baughman
 For: Paul Slama
 C.S. File No. 55/296 RM 2 - 46
 May, 1973

SEE CORRECTIONS
 SEE C.S. 55/296
 29.

Baughman Surveying
 For Geo. Bartlett
 M 49 - 23
 C.S. File 55/301
 May, 1973

55/296/2/3

EN

28-1.42
500

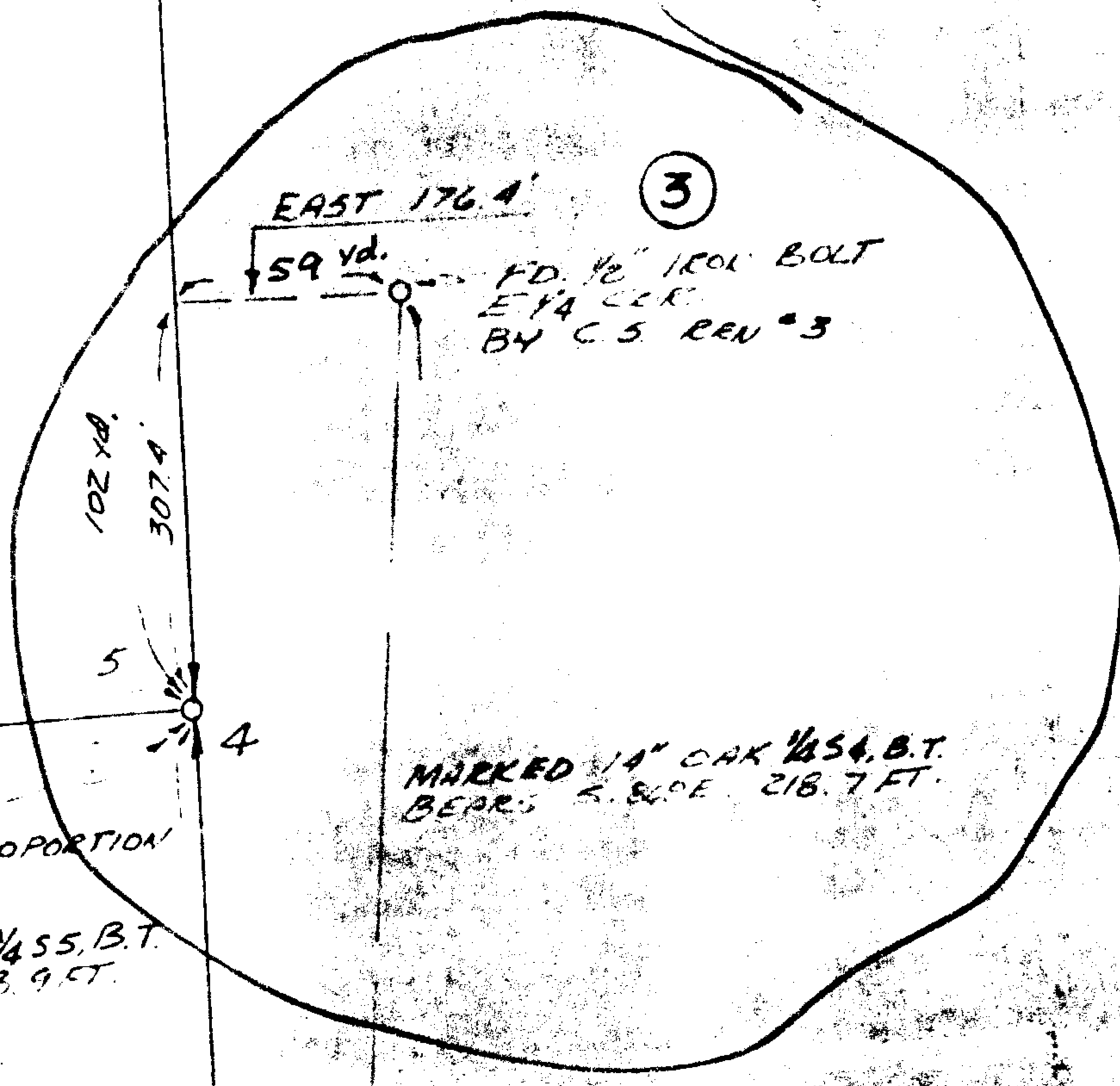

LOCATION OF
E. 1/4 COR. BY PROPORTION
SET BRASS CAP
MARKED 1 1/4\" OAK 1/4 55 B.T.
BEARS 5 1/4\" W. 163.9 FT.

MARKED 1 1/4\" OAK 1/4 54 B.T.
BEARS 5 1/4\" W. 218.7 FT.

(40.7 CHAIN)

2761.19'

N. 0° 2' 34\" E

N 3° 21' 42\" E. 3074.42'

BAUGHMAN 1973
RM 2-46

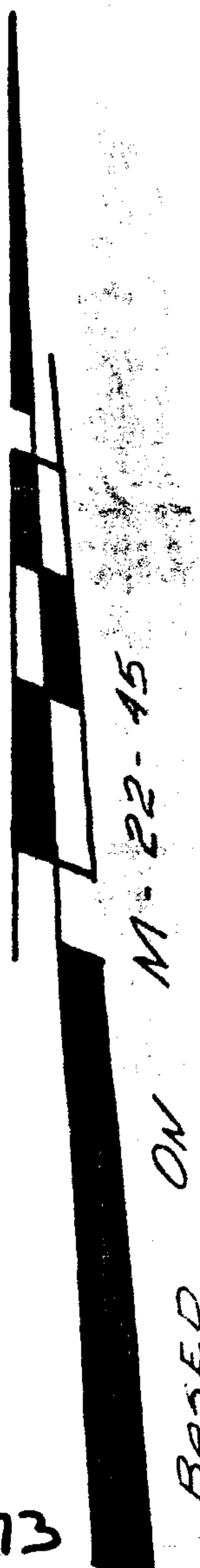

FD. FROM 2 1/2\" B.T.
C.S.G. 0.5 7 1/2

SL 62/3

REGISTERED
PROFESSIONAL
LAND SURVEYOR