

GOVERNMENT CORNER RESTORATION FORM

Township 22S Range 9W Sec. 25 County DOUGLAS

State OR Date 12-14-82 No. _____

Corner Designation T22S R9W

26|25
35|36

- _____ Condition Report Only
- _____ Not Found
- Renewed
- _____ Unrecorded
- _____ Surveyed In
- _____ Referenced Out

Previous Renewals _____

Monument(s) Found: (Condition and Source)

FD. RECENTLY SET 1 1/2" IP WITH
BRASS CAP SET BY LUCKMAN
SURVEYING.

MONUMENT DETAIL

PLS 1254

T 22 S

26|25
35|36

R 9 W

1982

Accessories Found:

FD. ORIG. 48" FIR, NOW 40" ROTTING STUMP. I OPEN
AND FIND SCRIBED "T22S R9W S36".

FD. ORIG 36" FIR, NOW 39" ROTTING STUMP. I OPEN
AND FIND SCRIBED "T22S R9W S35".

#894

62/1-35

RENEWAL

Monument Set (Procedure and Description)

SINCE FD. BRASS CAP DID NOT AGREE WITH FD. ORIG. BT'S, I SET 1" x 30" IP WITH BRASS CAP. USING RECORD BEARINGS & DISTANCES FROM BOTH BT'S.

ORIG. 48" NOW 40" FIR STUMP BEARS S68E 89± FT.

ORIG. 36" NOW 39" FIR STUMP BEARS S25W 87± FT.

FD. BRASS CAP BEARS N79½W 34± FT FROM COR. I SET.

Monument Detail

DOUGLAS CO. SURVEYOR
TZZS
S26/S25
S35/S36
R9W
1982

New Accessories

12" HEMLOCK SCRIBED "TZZS R9W S25CS BT" IN DOUBLE BLAZE BEARS N72°E 48±

10" FIR SCRIBED "TZZS R9W S36CS BT" IN DOUBLE BLAZE BEARS S61°E 33±

10" HEMLOCK SCRIBED "TZZS R9W S35CS BT" IN DOUBLE BLAZE BEARS S16°W 42±

15" FIR SCRIBED "TZZS R9W S26CS BT" IN DOUBLE BLAZE BEARS N81°W 18±

Sketch of Monument, Accessories, and General Area

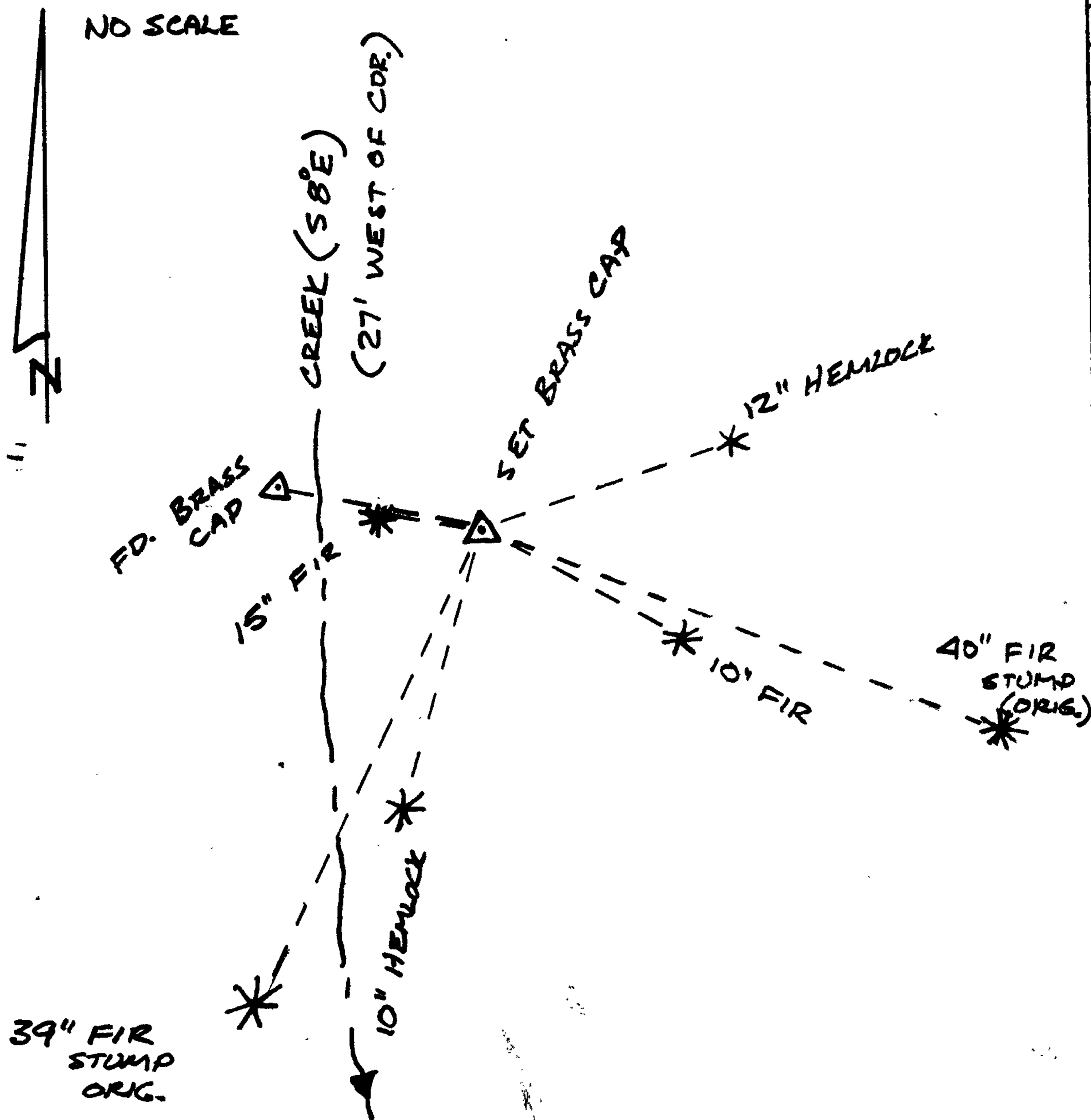

Location & Comments

DCSO BT TAGS ON ALL TREES

Comp. Declin. 19° E
Agency DCSO
Party Chief GREGORY E. QUIBELL
Notekeeper Gregory E. Quibell
Witnesses JOHN POWELL
RANDY SMITH

Surveyor's Seal

REGISTERED
PROFESSIONAL
LAND SURVEYOR

Gregory E. Quibell

OREGON
JULY 13, 1979
GREGORY E. QUIBELL
1834

10" HEMLOCK
S 16 W 42³
T 22S R 9W S 35
CS BT

27' ± WEST TO
CREEK FLOWING SBE

15" FIR
N 81 W
18³
T 22S R 9W S 26 CS BT

N 79 1/2 W
34²

TO

12" HEMLOCK

N 72° E 48⁵
T 22S R 9W S 25
CS BT

10" FIR
S 61 E 33⁸

T 22S R 9W S 36
CS BT

~~T 22S~~

PLS 1254

C. S. E. L. N. 102

T 22S

R 9W

S 35

Marked 1 1/2 sec. B. 1.

52.25 Top of ridge, Course E. and W.

+ 200

Descend gradually.

57.00 Began steep descent.

60.60 A creek, 1 lk. wide, Course SE.

70.30 Spur slopes, SE.

★ 80.00 Set Maple post, 4 1/2 feet long, 4 ins. square, 24 ins.

in the ground on hillside sloping West for the corner to secs. 25, 26, 35 and 36, marked T. 22 S. S. 25 on the NE., R. 9 W., S 36 on the SE., S. 35 on the SW and S. 26 on the NW., faces with 1 notch on the S., and E. edges, from which,

A Fir, 30 ins. diam., bears N.80°E., 68 lks. dist.

Marked T. 22 S., R. 9 W., S. 25 B. T.

A Fir, 48 ins. diam., bears S.68°E., 135 lks. dist.

I OPEN
Marked T. 22 S., R. 9 W., S. 36 B. T.

A Fir, 36 ins. diam., bears S.25°W., 133 lks. dist.

I OPEN
Marked T. 22 S., R. 9 W., S. 35 B. T.

A Fir, 32 ins. diam., bears N.27°W., 29 lks. dist.

Marked T. 22 S., R. 9 W., S. 26 B. T.

Land, mountainous. 80.00 chs.

Soil, second rate.

Timber, Fir, Cedar, Maple and Alder.

Undergrowth, dense vine-Maple, Hazel, Rhododendron, Arrow-wood, Salmonberry, Salal and Thimbleberry. 80.00 chs.

October 24, 1894.

Thence, I run,

S.89°47'E., on true line, between secs. 25 and 36.

Va. 20°E.

4.75 Spur, Course SE.

Descend.

21 00 A creek 12 lks. wide. Course NE.

62/1-35