

GOVERNMENT CORNER RESTORATION FORM

Township 32S Range 5W Sec. 7 County DOUGLAS

State OR Date 11-29-82 No. _____

Corner Designation T32S R5W

7 | 8
18 | 17

- Condition Report Only
- Not Found
- Renewed
- Unrecorded
- Surveyed In
- Referenced Out

Previous Renewals #147

Monument(s) Found: (Condition and Source)

FD. 1967 DCSO BRASS CAP BURIED BY ROAD FILL. BRASS CAP WAS LYING HORIZONTAL AND OUT OF PLACE.

COUNTY SURVEYORS
T32S R5W OFFICE

57 | 58
518 | 517

1967

Accessories Found:

FD. ORIG. 24" NOW 37" FIR WHICH SHOWS GOOD BARK SCRIBE.

FD. 30" FIR PER REV. #147. NOW 30" STUMP WITH GOOD HEALED OVER SCAR.

FD. 11" FIR PER REV. #147, NOW STUMP WHICH IS OUT OF PLACE BY APPROX. 30 FT DUE TO LOGGING.

#214 ✓

C. S. Ellis No. 12/1-30C

RENEWAL

Monument Set (Procedure and Description)

Monument Detail

USING RECORD DISTANCES FROM THE
 FD. ORIG. BT AND THE 30" FIR
 STUMP I RESET THE FD BRASS
 CAP. FD. TREES NOW BEAR:

ORIG. 24" NOW 37" FIR BEARS S43°W
 251 FT. (REC. S45W)

30" FIR STUMP BEARS S11°E 45±
 (REC. S12E)

COR. LIES ON VERY STEEP SLOPE
 APPROX 100' BELOW NEW ROCK RD.

I ADD MARKS "RESET 1982"

SURVEYORS

COUNTY T32S RSW OFFICE

S7 | S8
 S18 | S17

RESET
 1982
 1967

New Accessories

12" FIR SCRIBED "T32S RSW S7 CS BT" IN DOUBLE BLAZE BEARS
 N 9°W 83± FT.

11" FIR SCRIBED "T32S RSW S8 CS BT" IN DOUBLE BLAZE BEARS
 N 82°E 67± FT.

Sketch of Monument, Accessories, and General Area

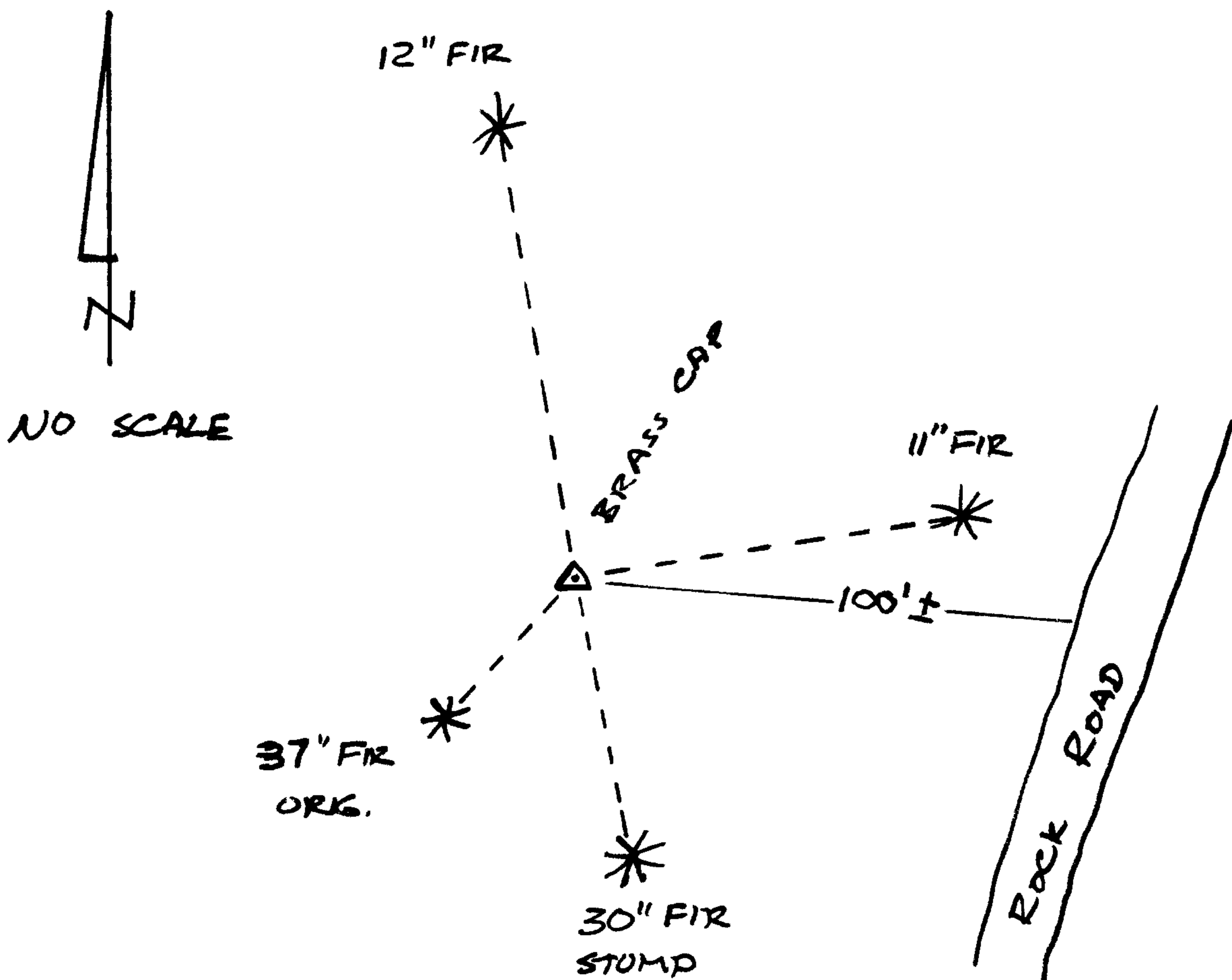

Location & Comments

DCSO BT TAGS ON ALL
 TREES

Comp. Declin. 19°E
 Agency DCSO
 Party Chief GREGORY E. QUIBELL
 Notekeeper Gregory E. Quibell
 Witnesses RANDY SMITH
JOHN POWELL

OK
 JEM

Surveyor's Seal

REGISTERED
 PROFESSIONAL
 LAND SURVEYOR

Gregory E. Quibell
 OREGON
 JULY 13, 1979
 GREGORY E. QUIBELL
 1834