

GOVERNMENT CORNER RESTORATION FORM

Township 19S Range 10W Sec. 26 County DOUGLAS

State OR Date 11-16-82 No. _____

Corner Designation T 19S R 10W

27 | 26

34 | 35

- Condition Report Only
- Not Found
- Renewed
- Unrecorded
- Surveyed In
- Referenced Out

Previous Renewals # 1 M 92-29

Monument(s) Found: (Condition and Source)

FD. 1964 DECO BRASS CAP FIRMLY SET FACING SOUTH WITH SEC NUMBERS IMPROPERLY STAMPED

MONUMENT DETAIL

1964
R 10W
27 | 26

34 | 35
T 19S
SURVEYORS OFFICE COUNTY

Accessories Found:

FD. ORIG. FIR NOW 28" STUMP WITH SCRIBES VISIBLE BEARS N 59° W S 3 FT.

FD. ORIG. 42" FIR NOW 47" WITH GOOD SCAR BEARS N 58° E 35 1/2

FD. ORIG. 36" FIR NOW 39" WITH GOOD SCAR BEARS S 69° W 11 1/2

FD. ORIG. 36" FIR NOW 39" WITH GOOD SCAR BEARS S 7° E 12 1/2

FD. 10" HEMLOCK PER REN. #1 NOW 13" WITH GOOD SCAR BEARS N 29° E 90 1/2 FT.

6211-28C

#32 ✓

RENEWAL

Monument Set (Procedure and Description)

Monument Detail

SINCE LOCATION OF FD BC IS
 CORRECT BUT MARKINGS WRONG, I
 REFERENCE LOCATION THEN RESET
 A NEW 1" x 30" IP WITH BRASS CAP
 AT ORIG LOCATION.

DOUGLAS CO SURVEYOR
 T19S
 527 | 526
 534 | 535

R10W

RESET
 1982
 1964

New Accessories

Sketch of Monument, Accessories, and General Area

Location & Comments

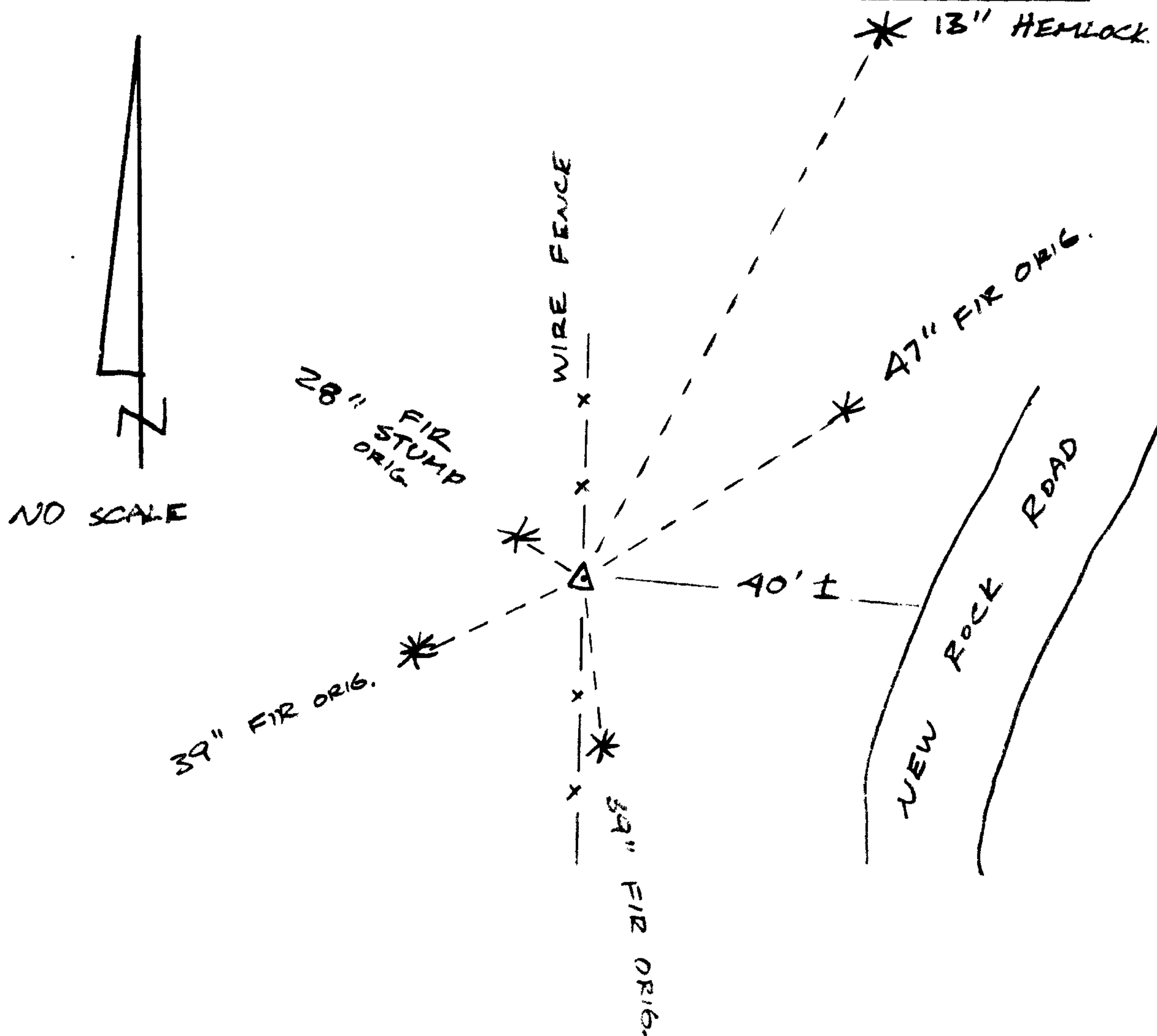

Comp. Declin. 19° E
 Agency DESO
 Party Chief GREGORY E. QUIBELL
 Notekeeper Gregory E. Quibell
 Witnesses RAVDY SMITH

Surveyor's Seal

REGISTERED
 PROFESSIONAL
 LAND SURVEYOR

Gregory E. Quibell

OREGON
 JULY 13, 1979
 GREGORY E. QUIBELL
 1834