

GOVERNMENT CORNER RESTORATION FORM

Township 23S Range 2W Sec. 28 County DOUGLAS

State OR. Date 10-20-82 No. \_\_\_\_\_

Corner Designation T23S R2W

WIT. COR.  $\frac{1}{4}$  528  
4 533

- \_\_\_\_\_ Condition Report Only
- \_\_\_\_\_ Not Found
- Renewed
- \_\_\_\_\_ Unrecorded
- \_\_\_\_\_ Surveyed In
- \_\_\_\_\_ Referenced Out

Previous Renewals M 92-78 - ATTACHED WEYERHAEUSER REN.

MONUMENT DETAIL

Monument(s) Found: (Condition and Source)

FD. HUB & TACK IN CENTER  
OF LOGGING RD. AS PER  
M 92-78.

Accessories Found:

ALL ORIG. EVIDENCE HAS BEEN DESTROYED BY ROAD  
CONSTRUCTION, HOWEVER THE COR. HAS BEEN  
PERPETUATED BY WEYERHAEUSER 6-1-76 AND AGAIN  
12-20-81 & 7-27-82 SEE ATTACHED WEYERHAEUSER RENEWAL  
RECEIVED 9-28-82.

FD. 56" FIR PER WEYERHAEUSER REN. NOW 73" FIR  
STUMP BEARS N 46 3/4 W 102.6 FT TO "W" NAIL NEAR  
CENTER OF STUMP, AS PER REC.

FD. 56" FIR SNAG PER WEYERHAEUSER REN. NOW 65" STUMP  
BEARS S 20 E 40.2 FT. TO "W" NAIL IN FACE, AS PER REC.

FD. 29" CEDAR STUMP PER WEYERHAEUSER REN BEARS  
N 88 1/2 E 69 1/2 (REC. EAST) TO "W" NAIL IN FACE.

FD 60" FIR AT S 48 E 75 1/2 FEET IS DOWN AND  
OUT OF PLACE. AS PER WEYERHAEUSER REN.

#42 ✓

G & E File No. 62/1-260

RENEWAL

Monument Set (Procedure and Description)

SINCE COR FELL IN ROCK  
 PD. I SET A 1" x 30" IP WITH  
 BRASS CAP ATTACHED, NORTH 400  
 FT FOR WIT. COR.

Monument Detail

CO  
 WIT COR S  
 40 FT SOUTH  
 TO  
 S 28 R  
 23 1/4 S 33 Z  
 S W  
 1982

New Accessories

17" CEDAR SCRIBED "X CS BT" IN DOUBLE BLAZE BEARS S 55 1/2 E  
 175 1/2 FT.  
 22" FIR SCRIBED "X CS BT" IN DOUBLE BLAZE BEARS S 31 W 292 1/4 FT.

Sketch of Monument, Accessories, and General Area

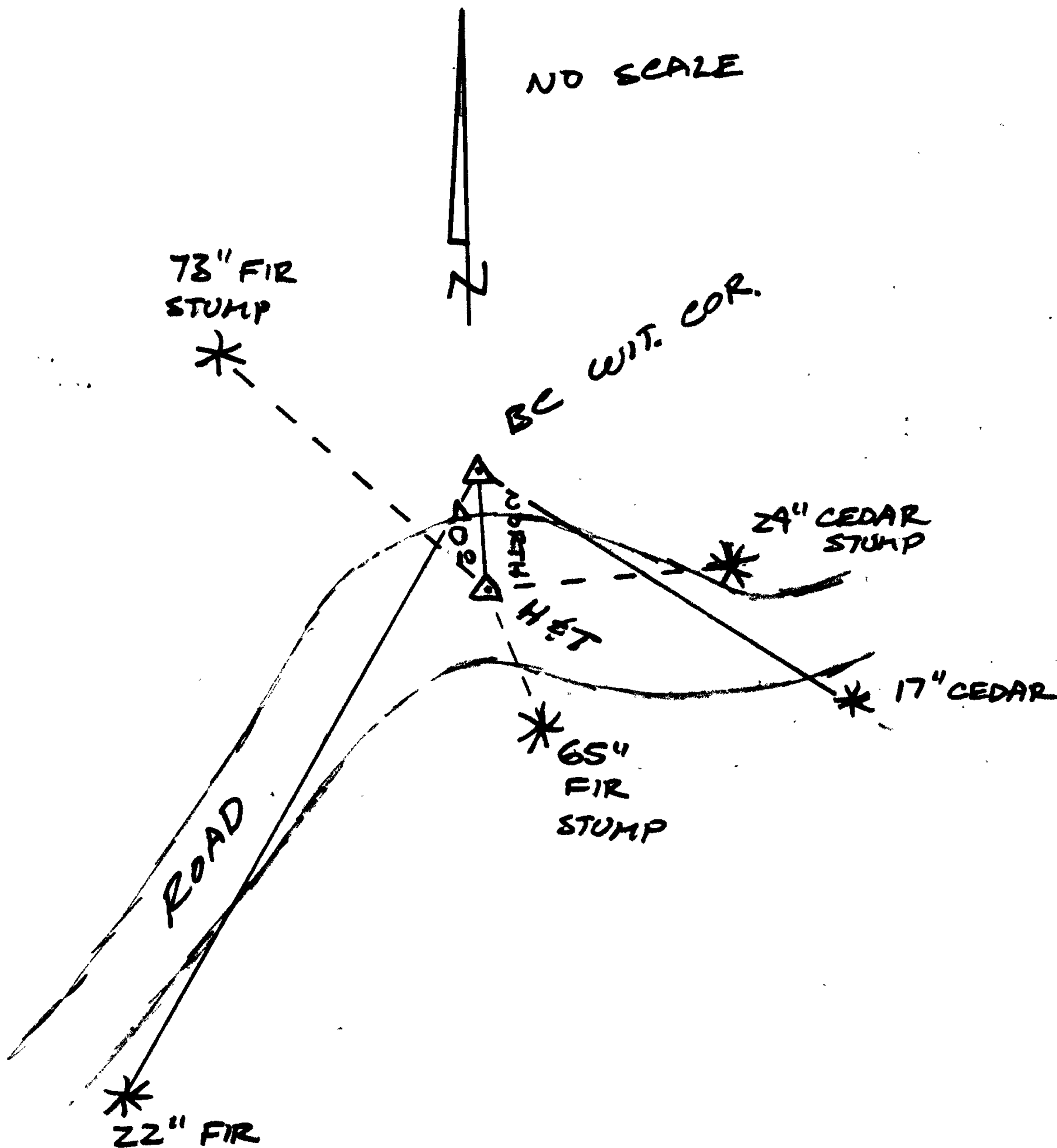

Location & Comments

DCSO BT TAGS ON  
 ALL TREES.  
 Comp. Declin. 19° E  
 Agency DCSO  
 Party Chief GREGORY E. QUIBELL  
 Notekeeper Gregory S. Quibell  
 Witnesses KAREN REED  
TERRIE PLOUFF

Surveyor's Seal

REGISTERED  
 PROFESSIONAL  
 LAND SURVEYOR

*Gregory E. Quibell*

OREGON  
 JULY 13, 1979  
 GREGORY E. QUIBELL  
 1834

# PUBLIC LAND CORNERS

Rec'd 9/27/82 From WY. Co.

X  
Crew  
Visit

WEYERHAEUSER COMPANY  
SPRINGFIELD BRANCH

TOWNSHIP 23S RANGE 2W  
SECTION 33 CORNER N $\frac{1}{2}$   
COUNTY Lane OREGON

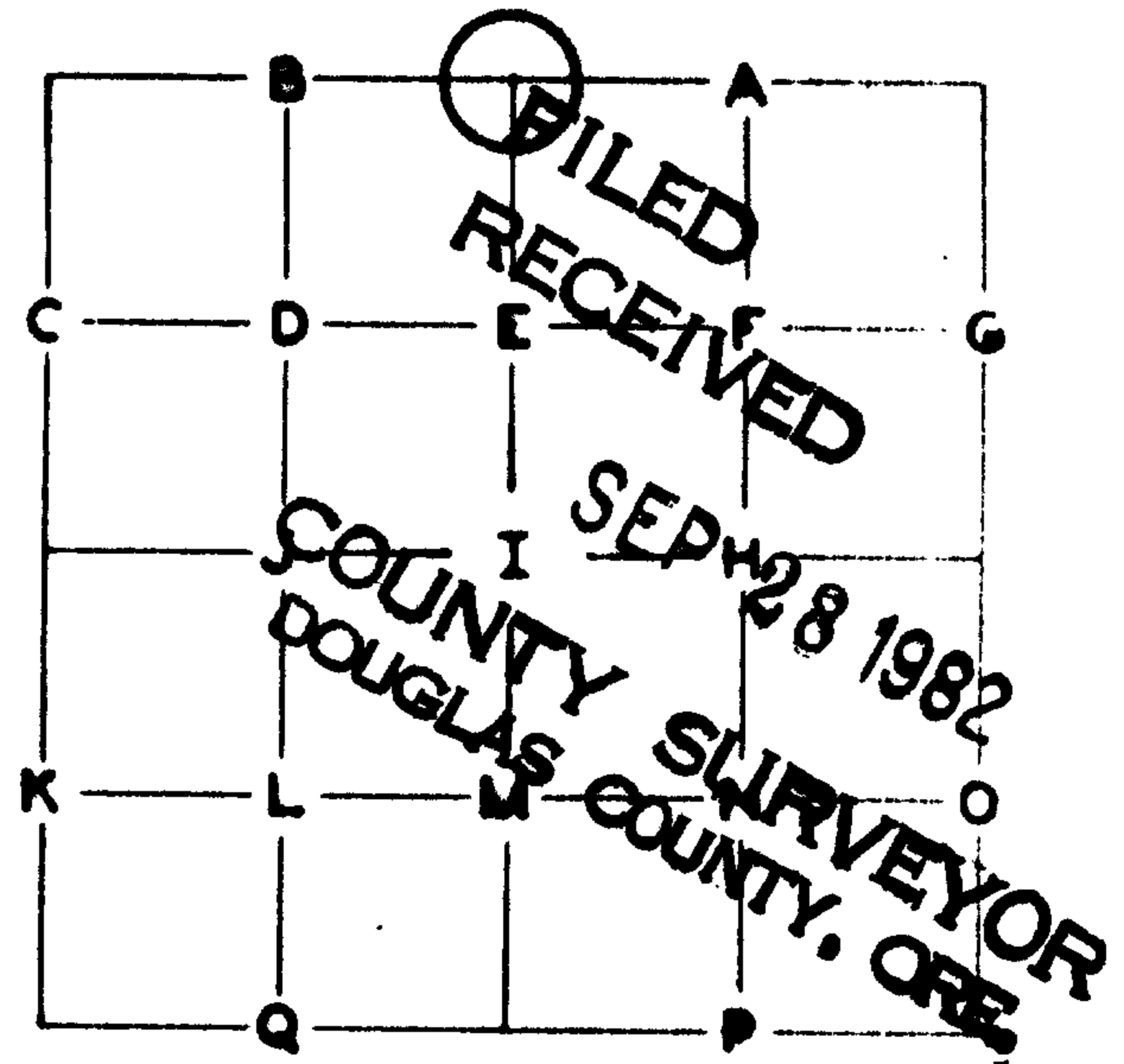

### GLO SURVEY RECORD

DATE: 1894  
CORNER stone 12" x 10" x 8"

PRESENT CONDITION - (DESCRIBE FULLY  
USE PAGE 2 IF NEEDED FOR EXPLANATION.)

Destroyed by road construction.

### ACCESSORIES:

	BEARING-	LINKS-	FEET-
24" Cedar	N81E	9	5.9
18" Cedar	S20E	16	10.6

Destroyed by road construction.  
Destroyed by road construction.

Weyerhaeuser Co. SURVEY RECORD  
DATE: June 1, 1976  
By Glen McChesney under the supervision  
of Frank O. Williams.

PRESENT CONDITION: 12-12-76

Found original stone and scribing visible on  
2 original BTs. Referenced with W nails and  
plates on:

54" Red Cedar	S81E	155.1 ft.
60" Fir	S48E	75.3 ft.
56" Fir	N46 3/4W	99.6 ft.

Destroyed by road construction.  
60" Fir, W nail and plate intact.  
56" Fir Stump-W Nail in sawn kerf replac

CORNER SET: point in road determined by bearings MAG. DECL.: 20

and distances from 6/1/76 reference trees. Nothing set.

### BEARING AND DISTANCE TO ABOVE IDENTIFIED SURVEY ACCESSORIES:

BEARING-	FEET-	SURVEY-

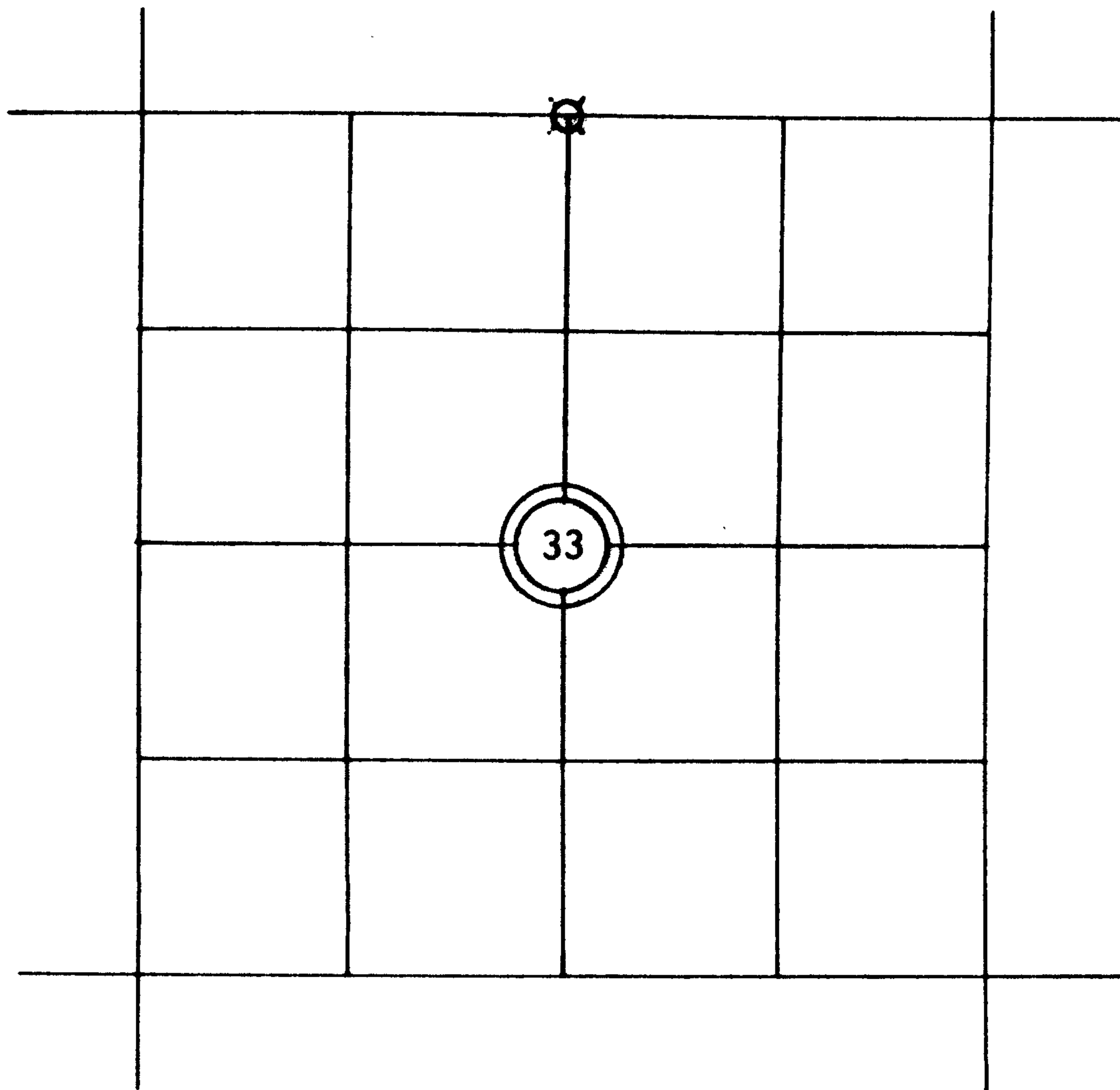

— — — — — LINE MARKED BY NOTCH CUT IN BLAZE.

○...KNOWN CORNER.

⊗...REFERENCED CORNER BY WEYERHAEUSER METHOD.

81?

12-12-82 The Weyerhaeuser Co. 6/1/76 reference N46 3/4W 99.6' now a 56" Fir stump was notched for a guyline stump and W nail was sawn out when notched. I found segment with W nail on ground and fitted this segment back into its original position and renewed plate with same bearing and distance. I also drove a W nail in the approximate center of this stump N46 3/4W 3.0' from the replaced W nail, therefore making the distance between this W nail and the corner point 102.6 ft.

7-27-82 Added 56" fir snag stump S 20 E 40.7 feet with nail and Weyerhaeuser tag. 60 inch fir at S 48 E 75.3 feet is down and out of place.

G. S. H. M. 62/1-26

ACCESSORIES ADDED THIS DATE:

MAGNETIC DECLINATION 20°E

	BEARING	FEET	ORIG. B.T.	"W" NAIL	PLATE	BRASS DISC
24" Red Cedar	East	69.6	---	X	X	---
See Page 2						

IDENTIFIED ON PHOTO:

INFORMATION ON LOCATION OF CORNER AS NOW SET:

GROUND COVER: Center of rock logging road on spur ridge.

(USING FORM LINES SKETCH TOPOG AT CORNER ON PAGE 2 PLAT)

SLOPE FACES (GIVE BEARING IN DEGREES) N 10 W ON MINUS (-) 80 %

NORTH: \_\_\_\_\_

SOUTH: \_\_\_\_\_

EAST: \_\_\_\_\_

WEST: \_\_\_\_\_

WORK DONE FOR W. CO.

FIELD NOTES IN BOOK: \_\_\_\_\_

Glen McChesney DATE: 12/12/1976  
Project ENGINEER - SURVEYOR

ASSISTED BY: \_\_\_\_\_

COPIES SENT TO: \_\_\_\_\_

UNDER THE SUPERVISION OF:

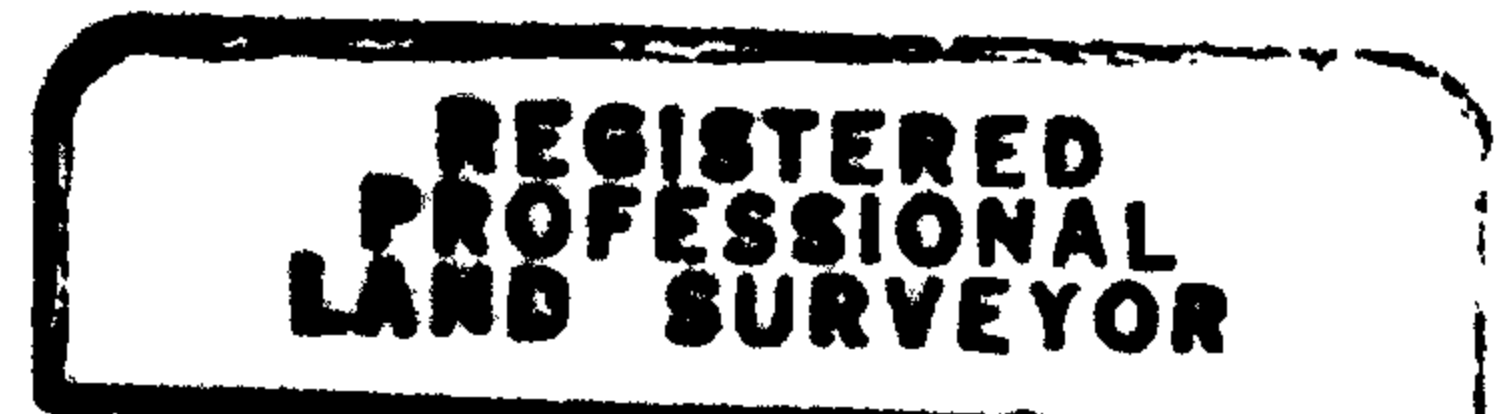

*Frank O. Williams*

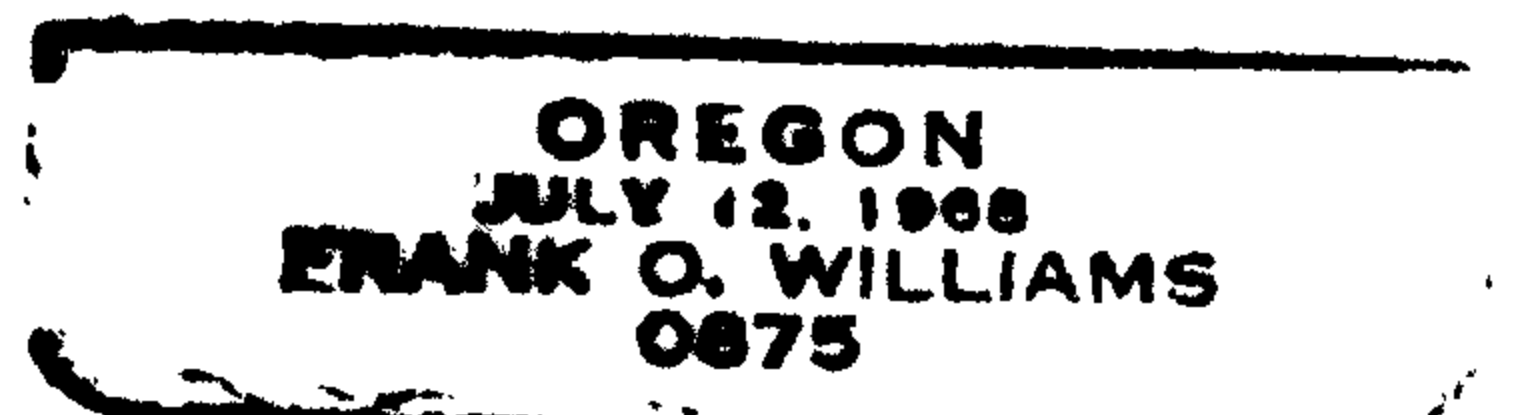

62/1-26 SEAL