

GOVERNMENT CORNER RESTORATION FORM

Township 22S Range 4W Sec. 22 County DOUGLAS

State OR Date 10-4-82 No. \_\_\_\_\_

Corner Designation T22S R4W

$\frac{1}{4}$   $\frac{S22}{S27}$

- \_\_\_\_\_ Condition Report Only
- \_\_\_\_\_ Not Found
- Renewed
- \_\_\_\_\_ Unrecorded
- \_\_\_\_\_ Surveyed In
- \_\_\_\_\_ Referenced Out

Previous Renewals #23

MONUMENT DETAIL

Monument(s) Found: (Condition and Source)

FD. 36" "T" IRON PER REN. #23  
 WITH BRASS CAP MARKED: "SURVEY POINT  
 WILFORD N. HAINES #239. MONUMENT  
 WAS PROTRUDING 6" OUT OF GROUND

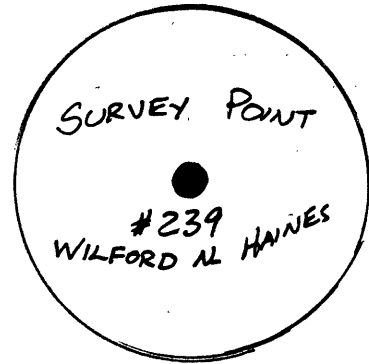

Accessories Found:

30" INCENSE CEDAR NOW 32" STUMP BEARS S45°E 82.3 FT.  
 SHOWS GOOD SCAR.  
 14" FIR, NOW 21" (ALIVE) BEARS N46°E 34<sup>3</sup> (REC. N44E 34.2)  
 SHOWS GOOD SCAR.

#190 X

File No. 62/1-21

RENEWAL

Monument Set (Procedure and Description)

Monument Detail

I REFERENCE LOCATION OF FD. MONUMENT  
 THEN REPLACE IT WITH 1" x 30" IP  
 WITH BRASS CAP ATTACHED. I PLACE  
 FD "T" IRON ALONG NORTHERLY SIDE AND  
 SLIGHTLY LOWER THAN NEW BRASS  
 CAP.

MON. IS LOCATED 0.8 FT NORTH OF  
 COR. POST OF A NEW WIRE FENCE  
 RUNNING SOUTH  $\frac{1}{4}$  N 66° E.

DOUGLAS CO SURVEYOR P  
 $\frac{1}{4}$  T22S  
 S22  
 S27  
 RAW  
 1982

New Accessories

6" FIR SCRIBED "S 27 CS BT" IN DOUBLE BLAZE BEARS S31°W 41.6 FT.  
 7" FIR SCRIBED "S 27 CS BT" IN DOUBLE BLAZE BEARS S82°W 21.8 FT.  
 14" FIR SCRIBED "S 22 CS BT" IN DOUBLE BLAZE BEARS N46°W 20.9 FT.

Sketch of Monument, Accessories, and General Area

Location & Comments

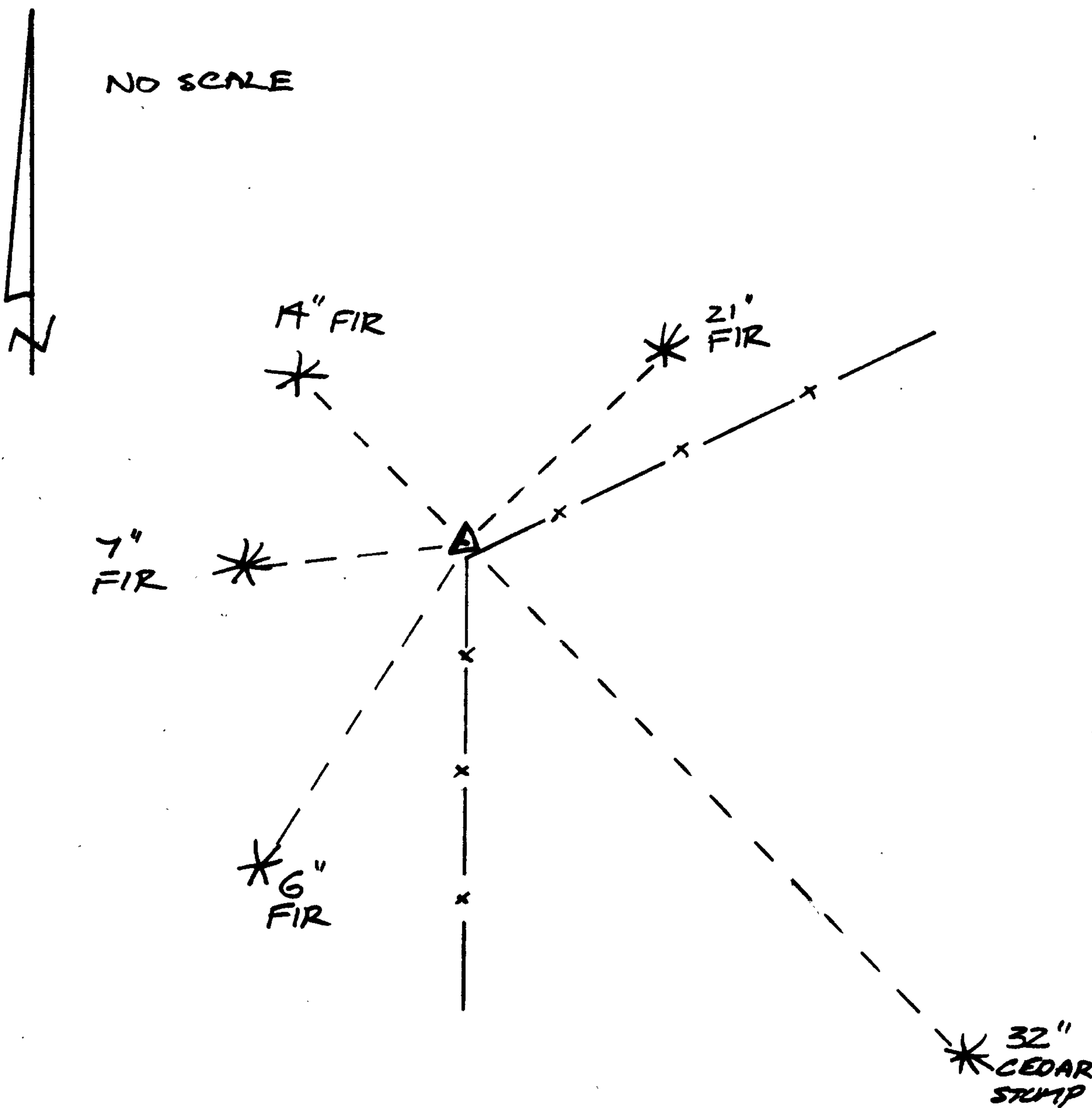

Comp. Declin. 19° E  
 Agency DCSO  
 Party Chief GREGORY E. QUIBELL  
 Notekeeper Gregory E. Quibell  
 Witnesses KAREN REED  
TERRIE FRANSSSEN

OK *JKM*

Surveyor's Seal

**REGISTERED  
 PROFESSIONAL  
 LAND SURVEYOR**

*Gregory E. Quibell*

OREGON  
 JULY 13, 1979  
 GREGORY E. QUIBELL  
 1834

Section 22 Twp 22 S Rge 4 W

Date: 8-3-76

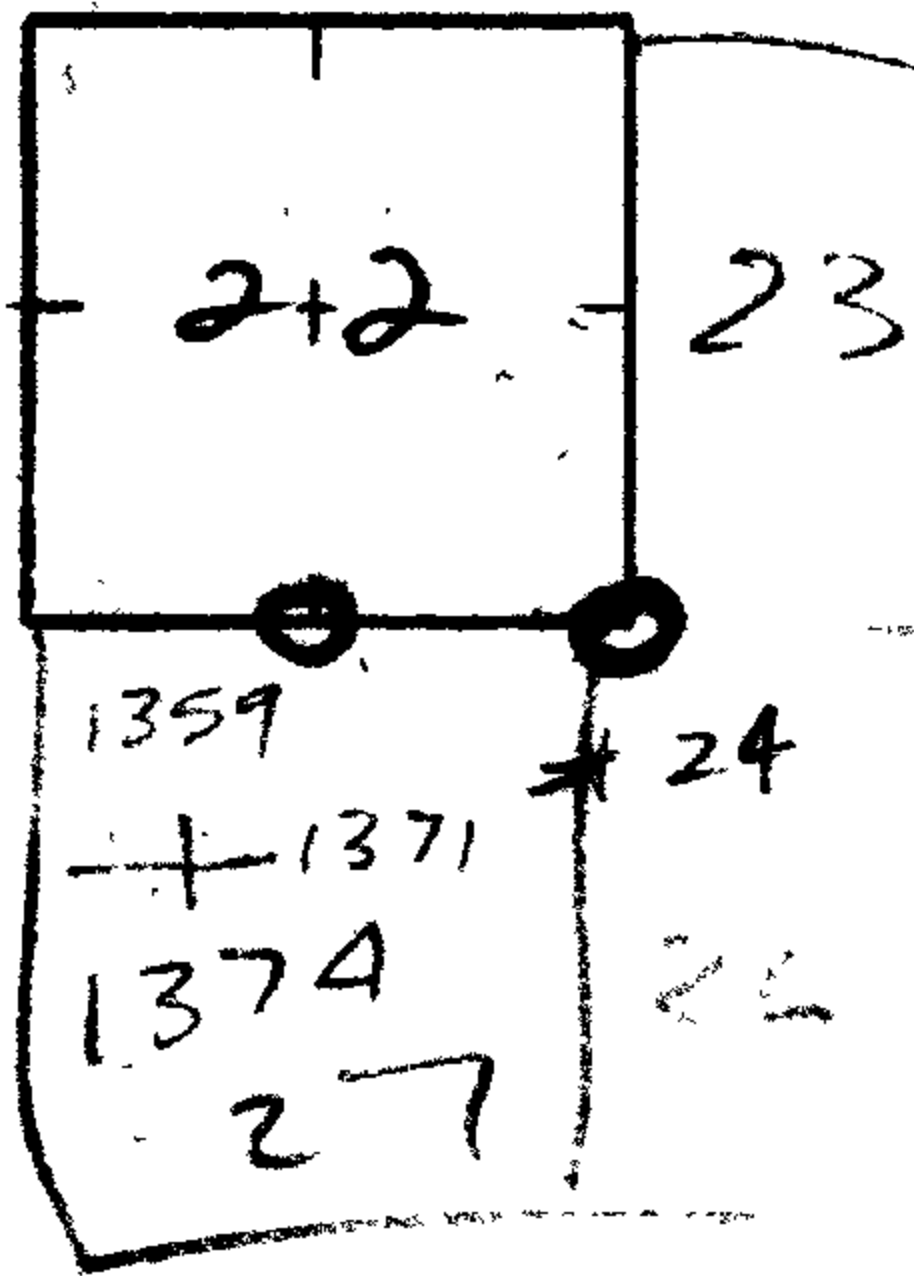

How was corner identified? Haines "T" Iron, 1/2" Iron Pipe

4 3 BT's

Condition of corner: fair, could use 1 or 2 new BT's

Best route to reach corner: from NW from road through Sehlin prop.

Quadrant	NE	NW	<sup>approx</sup> SE	SW
Species & Size		46" IC	54" Δ	26" Δ
Dist. & Bearing		S64E, 44.0'	N53W, 15'	N, 15.6'
Condition of Scribe		good		good
Original or Resurvey				
Appearance of B.T.		good	good	good
Tags, Marks, etc.		BT tag	good see notes BT tag	BT tag

Other Remarks:

~~6.5.76~~ 1-21  
Steve Cole, Forester  
Worley Ent.  
 Signed

Section 22 Twp 22 S Rge 4 W

Date: 8-3-76

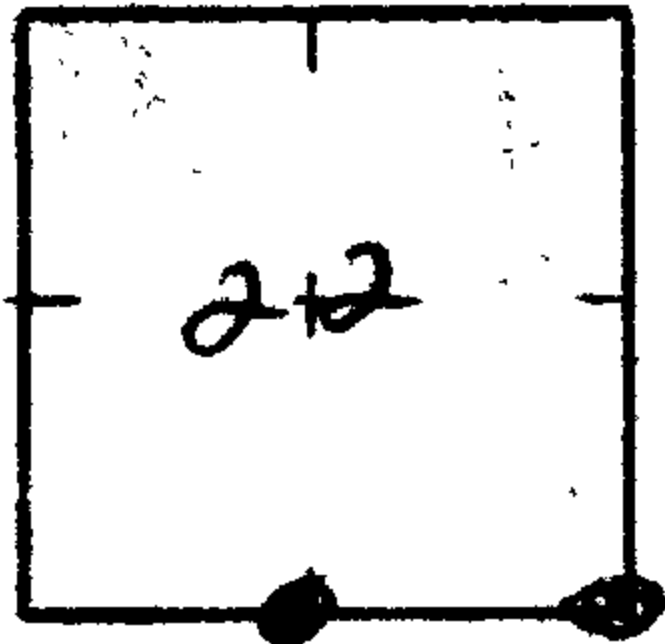

How was corner identified? Haines "T" Iron + 2 BT's

Condition of corner: needs 1 new BT

Best route to reach corner: From NW from Sehlin prop

#23

1359

Quadrant	NE	NW	SE	SW
Species & Size	22" Δ		32" 10 stump	
Dist. & Bearing	S44W, 34.0'		N45W, 82.3'	
Condition of Scribe				
Original or Resurvey				
Appearance of B.T.	good		poor - not covered	
Tags, Marks, etc.	BT tag		BT tag	

Other Remarks:

~~CLERK 62/1-21~~

Steve Cole, Forester  
 Wollery Ent.  
 Signed

Postage  
Will be Paid  
by  
Addressee

~~08~~ N66E  
SOUTH  
42

DRAIN, OR 97435  
AUG 3  
PM  
1976



**BUSINESS REPLY CARD**  
PERMIT NO. 102      ROSEBURG, OREGON

**DOUGLAS COUNTY SURVEY**

**ROOM 122, COURTHOUSE**

**ROSEBURG, OREGON**

6" FIR  
1/4 S27CS BT  
S31W  
416

7" FIR  
1/4 S27CS BT  
S82W  
218

14" FIR  
N46W  
1/4 S22CS BT  
204