

GOVERNMENT CORNER RESTORATION FORM

Township 23S Range 6W Sec. 19 County DOUGLAS

State OR Date 9-22-82 No. \_\_\_\_\_

Corner Designation T23S R6W

19 | 20  
30 | 29

- Condition Report Only
- Not Found
- Renewed
- Unrecorded
- Surveyed In
- Referenced Out

Previous Renewals 1957 RESURVEY

MONUMENT DETAIL

Monument(s) Found: (Condition and Source)

FD. 2" x 30" I.P. (BENT) WITH BRASS  
CAP ATTACHED (PER 1957 RESURVEY)  
LYING ON GROUND.

T23S R6W  
 S19 | S20  
 S30 | S29  
 1957

Accessories Found:

FD. 25" FIR PER RESURVEY NOW 48" WITH BARK SCRIBED "T23S R6W  
S20 BT" VISIBLE.

FD. PROBABLE ROOT REMAINS OF 28" FIR PER RESURVEY.

FD. 29" FIR PER RESURVEY NOW 30" WITH WELL HEALED BLADE.

FD. 33" FIR PER RESURVEY NOW 32" WITH WELL HEALED BLADE.

# 77 ✓

G. & E. No. 62/1-19

RENEWAL

Monument Set (Procedure and Description)

Monument Detail

AFTER PULLING OFF RECORD BEARING AND DIST. FROM EACH OF THE FD BT'S I DETERMINE THAT THE REC. BEARING & DIST. TO THE NW BT ARE WRONG. USING THE REMAINING 3 BT'S I ESTABLISH A LOCATION FOR THE COR. WHICH FITS ALL THREE REASONABLY WELL. I THEN RESET THE FD IP WITH BRASS CAP AT THAT LOCATION AND STAMP "RESET 1982" ON CAP. BEARING & DIST'S TO FD. BT'S ARE NOW AS FOLLOWS:

1. 25" NOW 48" FIR BEARS N16°E 58' (SAME AS REC)
2. ROOT REMAINS OF 28" FIR BEARS S76°E 15' (SAME AS REC)
3. 29" NOW 30" FIR BEARS S50 1/2°W 54' (REC. 54')
4. 33" NOW 32" FIR BEARS N76°W 9' (REC. N1°W 2')

T 23S R 6W  
 S19 | S20  
 ---  
 S30 | S29  
 RESET  
 1982  
 1957

New Accessories

SET CONCRETE NAIL IN 15" x 24" FLAT TOP PORTION OF APPROX. 6 FT. DIA. SANDSTONE OUTCROPPING, BEARS N60 1/2°E 4' FT.

Sketch of Monument, Accessories, and General Area

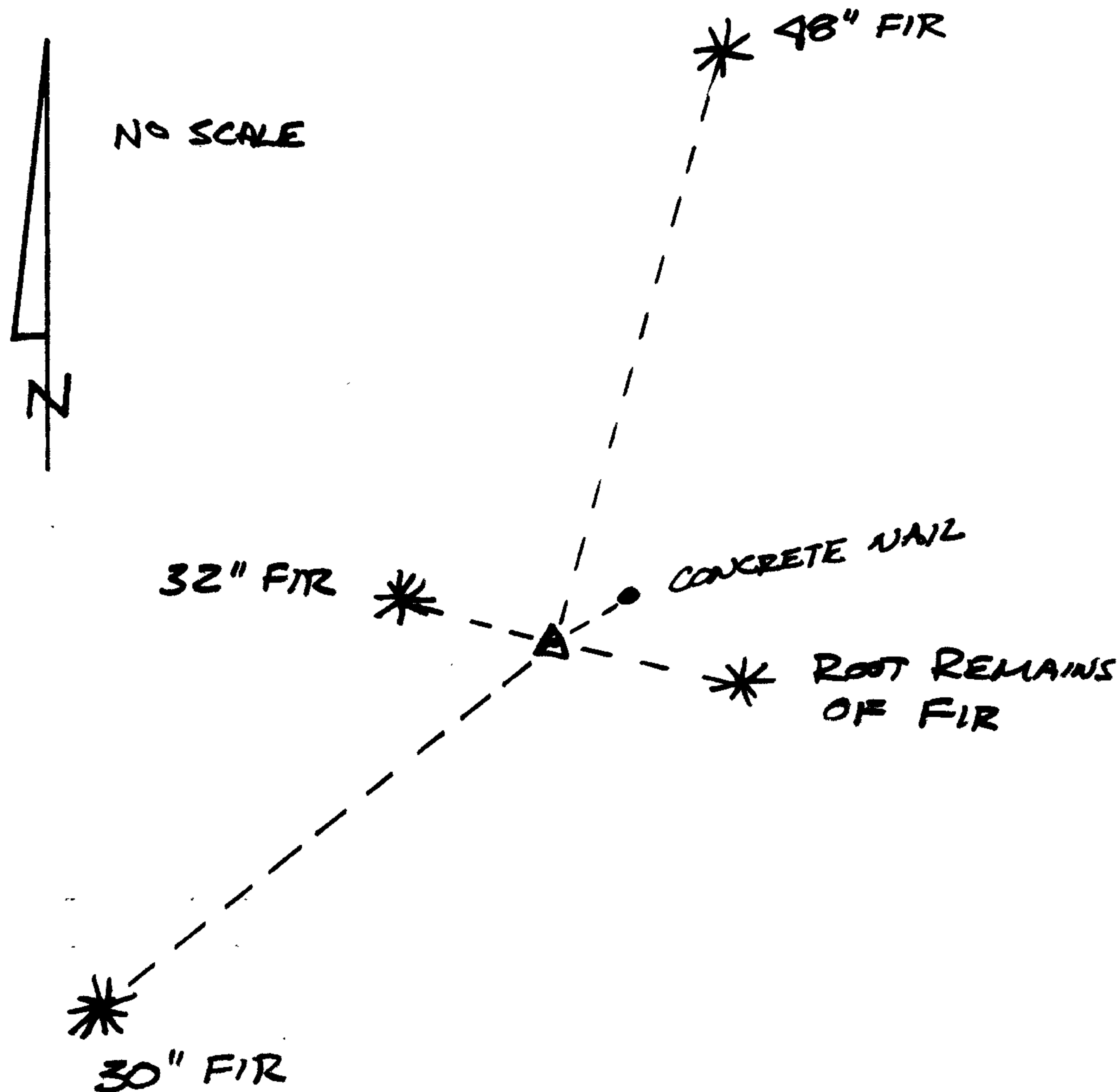

Location & Comments

DCSO BT TAGS ON ALL TREES

Comp. Declin. 19° E  
 Agency DCSO  
 Party Chief GREGORY E. QUIBELL  
 Notekeeper Gregory E. Quibell  
 Witnesses JOHN POWELL

*OK  
JEM*

Surveyor's Seal

REGISTERED  
 PROFESSIONAL  
 LAND SURVEYOR

*Gregory E. Quibell*

OREGON  
 JULY 13, 1979  
 GREGORY E. QUIBELL  
 1834